

*Contact Listing Agents*

**FOR LEASE**



4000-22,000 SF WAREHOUSE SPACE AVAILABLE  
IN PORT KELLS, LANGLEY

**19947 101 AVENUE**

LANGLEY, BC



FOR LEASE 22,000 SF

19947 101 Avenue, Langley, BC

# Leasable Building Area

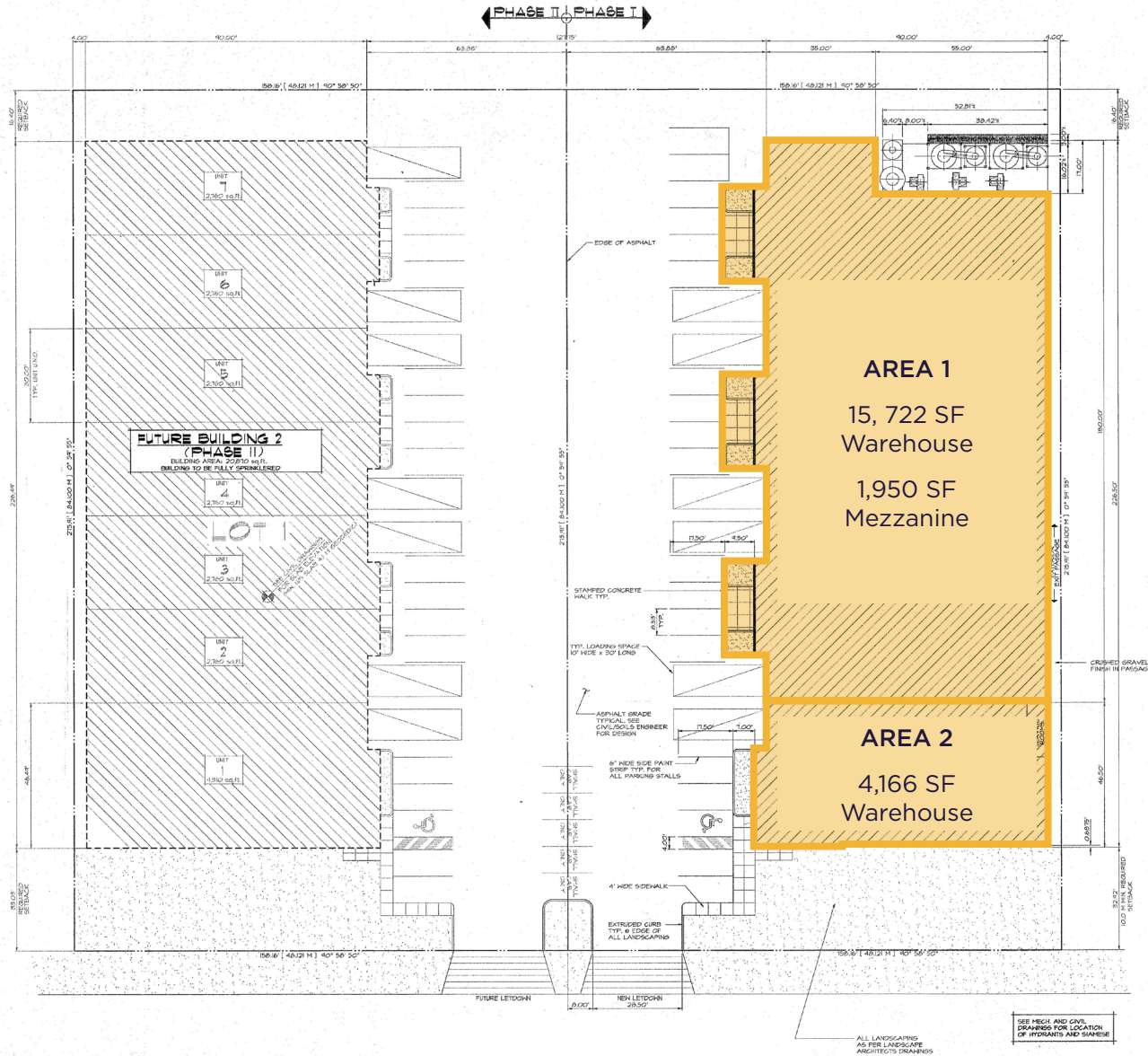

## Location

The subject property is located on 101st Avenue, in the heart of the well established Port Kells industrial area of Langley. The building's construction spares no expense featuring an extra thick concrete slab, heavy power supply, six oversized grade loading doors, paint booths and a piped compressed air system. The concrete mezzanine area features men's and women's change rooms, washrooms, kitchen, lunch room and private offices. Additionally, the property features a large truck court, ample parking space, extensive exterior lighting, and a fenced and gated perimeter.

The subject property is ideally situated in the geographic center of the Lower Mainland, within minutes of the Trans-Canada Highway, Golden Ears Bridge and Port Mann Bridge; providing immediate access to all Lower Mainland submarkets and the Canada/US Border.

A full detailed presentation is available for all features.

Building Area	
Ground Floor Warehouse	19,888 SF
Mezzanine Office	1,950 SF
<b>Total</b>	<b>21,838 SF</b>

The Premises are currently demised into two Bays:

### Area 1

- 15,722 SF of Warehouse space and
- 1,950 SF of mezzanine office, kitchen and washroom warehouse space
- 5 12' x 14' overhead grade loading doors
- Walk-in paint spray booth

### Area 2

- 4,166 SF of Warehouse space with handicap washroom
- 1 12' x 14' overhead grade loading door
- Benchtop spray paint booth

Further Demising options potentially available upon request.

## Property Features

**Legal Description:** Lot 2 District Lot 123 Group 2 New Westminster District Plan LMP12759.

PID: 018-503-110

**Zoning Service:** M-3 (Heavy Industrial) Zoning allowing for a wide variety of manufacturing, and assembly industrial uses. A copy of zoning bylaws is available upon request.

**Features:** Total of Six 12' x 14' Overhead Loading Doors.

- Extensive Electrical Power throughout Warehouse - 600V/600 amps total Building power.
- Fully sprinklered throughout Facility.
- Mezzanine kitchen with Male/Female locker room with shower/washrooms in Area 1 of Warehouse.
- Extensive on-site parking (17 designated stalls).

**Asking Lease Rate:** Contact listing agents

**Operating Costs:** Estimated \$4.91 (2025)

**Availability:** Immediately  
(Depending upon required Tenant Improvements).



FOR LEASE 22,000 SF

19947 101 Avenue, Langley, BC

## Property Photos



FOR LEASE 22,000 SF

19947 101 Avenue, Langley, BC

## Aerial Photos





## FOR MORE INFORMATION, CONTACT

### MAX WILTSHIRE

*Personal Real Estate Corporation*  
*Industrial Sales & Leasing*  
+1 604 690 2658  
max.wiltshire@cushwake.com

### ERIC RICE

*Personal Real Estate Corporation*  
*Industrial Sales & Leasing*  
+1 604 640 5877  
eric.rice@cushwake.com

700 West Georgia Street, Suite 1200  
Toronto Dominion Tower, Pacific Centre  
Vancouver, British Columbia V7Y 1A1  
+1 604 683 3111  
[cushmanwakefield.com](http://cushmanwakefield.com)



©2025 Cushman & Wakefield. All rights reserved. The information contained in this communication is strictly confidential. This information has been obtained from sources believed to be reliable but has not been verified. NO WARRANTY OR REPRESENTATION, EXPRESS OR IMPLIED, IS MADE AS TO THE CONDITION OF THE PROPERTY (OR PROPERTIES) REFERENCED HEREIN OR AS TO THE ACCURACY OR COMPLETENESS OF THE INFORMATION CONTAINED HEREIN, AND SAME IS SUBMITTED SUBJECT TO ERRORS, OMISSIONS, CHANGE OF PRICE, RENTAL OR OTHER CONDITIONS, WITHDRAWAL WITHOUT NOTICE, AND TO ANY SPECIAL LISTING CONDITIONS IMPOSED BY THE PROPERTY OWNER(S). ANY PROJECTIONS, OPINIONS OR ESTIMATES ARE SUBJECT TO UNCERTAINTY AND DO NOT SIGNIFY CURRENT OR FUTURE PROPERTY PERFORMANCE.