

BIOTERRA

For Lease: Suite 250 | 14,403 RSF



Broker Contacts:

Chad Urie
Lic# 01261962
chad.urie@jll.com
858.410.1187

Tony Russell
Lic# 01275372
tony.russell@jll.com
858.410.1213

Tim Olson
Lic# 01364117
tim.olson@jll.com
858.410.1253



LONGFELLOW



JLL

Fitted Lab 250 | 14,403 RSF

43.3% Lab | 56.7% Office

VR Experience

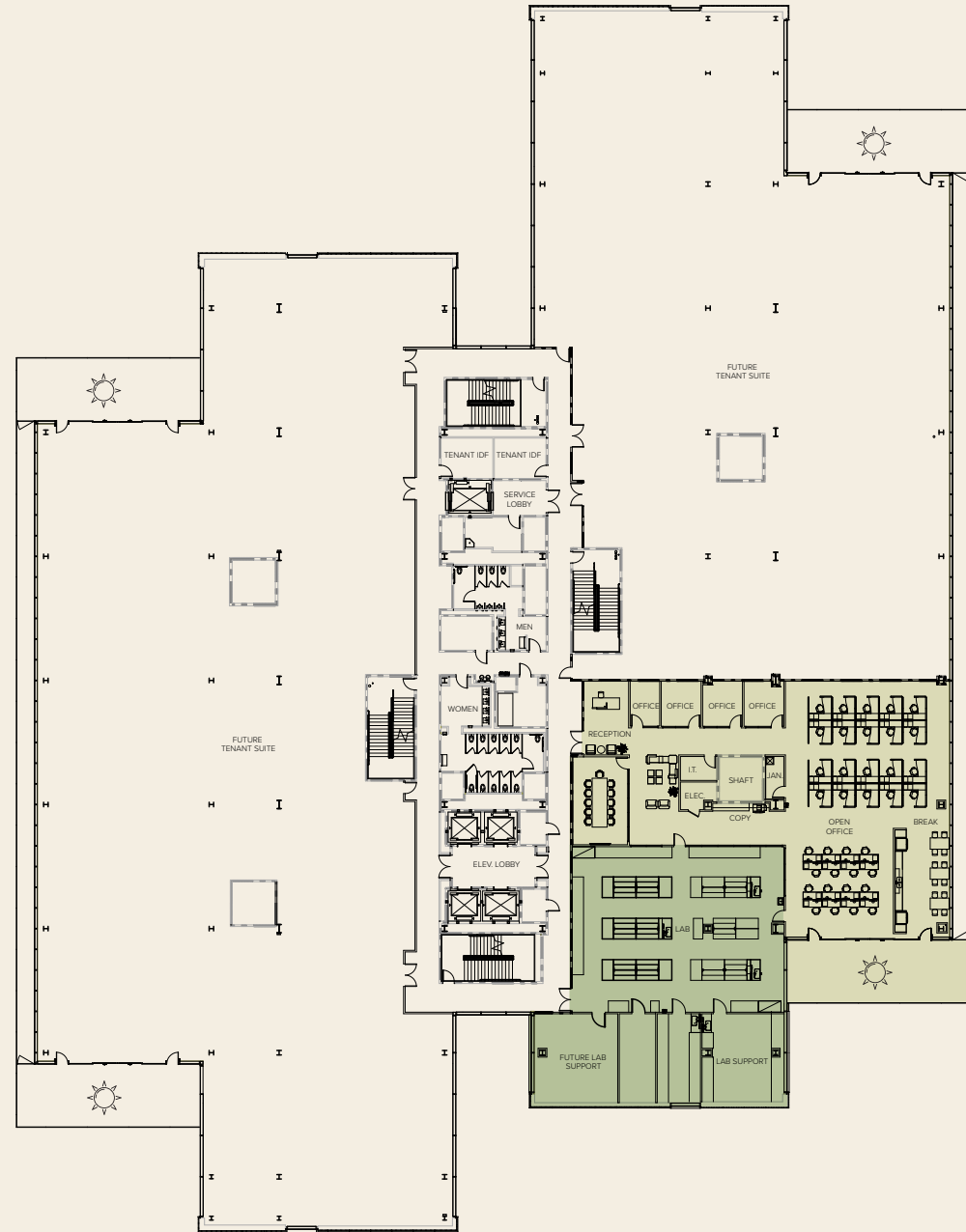

- OFFICE
- LAB



L5 - The Canopy

From routine to retreat...

Take a Visual Tour of
The Canopy



01

Lounge

Collaboration areas, discoverable nooks, a cozy library with a secret door to a nostalgic rec room. Counter F&B service with bespoke culinary experiences and happy-hours curated exclusively for tenants.



02

Terrace

Hospitality inspired indoor/outdoor bar with coastal views, serene nooks surrounded by abundant landscaping, outdoor meeting pod.



03

Fitness + Wellbeing

State-of-the-art fitness equipment, indoor/outdoor workout areas, cold plunges + saunas, spa-style locker rooms.



04

Seminar Space

Reservable conference/training room hosts up to 165 guests, 70 seated with desks. Breakout area with self serve bar for catering, indoor/outdoor prefunction seating and areas for networking.



05

Private Meeting Rooms

Two in-person meeting spaces. The larger room seats 14 people for comfortable roundtables. The smaller room is an inviting space that encourages creativity for a group of 8.

