



Large Industrial Space Available For Lease

6365 Netherhart Road, Units 1-10
Mississauga, ON



Get more information

Ryan G. Cunningham

Sales Representative, Principal

+1 905 283 2384

ryan.cunningham@avisonyoung.com

Mike Tatarsky

Sales Representative, Principal

+1 905 283 2377

micheal.tatarsky@avisonyoung.com



Platinum member

E. & O.E.

For Lease

6365 Netherhart Rd. #1-10
Mississauga, ON

Floor Plan

47,315± sf

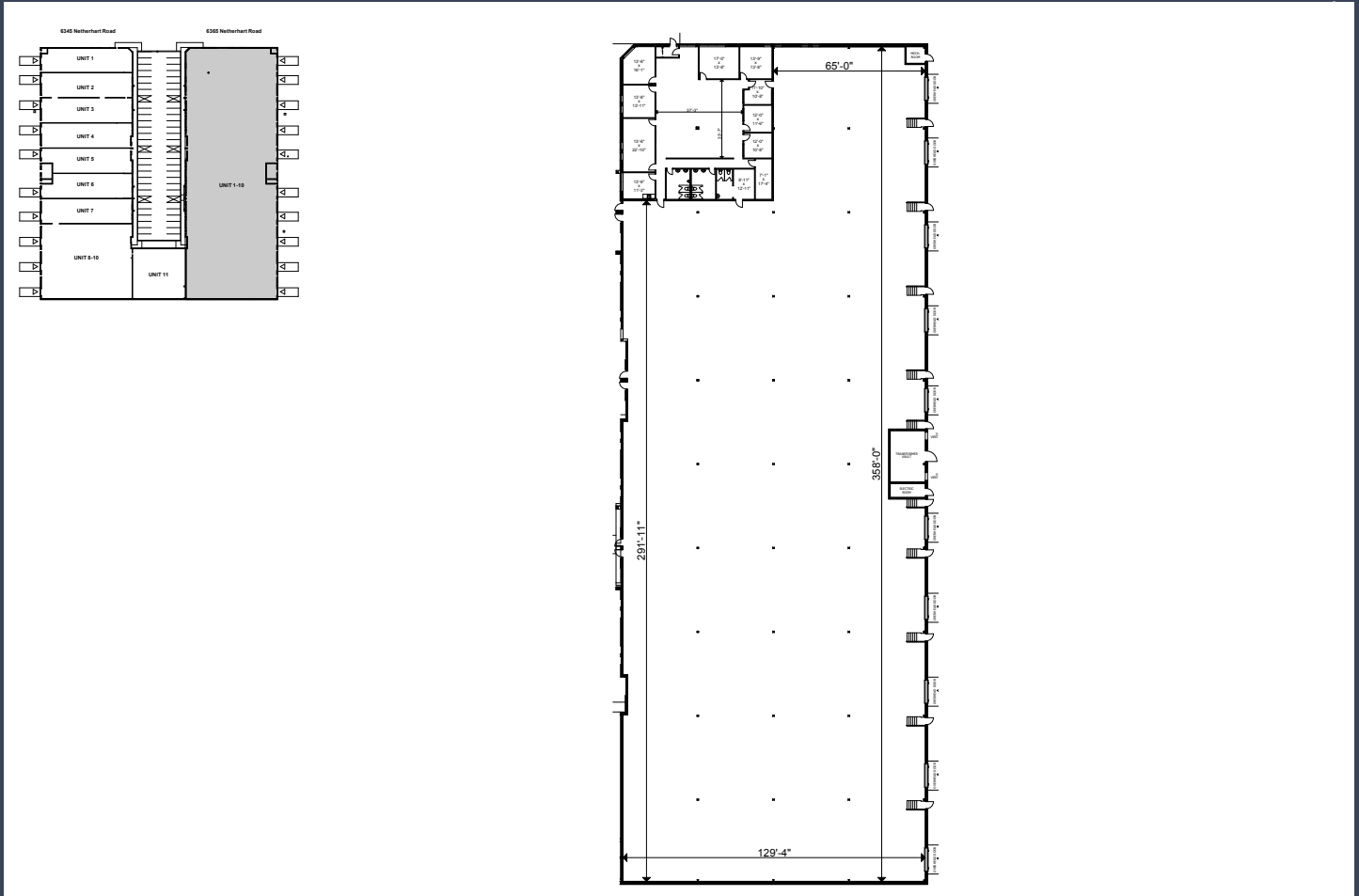

The purpose of this plan is to identify the approximate outline of the Premises.
All information, dimensions, sizes and areas are approximate only and are to be verified on site.
Errors and Omissions Excepted (E. & O.E.)

Property Summary

Available Area
47,315± sf

Shipping
7 TL | 1 DI

Availability
June 1, 2025

Clear Height
18 feet

Office Area
4,400± sf

Property Highlights



Professionally owned and managed



Accessible for 53' Trailers



Minutes to 400 series Highways
Around the corner from Pearson
International Airport.

6365

NETHERHART ROAD
MISSISSAUGA, ON



Toronto Pearson
International Airport

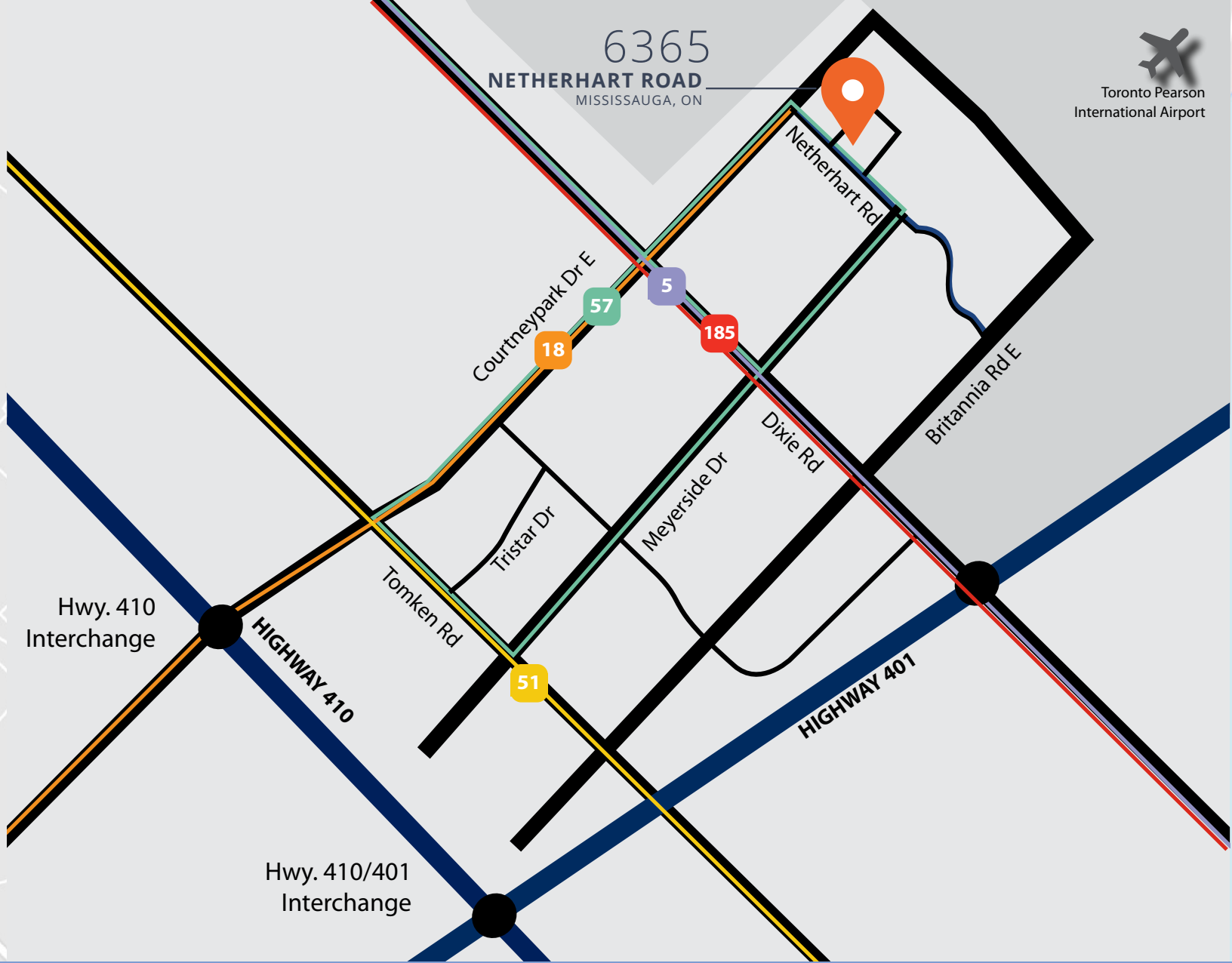

GREAT ACCESSIBILITY

CONVENIENT TRAVEL TIMES

DISTANCES FROM 6365 NETHERHART ROAD

2

minutes
1.0 km to
Pearson
International
Airport

8

minutes
3.9 km to
Highways 401,
403 & 410

10

minutes
8.5 km to
Highway
427

21

minutes
17.0 km to
Queen Elizabeth
Way

30

minutes
29.6 km to
Downtown
Toronto

**Transit Route
Legend**

BRAMPTON



MISSISSAUGA



E. & O.E.



For Lease

6365 Netherhart Rd. #1-10
Mississauga, ON

Get more information

Ryan G. Cunningham

Sales Representative, Principal

+1 905 283 2384

ryan.cunningham@avisonyoung.com

Mike Tatarsky

Sales Representative, Principal

+1 905 283 2377

micheal.tatarsky@avisonyoung.com

Avison Young Commercial Real Estate Services, LP, Brokerage

77 City Centre Drive, Suite 301, Mississauga, Ontario L5B 1M5

Office 905 712 2100 Fax 905 712 2937 avisonyoung.ca

© 2024. Avison Young Commercial Real Estate Services, LP, Brokerage. Information contained herein was obtained from sources deemed reliable and, while thought to be correct, have not been verified. Avison Young does not guarantee the accuracy or completeness of the information presented, nor assumes any responsibility or liability for any errors or omissions therein.

© Mapbox, © OpenStreetMap

E. & O.E.

**AVISON
YOUNG**

**CANADA BEST
MANAGED
COMPANIES**

Platinum member