

CUPERTINO CIVIC PARK

20370, 20380 & 20410
TOWN CENTER LANE

±743 SF TO ±1,460 SF
AVAILABLE FOR LEASE

NEWMARK

JOHN MCKENNA

650.688.8548

john.mckenna@nrmk.com

CA RE License #01276576

SKYLAR SMITH

949.637.2857

skylar.smith@nrmk.com

CA RE Lic #02196285

20370
20380
20410
TOWN CENTER LANE



- » Two-Story Professional Office Buildings
- » Excellent Central Cupertino Location
- » Easy Access to Highways 280 and 85
- » Covered and Surface Parking
- » Common Conference Room
- » Walking Distance to Restaurants (Chipotle, SpiceKlub, Bitter + Sweet, Kee Wah Bakery), Hotels (Juniper), and Financial Services (Wells Fargo & Chase Bank)
- » Adjacent to Cupertino Civic Center (City Hall, Community Hall, Library with Coffee Society)
- » Local Ownership & Management

CUPERTINO
CIVIC PARK

FIRST FLOOR

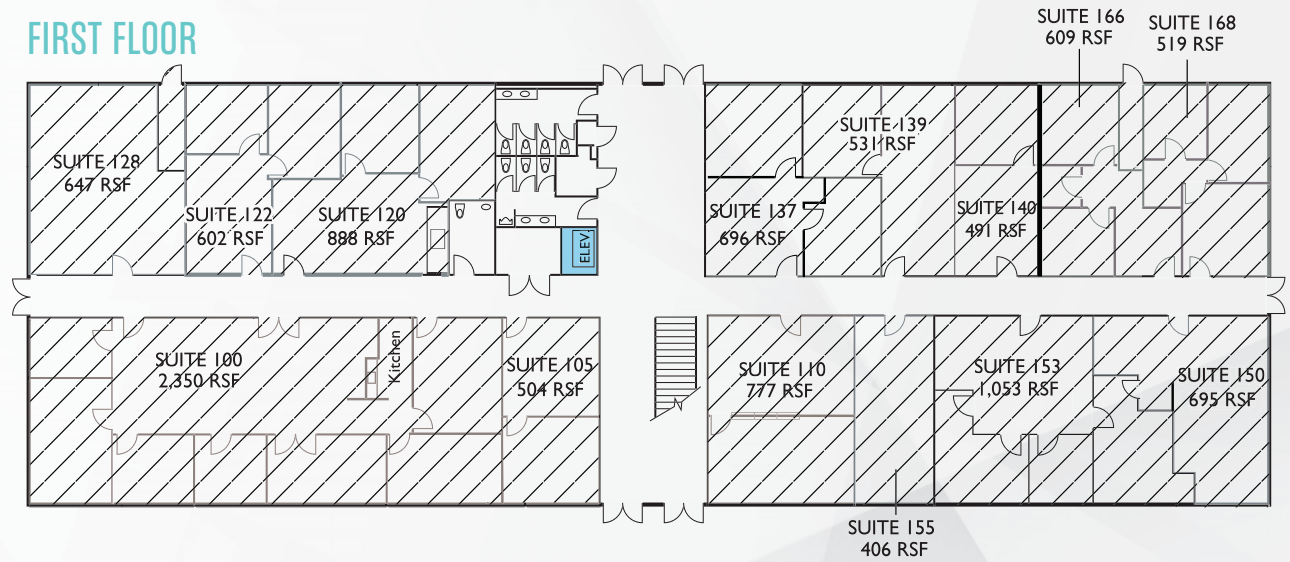

SECOND FLOOR

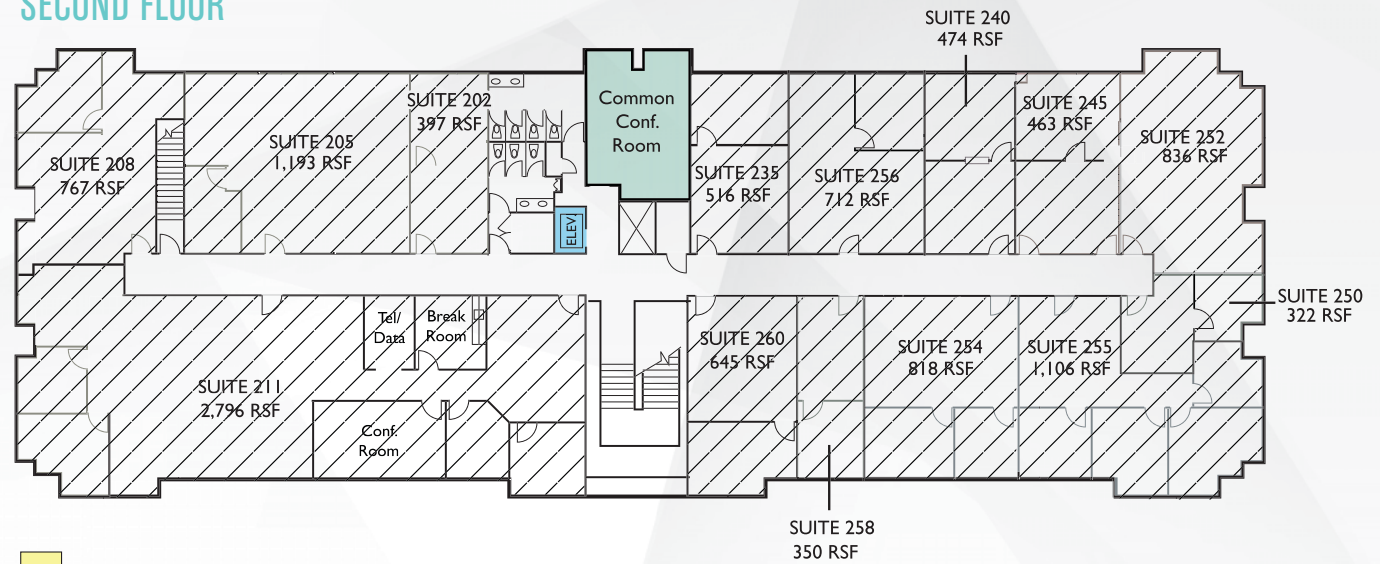

- AVAILABLE
- LEASED

FIRST FLOOR

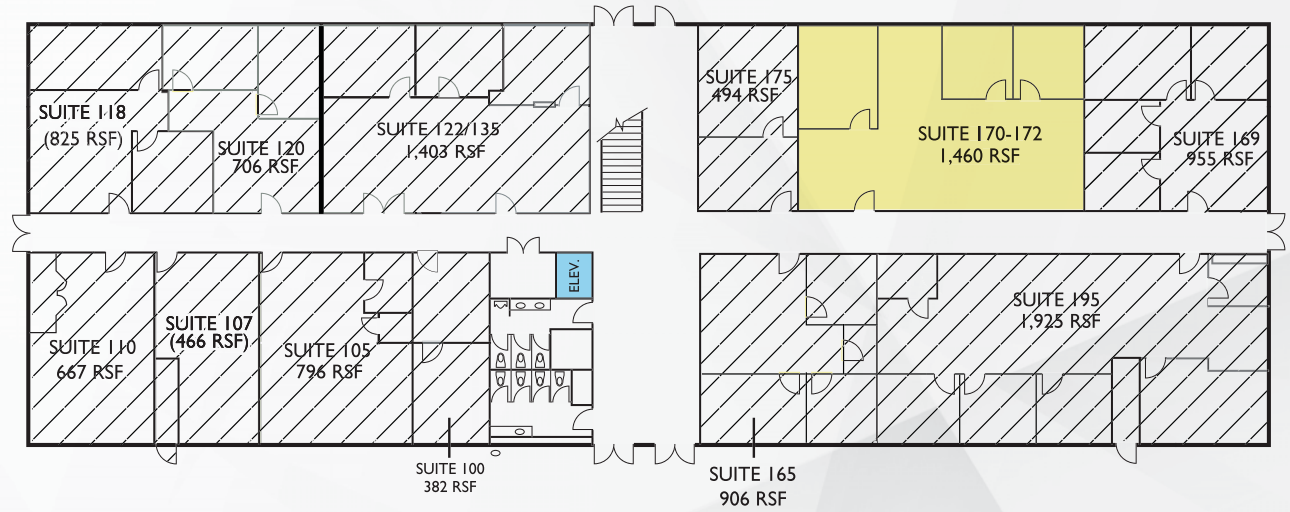

SECOND FLOOR

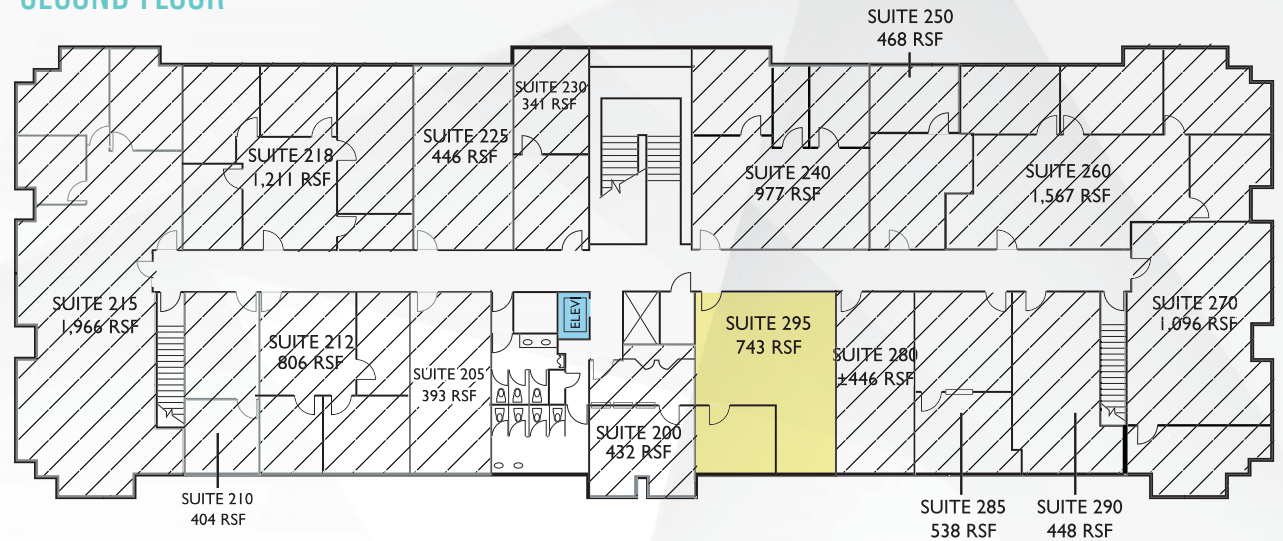

- AVAILABLE
- LEASED

FIRST FLOOR

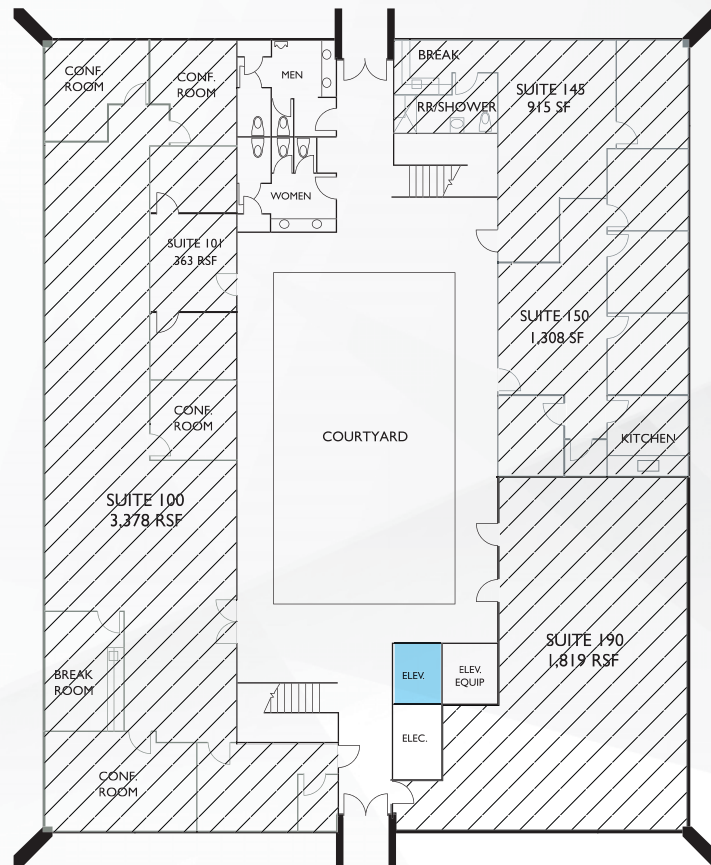

SECOND FLOOR

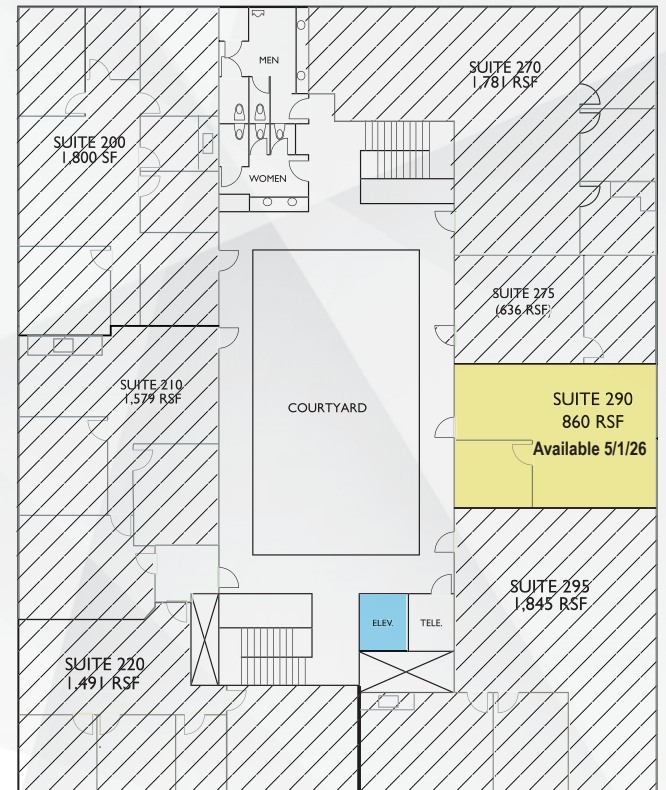

-  AVAILABLE
-  LEASED

CUPERTINO CIVIC PARK

20370, 20380 & 20410
TOWN CENTER LANE

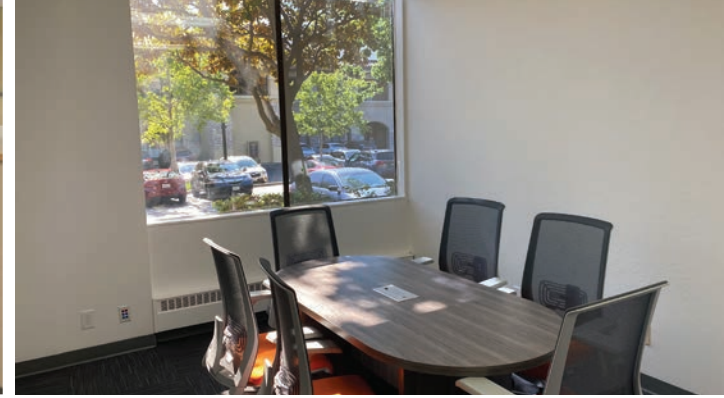

CUPERTINO CIVIC PARK

20370, 20380 & 20410 TOWN CENTER LANE

JOHN MCKENNA
650.688.8548
john.mckenna@nmrk.com
CA RE License #01276576

SKYLAR SMITH
949.637.2857
skylar.smith@nmrk.com
CA RE Lic #02196285

The distributor of this communication is performing acts for which a real estate license is required. The information contained herein has been obtained from sources deemed reliable but has not been verified and no guarantee, warranty or representation, either express or implied, is made with respect to such information. Terms of sale or lease and availability are subject to change or withdrawal without notice. MP-514.03/26

