

# Hardaway Associates Architects

47 River Street, Suite 200  
Wellesley Massachusetts  
02481

781-235-5339  
FAX 781-235-5329

**DRAWING LEGEND:**

- INTERIOR ELEVATIONS (SEE SHEET A5 & A-6)
- SECTION DETAIL (DETAIL NUMBER SHEET NUMBER)
- PARTITION TYPE (SEE SHEET A8)
- DOOR NUMBER (SEE SHEET A-8 DOOR SCHEDULE)
- FLOOR DRAIN
- ROOF DRAIN
- FIRE EXTINGUISHER & RECESSED CABINET
- MEDICAL GAS ZONE VALVE BOX
- INSTALL. DOOR FRAME TIGHT TO PERPENDICULAR WALL
- CORNER GUARD
- 3/4" UNDERCUT
- SYSTEM 1 STERILIZER
- CENTURY STERILIZER
- 1 HR./SMOKE PARTITION
- 2 HR. PARTITION

**STORAGE**

- 111 ROOM NAME
- 112 ROOM NUMBER
- VC | P | A2 FLR./WALL/CLG. FINISH
- 9'-0" CEILING HEIGHT

**ROOM FINISH LEGEND:**

SYMBOL	MATERIALS
<b>FLOOR AND BASE</b>	
C	CARPET/RUBBER BASE
M	SHEET VINYL / RUBBER BASE
MV	MEDICAL VINYL / RUBBER BASE
MT	WALK-OFF MAT
VC	VINYL COMPOSITION TILE / RUBBER BASE
<b>WALLS</b>	
P	PART ON GWB
V	VINYL WALL COVERING ON GWB
W	FRP 4'-0" WAINSCOT, PAINT ABOVE
EP	EPOXY PAINT
<b>CEILING</b>	
A1	ACOUSTIC TILE TYPE 1
A2	ACOUSTIC TILE TYPE 2
A3	GWB PANELS, AC TILE TYPE 3
P	PART ON GWB

**Project Name:**  
SURGERY CENTER  
of Springfield

SPRINGFIELD, MA

No.	Date	Description

**Project No.:** 02.19  
**Date:** 12/6/2002  
**Scale:** 3/16"=1'-0"  
**Drawn by:** DS  
**Checked by:** RTH

**Drawing Title:**  
FLOOR PLAN A

**Drawing No.:** A1

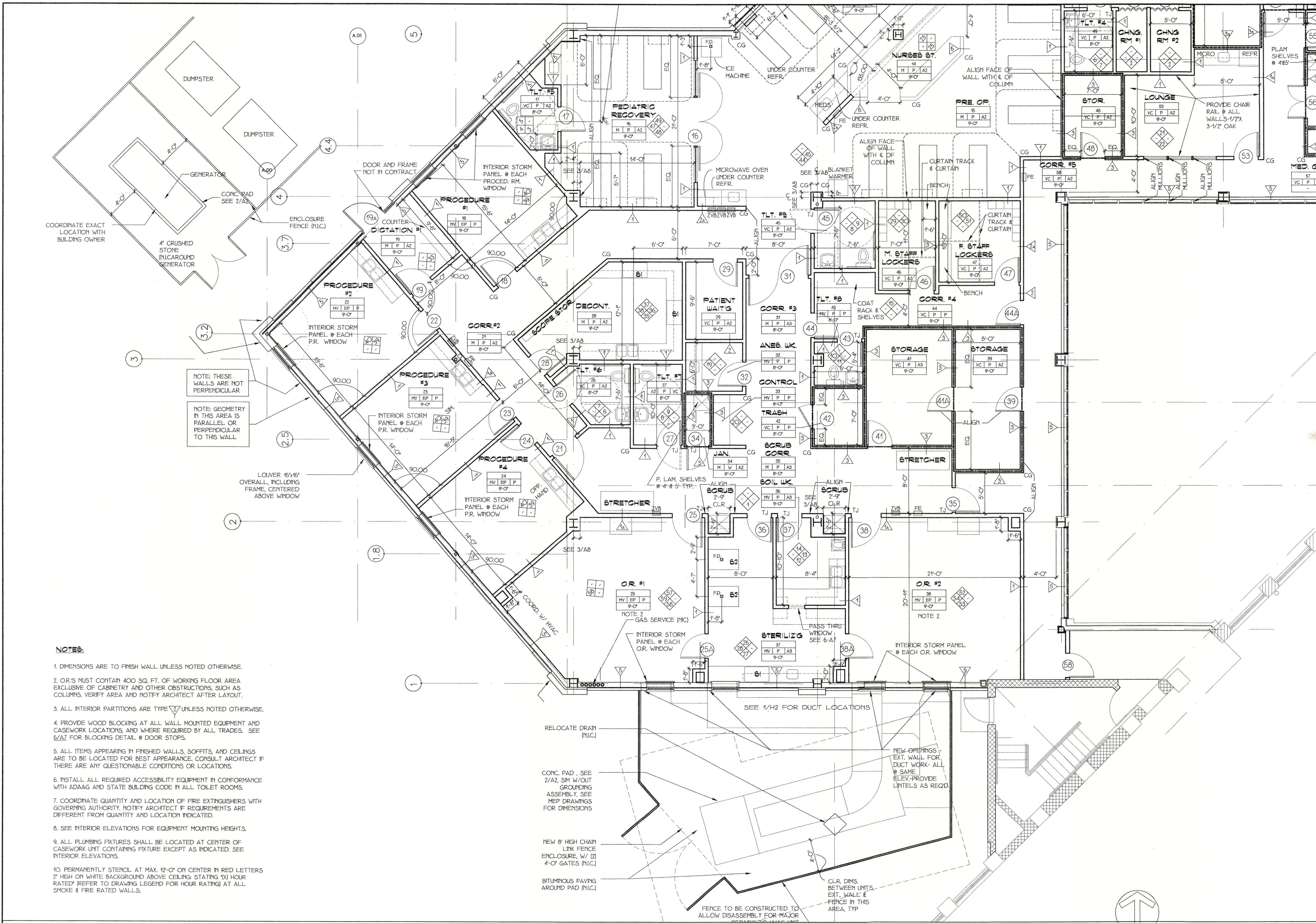

- NOTES:**
- DIMENSIONS ARE TO FINISH WALL UNLESS NOTED OTHERWISE.
  - OR.'S MUST CONTAIN 400 SQ. FT. OF WORKING FLOOR AREA EXCLUSIVE OF CABINETS AND OTHER OBSTRUCTIONS, SUCH AS COLUMNS. VERIFY AREA AND NOTIFY ARCHITECT AFTER LAYOUT.
  - ALL INTERIOR PARTITIONS ARE TYPE 1 UNLESS NOTED OTHERWISE.
  - PROVIDE WOOD BLOCKING AT ALL WALL MOUNTED EQUIPMENT AND CASEWORK LOCATIONS, AND WHERE REQUIRED BY ALL TRADES. SEE 6/AZ FOR BLOCKING DETAIL @ DOOR STOPS.
  - ALL ITEMS APPEARING IN FINISHED WALLS, SOFFITS, AND CEILINGS ARE TO BE LOCATED FOR BEST APPEARANCE. CONSULT ARCHITECT IF THERE ARE ANY QUESTIONABLE CONDITIONS OR LOCATIONS.
  - INSTALL ALL REQUIRED ACCESSIBILITY EQUIPMENT IN CONFORMANCE WITH ADAAG AND STATE BUILDING CODE IN ALL TOILET ROOMS.
  - COORDINATE QUANTITY AND LOCATION OF FIRE EXTINGUISHERS WITH GOVERNING AUTHORITY. NOTIFY ARCHITECT IF REQUIREMENTS ARE DIFFERENT FROM QUANTITY AND LOCATION INDICATED.
  - SEE INTERIOR ELEVATIONS FOR EQUIPMENT MOUNTING HEIGHTS.
  - ALL PLUMBING FIXTURES SHALL BE LOCATED AT CENTER OF CASEWORK UNIT CONTAINING FIXTURE EXCEPT AS INDICATED. SEE INTERIOR ELEVATIONS.
  - PERMANENTLY STENCIL AT MAX. 12'-0" ON CENTER IN RED LETTERS 2" HIGH ON WHITE BACKGROUND ABOVE CEILING. STATING "1" HOUR RATED" (REFER TO DRAWING LEGEND FOR HOUR RATING) AT ALL SMOKE & FIRE RATED WALLS.

**PARTIAL FLOOR PLAN A**  
3/16"=1'-0"

