

The Shoppes at Renaissance Square

Evesham (Marlton), New Jersey 08053

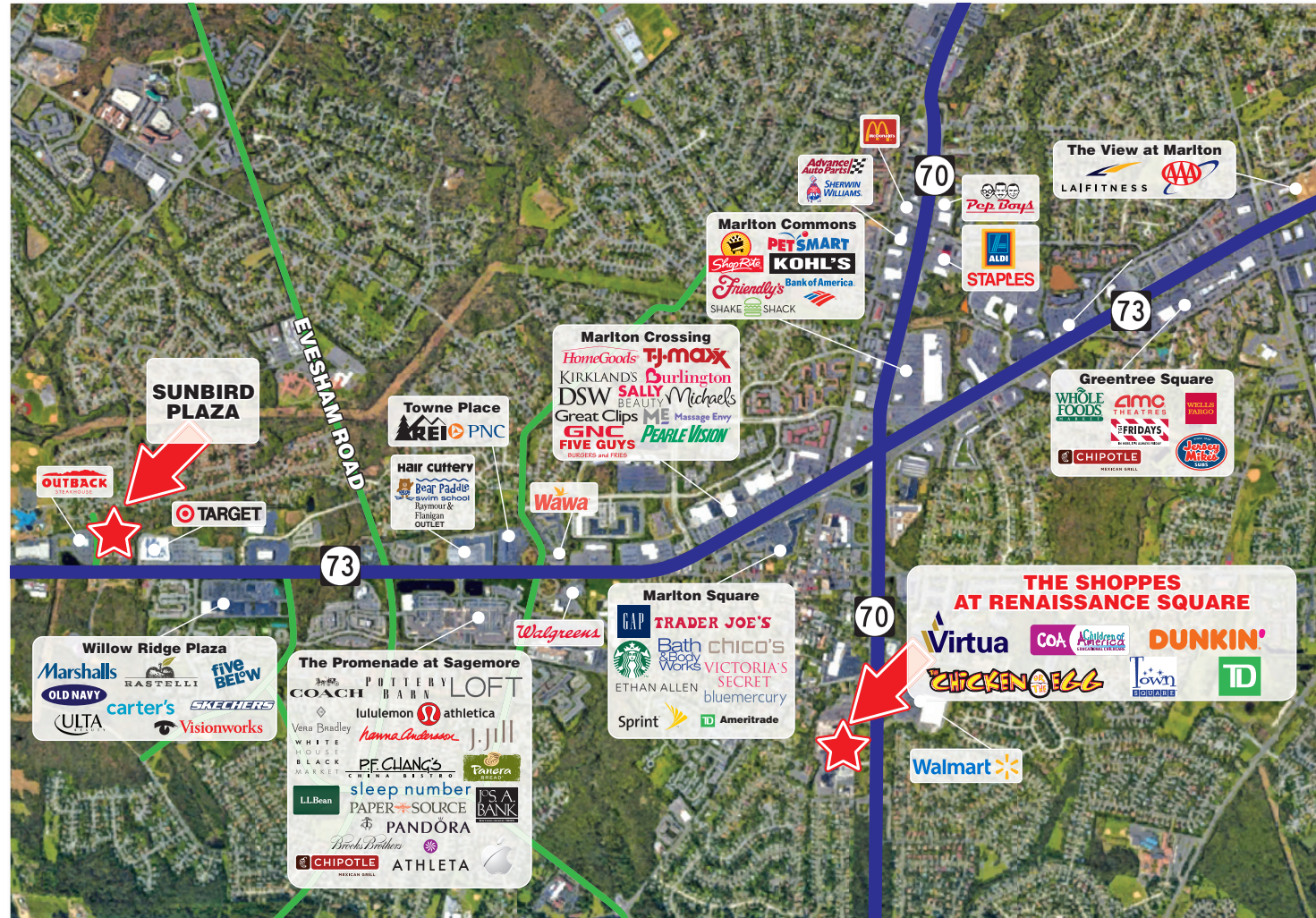

RD

MANAGEMENT LLC

Evesham (Marlton), NJ

The Shoppes at Renaissance Square

The Chicken or the Egg Now Open!



Location:

The Shoppes at Renaissance Square is located in Burlington County on State Highway 70 at the intersection of N. Locust Avenue in Evesham (Marlton), New Jersey 08053.

Type:

Community Strip Shopping Center and Luxury Rental Apartments

GLA:

127,631 sf

Traffic:

Two way average daily traffic on State Highway 70: 32,867 VPD

Vital Statistics:

Major Renovation Completed

- New Pylon/Monument Signs allow for multiple tenant sign panels
- Inwood at Renaissance Square, 338 luxury residential component, is now open
- The existing NJ State Right-of-Way has been transformed into an open space park complete with new jogging paths, walkways, bbq picnic section, children's play area, dog park and ponds

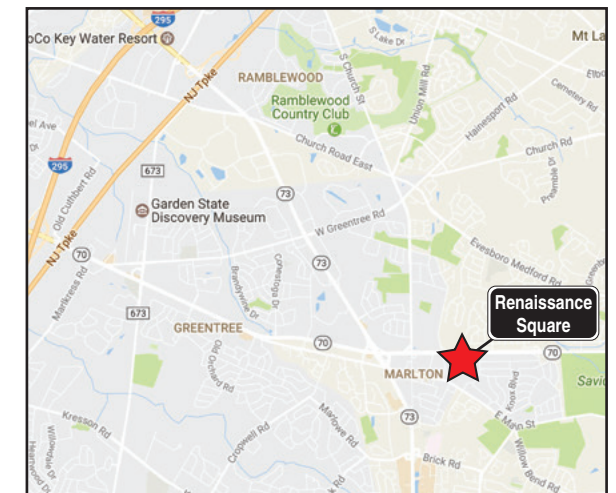

Demographics	1 mile	3 mile	5 mile	7 mile
Population				
2022 (estimate)	11,184	70,591	152,704	311,134
2027 (projection)	11,136	70,457	152,561	310,637
2020 (census)	10,818	69,825	152,260	310,310
Number of HH				
2022 (estimate)	4,432	27,836	59,825	123,142
2027 (projection)	4,482	28,119	60,288	123,741
2020 (census)	4,328	27,422	59,256	122,009
Average HH Income				
2022 (estimate)	\$125,266	\$133,435	\$145,148	\$132,604
2027 (projection)	\$159,486	\$162,909	\$180,261	\$164,894
Median Age				
2022 (estimate)	42.7	43.2	43.5	42.1
Daytime Population				
2022 (estimate)	6,781	37,259	109,036	194,368

RD Management LLC
Jordan Goldblum
 212-265-6600 x390
jgoldblum@rdmanagement.com
 810 Seventh Avenue, 10th floor
 New York, NY 10019

Information furnished is from sources deemed reliable, but is not guaranteed by RD Management and is subject to change in price, corrections, errors and omissions, prior sales or withdrawal without notice.

The Shoppes at Renaissance Square

State Highway 70 and N. Locust Avenue
Evesham (Marlton), New Jersey 08053



Jordan Goldblum
212-265-6600 x390
jgoldblum@rdmanagement.com
810 Seventh Avenue, 10th floor
New York, NY 10019

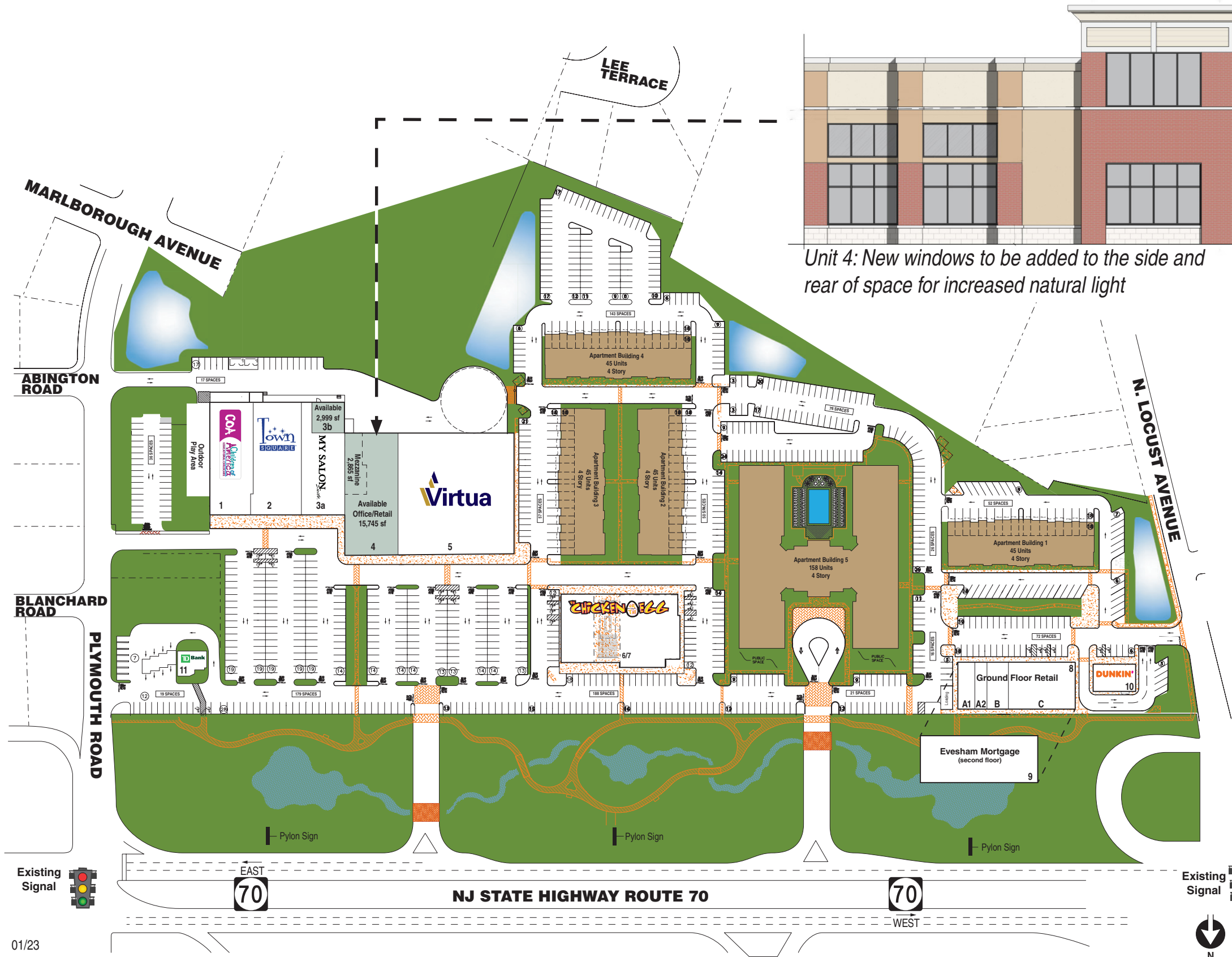

Unit 4: New windows to be added to the side and rear of space for increased natural light

Tenant Key

1. Children of America		10,000 sf
2. Senior Helpers Town Square		13,189 sf
3a. My Salon Suite		7,307 sf
3b. Available	(58.22' x 51.51')	2,999 sf
4. Available Office/Retail Mezzanine	(83.8' x 185' irr.)	15,745 sf
5. Virtua Medical Group		32,568 sf
6/7. The Chicken Or The Egg Restaurant & Beer Garden		
Main Building		9,449 sf
Partially Enclosed Terrace		3,014 sf
Uncovered Garden area		5,058 sf
8. Ground Floor Strip		
A1. Gaetano's Cheese Steak and Pizza		2,070 sf
A2. Canvas Salon		1,050 sf
B. Pink Petal Mani		1,984 sf
C. Keller Williams Real Estate		6,387 sf
9. Evesham Mortgage		12,753 sf
10. Dunkin Donuts		2,600 sf

RESIDENTIAL KEY

Apartment Building 1	45 Units
Apartment Building 2	45 Units
Apartment Building 3	45 Units
Apartment Building 4	45 Units
Apartment Building 5	158 Units
Total Apartments	338 Units

