

# INDUSTRIAL/WAREHOUSE SPACE FOR LEASE



47 ANTARES DRIVE



**JENNINGS**  
**REAL ESTATE**  
BROKERAGE INC.

# OFFERING SUMMARY

AVAILABILITY	SPACE USE	SIZE	NET RENT	ADDIT. RENT
30-Day Notice	Industrial/Warehouse	Up To 53,410 SF	\$13.50 PSF	\$8.06 PSF + utilities (2025 Est.)

## PROPERTY HIGHLIGHTS

- The demising options are as follows: **8,000 SF**, **21,400 SF** and **24,000 SF**
- Building is serviced by 1000kVA pad mount transformer with a main breaker rated at 1200amps 347/600v
- Completely temperature-controlled warehouse space
- Conveniently located along Hunt Club Road, just minutes from the Ottawa International Airport
- Two 12' x 12' oversized grade level loading doors, with interior dock levelers
- Two regular 8' x 8' grade-level doors
- Approximately 15% finished office, with 85% warehouse
- 16' clear height in the warehouse
- Fully sprinklered building

47 ANTARES DRIVE





# ENTIRE BUILDING FLOOR PLAN

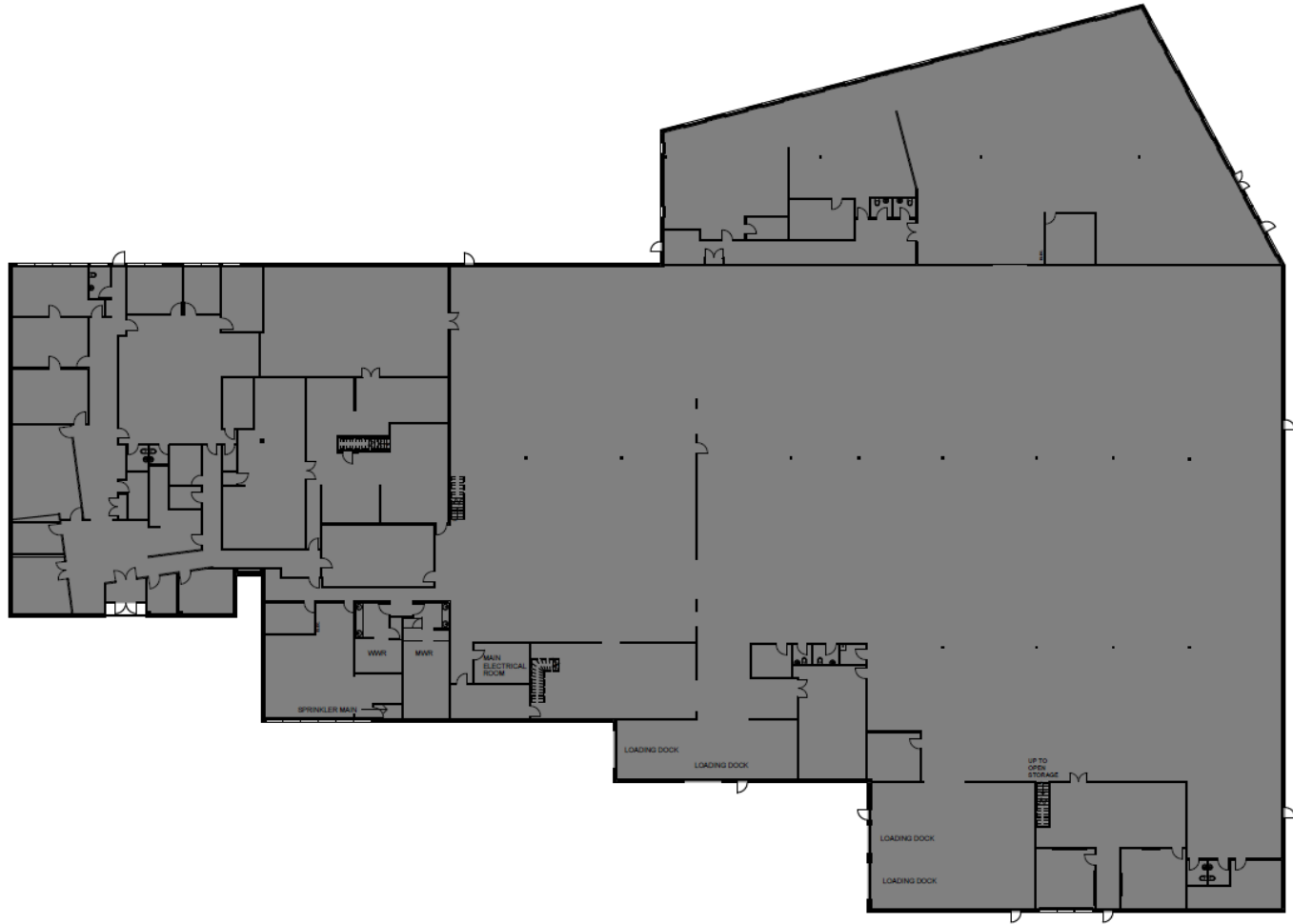

47 ANTARES DRIVE

# DEMISED FLOOR PLAN

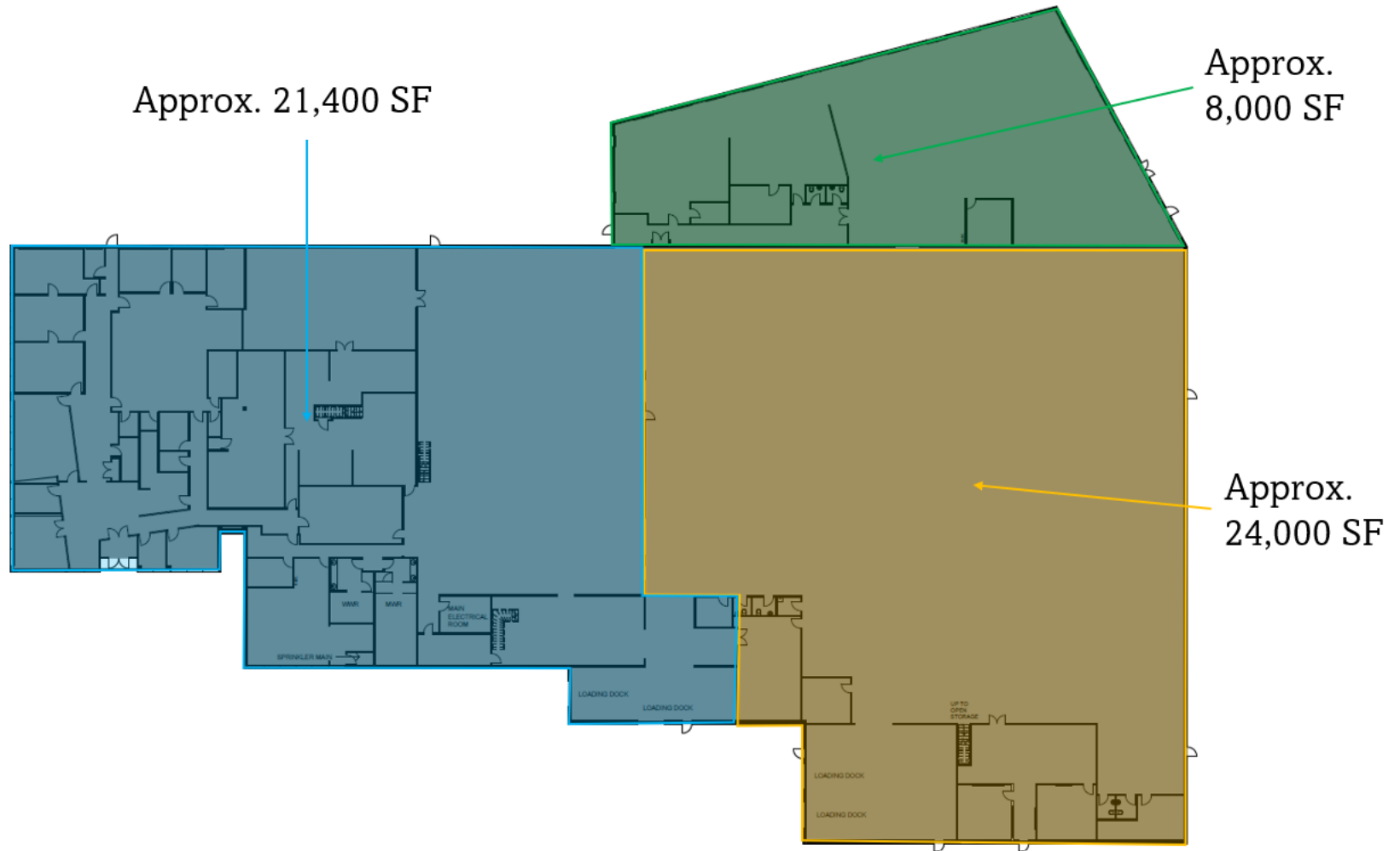

## 47 ANTARES DRIVE

# MAP



47 ANTARES DRIVE



Contact: Jennings Real Estate Brokerage Inc.

Andrew Eberhard | Broker of Record  
613-709-0263 | aeberhard@jre.ca

Iryna Loshkarova | Sales Representative  
613-413-1361 | iloshkarova@jre.ca



**JENNINGS**  
**REAL ESTATE**  
BROKERAGE INC.