



FOR SUBLEASE

INDUSTRIAL PROPERTY | ±4,059 SF

9254 1/2 HALL RD | DOWNEY | CA

PROPERTY HIGHLIGHTS:

- ±4,059 SF Available
- ±560 SF Office
- Multi-Tenant Gated Park
- M2 Zoning
- Light Manufacturing Uses Allowed
- Sprinklered
- Professional Business Environment
- Built in 2008
- 18' Clear Height
- Access to 5/150/605 Fwy

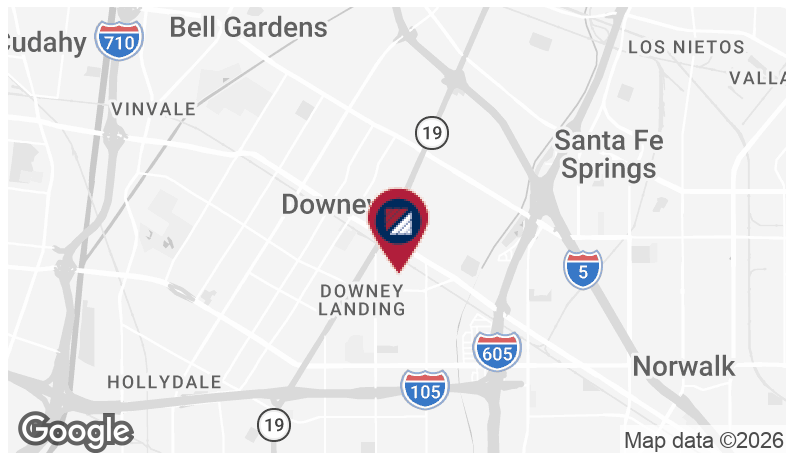

FOR MORE INFORMATION, PLEASE CONTACT:

CARLOS CASTILLO

Associate Vice President
P: 213.270.2263 | M: 213.842.5877
carlos.castillo@daumcommercial.com
CalDRE #01451618



www.daumcommercial.com

D/AQ Corp. #01129558. Maps Courtesy ©Google & ©Microsoft. Although all information is furnished regarding for sale, rental or financing from sources deemed reliable, such information has not been verified and no express representation is made nor is any to be implied as to the accuracy thereof, and it is submitted subject to errors, omissions, changes of price, rental or other conditions, prior sale, lease or financing, or withdrawal without notice.

FLOOR PLAN

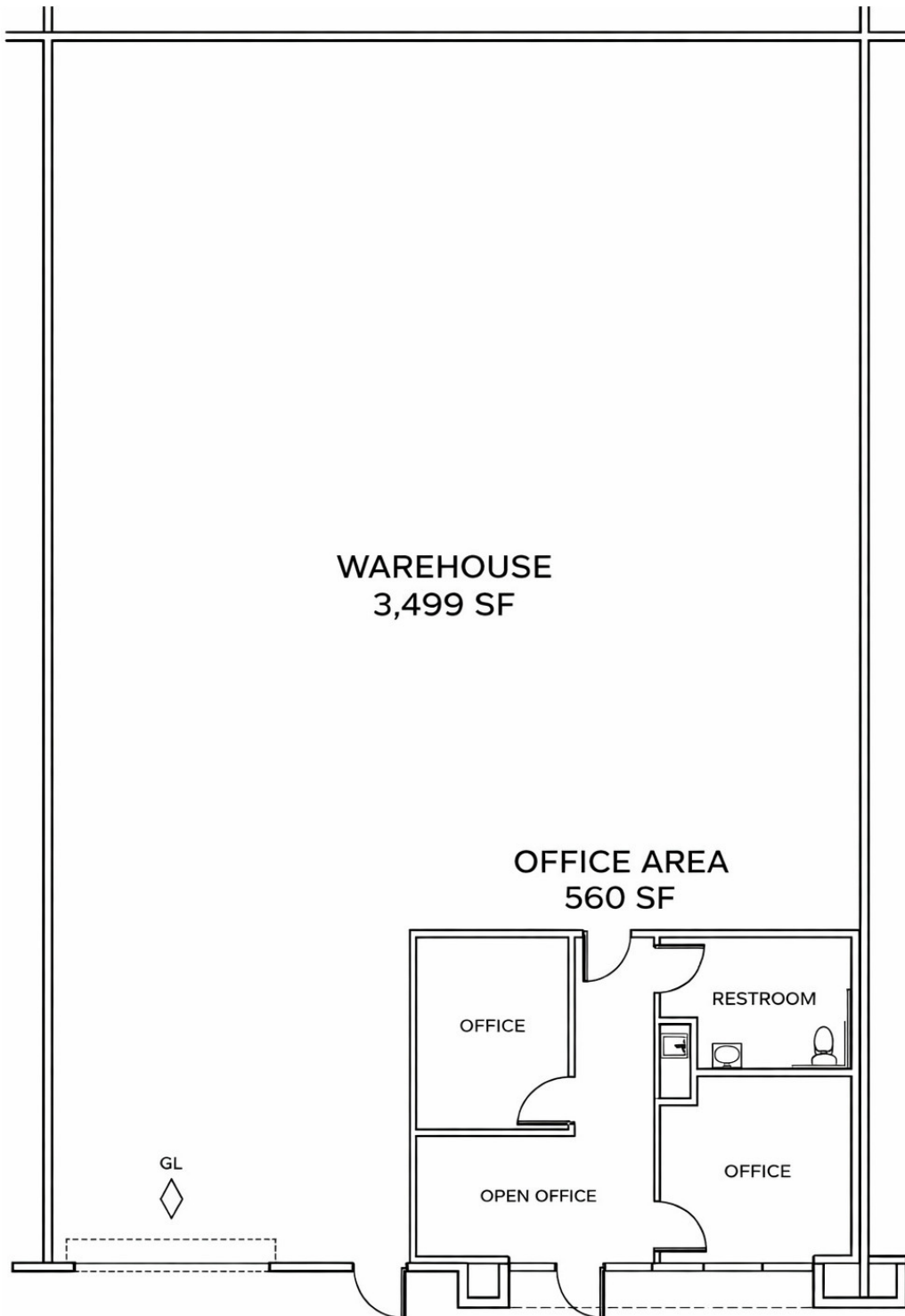

*Not to Scale

FOR MORE INFORMATION, PLEASE CONTACT:

CARLOS CASTILLO

Associate Vice President

P: 213.270.2263 | M: 213.842.5877

carlos.castillo@daumcommercial.com

CalDRE #01451618



www.daumcommercial.com

D/AQ Corp. #01129558. Maps Courtesy ©Google & ©Microsoft. Although all information is furnished regarding for sale, rental or financing from sources deemed reliable, such information has not been verified and no express representation is made nor is any to be implied as to the accuracy thereof, and it is submitted subject to errors, omissions, changes of price, rental or other conditions, prior sale, lease or financing, or withdrawal without notice.

AMENITY MAP



FOR MORE INFORMATION, PLEASE CONTACT:

CARLOS CASTILLO

Associate Vice President
P: 213.270.2263 | M: 213.842.5877
carlos.castillo@daumcommercial.com
CalDRE #01451618



www.daumcommercial.com

D/AQ Corp. #01129558. Maps Courtesy ©Google & ©Microsoft. Although all information is furnished regarding for sale, rental or financing from sources deemed reliable, such information has not been verified and no express representation is made nor is any to be implied as to the accuracy thereof, and it is submitted subject to errors, omissions, changes of price, rental or other conditions, prior sale, lease or financing, or withdrawal without notice.