



RENT
From £695
(per workstation per month)



35-41 Folgate Street, Spitalfields
London E1 6BX

Serviced Offices | From 200 Sq Ft



TO LET



Location

Adjacent to Spitalfields market, the building features Fora's exceptional design and attention to detail, boasting flexible office space alongside an impressive atrium style events area, wellness studio, Residents' garden, and roof terrace.



Description

Spitalfields workspace enjoys the ultimate location at the intersection of the City and Shoreditch, walking distance from the unbeatable amenities of both. Just a 4 minute walk from Shoreditch High Street station, and an 8 minute walk from Liverpool Street Station, Folgate Street is superbly connected for travel across London and beyond.



Further information

New licences are available for a term by arrangement.



Amenities



Bike Parking



Coffee Bar



Meeting Rooms



Shower



Gym



High Speed Internet



Fitted Offices



24/7 Access



Plug & Play

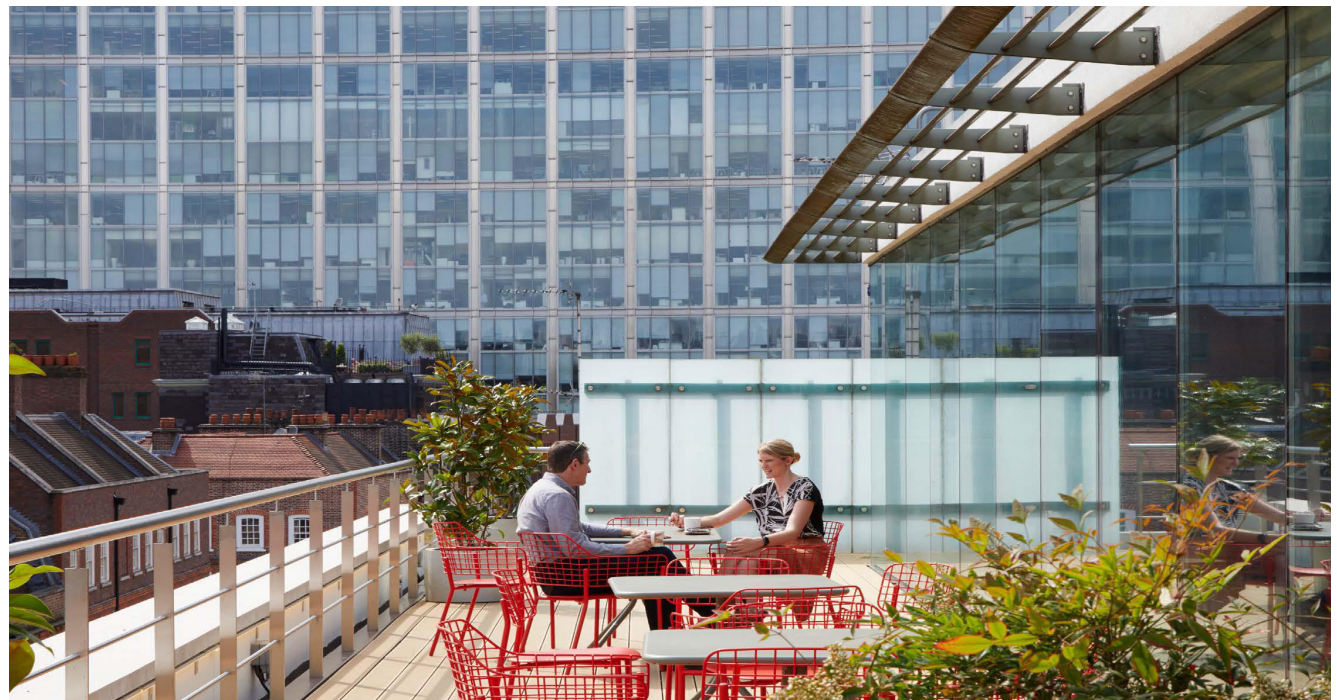

35-41 Folgate Street, Spitalfields, London E1 6BX

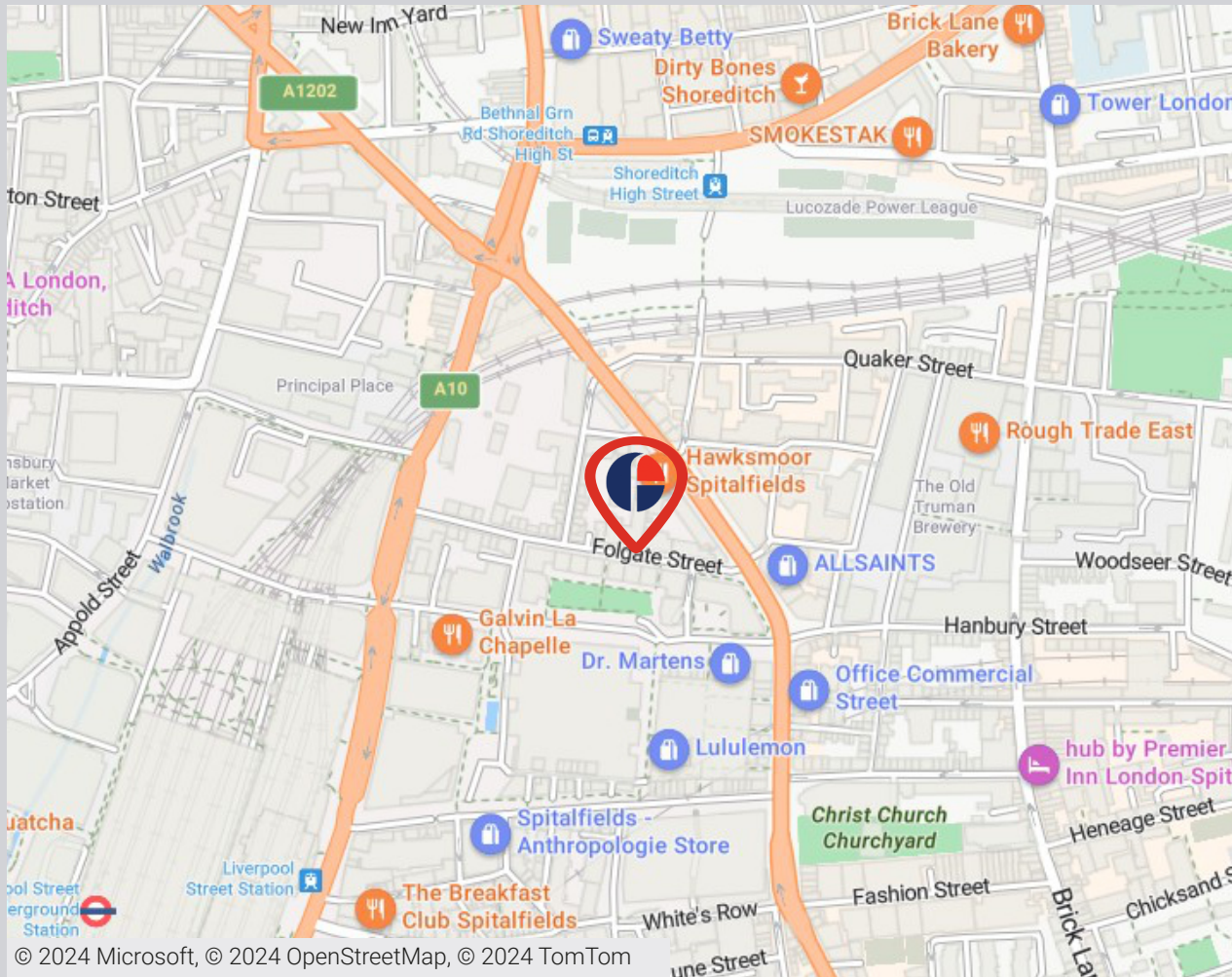

© 2024 Microsoft, © 2024 OpenStreetMap, © 2024 TomTom

Approximate Travel Distances

Nearest Station

- Shoreditch High Street Station - 5 min walk
- London Liverpool Street Station - 7 min walk
- Moorgate Underground & Rail Station - 14 min walk

Contact

	Ed Moore 020 7367 5393 07957 121681 ed.moore@fishergerman.co.uk
	Liam Carvalho 0207 747 3194 07884 414 418 liam.carvalho@fishergerman.co.uk
	Doug Gordon 0207 747 3117 07884 408 136 doug.gordon@fishergerman.co.uk

fishergerman.co.uk



Please Note: Fisher German LLP and its Joint Agents give notice that: 1. They have no authority to make or give any representation or warranty on any property whether on their own behalf or on behalf of their clients or otherwise. 2. They do not owe any duty of care to you and assume no responsibility for any statements, representations, warranties or otherwise made in the particulars and you should not rely on those in the particulars. 3. The particulars are produced in good faith are set out as a general guide only and do not constitute or form an offer or a contract or part thereof. 4. Any photographs, descriptions, plans, measurements, distances and any other details in the particulars are approximate estimates only taken as the property appeared at the time and should not be relied upon as factually accurate. 5. Fisher German assumes prospective purchasers/tenants have carried out inspections to satisfy themselves that the information in the particulars is correct.

Particulars dated May 2024. Photographs dated August 2023.