

Industrial Warehouse

3100 E Cedar St, Unit 22, Ontario, CA



Property Highlights

- +/-1,890 SF Warehouse, POL 3,250 SF Condo
- Newly Remodeled
- 18' Minimum Clearance
- One (1) - 12'W x 14'H Grade Level Doors
- Zoning - Industrial per the California Commerce Center South Specific Plan
- One (1) Restroom
- Two (2) Dedicated Employee Parking Spaces + more as available
- Asking Rate: \$1.25 PSF Gross or \$2,362.50/month

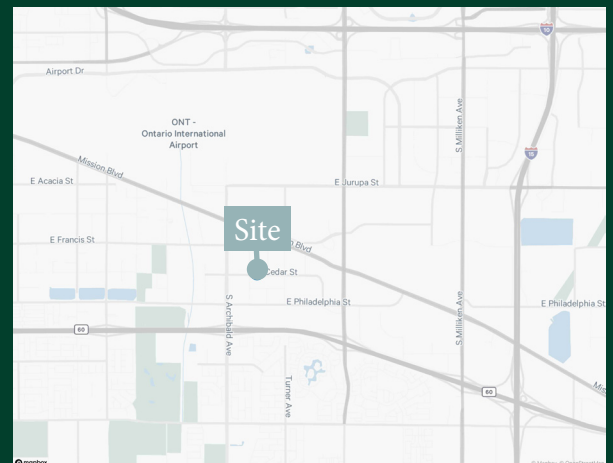

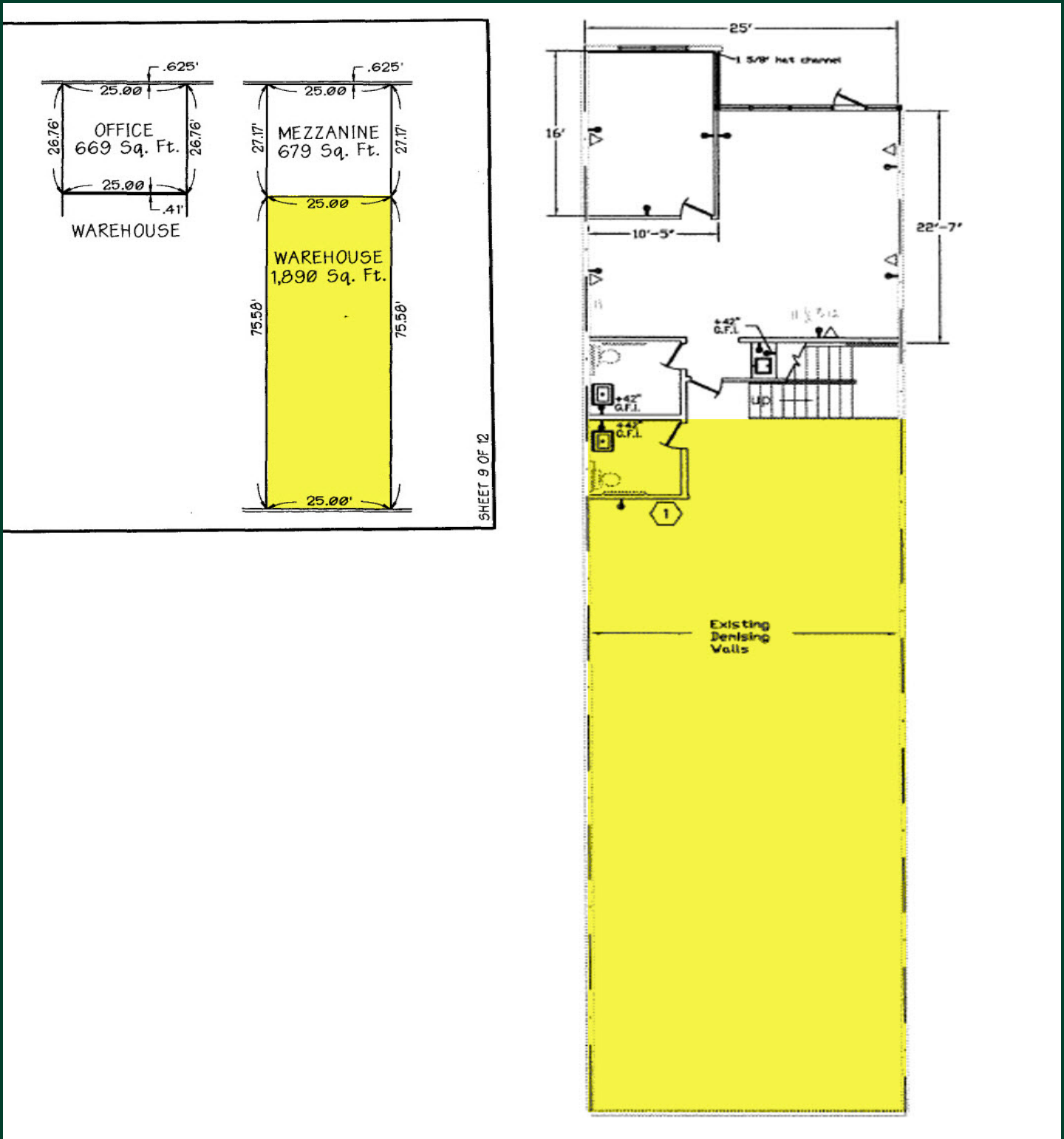

© 2021 CBRE, Inc. All rights reserved. This information has been obtained from sources believed reliable, but has not been verified for accuracy or completeness. You should conduct a careful, independent investigation of the property and verify all information. Any reliance on this information is solely at your own risk. CBRE and the CBRE logo are service marks of CBRE, Inc. All other marks displayed on this document are the property of their respective owners, and the use of such logos does not imply any affiliation with or endorsement of CBRE. Photos herein are the property of their respective owners. Use of these images without the express written consent of the owner is prohibited.



Contact Us

Justin Kuehn
First Vice President
+1 909 418 2013
Justin.Kuehn@cbre.com
Lic. 01966182

Ben Chau
NAI Capital Commercial
+1 909 243 7621
Bchau@naicapital.com
Lic. 02119013

© 2021 CBRE, Inc. All rights reserved. This information has been obtained from sources believed reliable, but has not been verified for accuracy or completeness. You should conduct a careful, independent investigation of the property and verify all information. Any reliance on this information is solely at your own risk. CBRE and the CBRE logo are service marks of CBRE, Inc. All other marks displayed on this document are the property of their respective owners, and the use of such logos does not imply any affiliation with or endorsement of CBRE. Photos herein are the property of their respective owners. Use of these images without the express written consent of the owner is prohibited.