

# BELTSVILLE

## INDUSTRIAL CENTER

### 10225 SOUTHARD DRIVE | BUILDING B

#### Available

12,049 SF

#### Parking Ratio

1.3 spaces/ 1,000 sf

#### Column Spacing

44 ft x 33 ft

#### Clear Height

18 ft

#### Features

- Building end-cap
- Fully conditioned office area
- LED lights
- 2 Loading docks, 1 drive-in

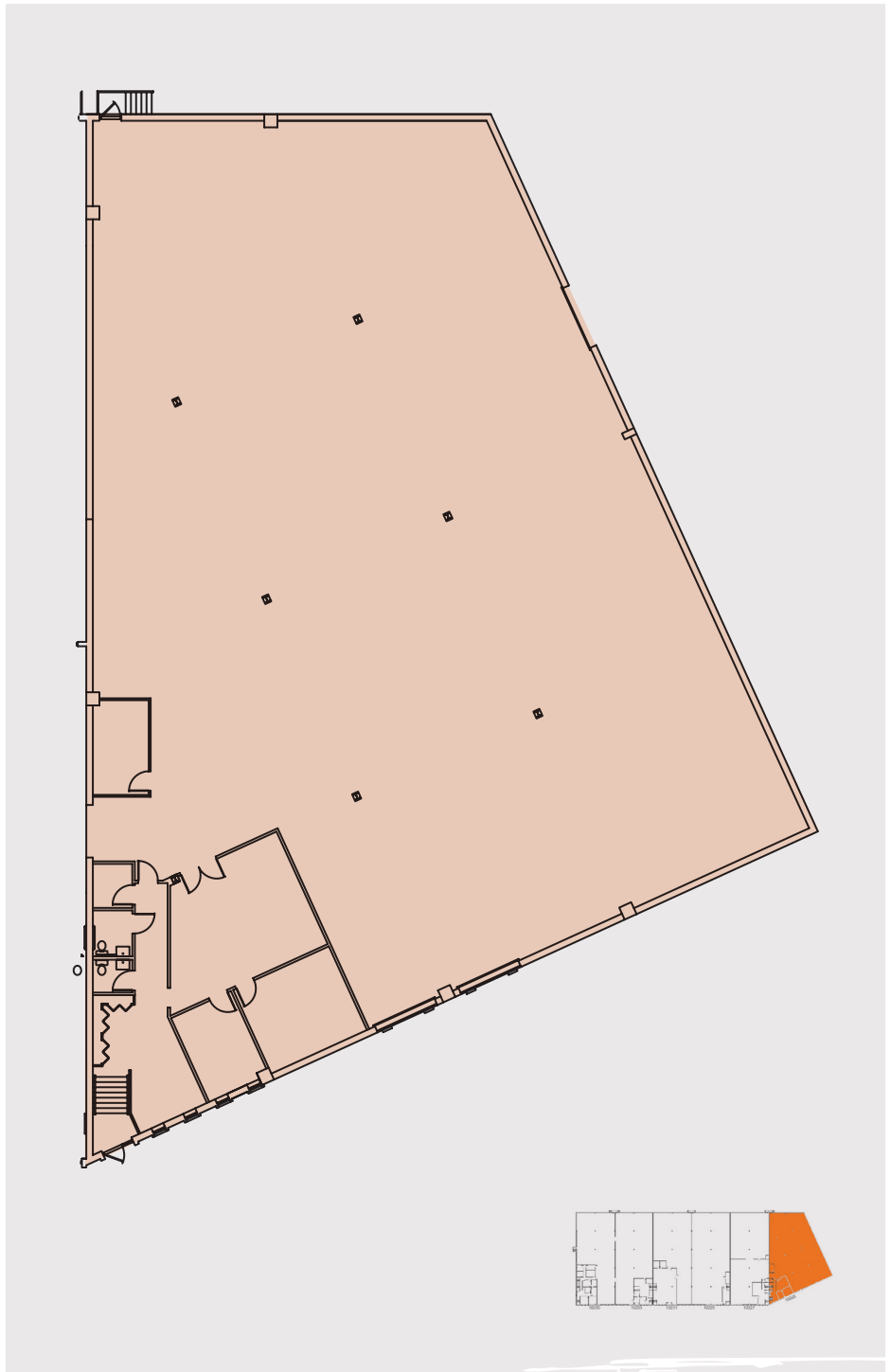
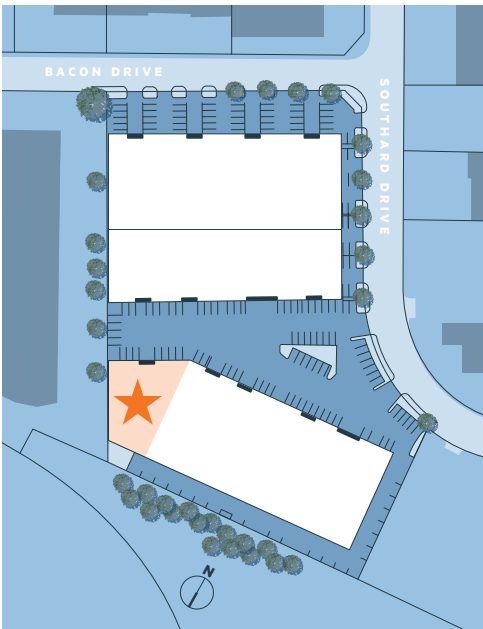

**Mike Maites | Director of Leasing**  
mmaites@minkoffdev.com

**Ben Wiebusch | Leasing Associate**  
bwiebusch@minkoffdev.com

**240.912.0200 | [minkoffdev.com](http://minkoffdev.com)**

**REAL ESTATE**  
**PERSONAL PERSPECTIVE**