

FOR LEASE

# LANDMARK COMMERCE CENTER

1300 N Florida Mango Road, West Palm Beach, FL



## Space Available

Suite Number	Square Footage	Lease Rate
Suite 32-33A	3,500 SF	\$18.95 NNN \$6.43 OpEx

## Property Highlights

- Built in 1985
- 9' clear ceiling height
- All office / showroom
- 2 offices
- 3 bathrooms
- 1 grade level door
- Located less than a mile from I-95, 2 miles from Palm Beach International Airport, and 2.5 miles from Downtown West Palm Beach.

## Contact

Christopher Thomson, SIOR  
Vice Chairman  
+1 561 227 2019  
[Christopher.thomson@cushwake.com](mailto:Christopher.thomson@cushwake.com)

Eric Cantor  
Brokerage Specialist  
+1 561 227 2068  
[Eric.cantor@cushwake.com](mailto:Eric.cantor@cushwake.com)

Juliana Palmisano  
Brokerage Specialist  
+1 561 729 7478  
[Juliana.palmisano@cushwake.com](mailto:Juliana.palmisano@cushwake.com)

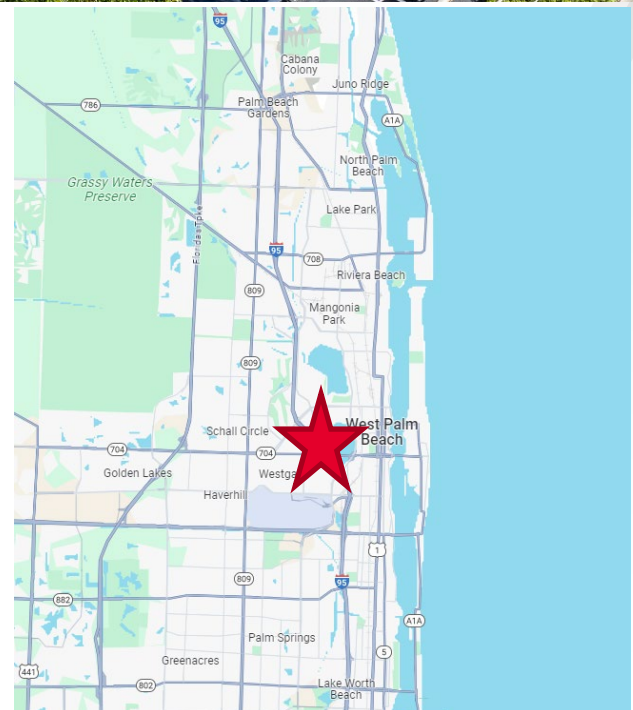

FOR LEASE

# LANDMARK COMMERCE CENTER

1300 N Florida Mango Road, West Palm Beach, FL



CUSHMAN &  
WAKEFIELD

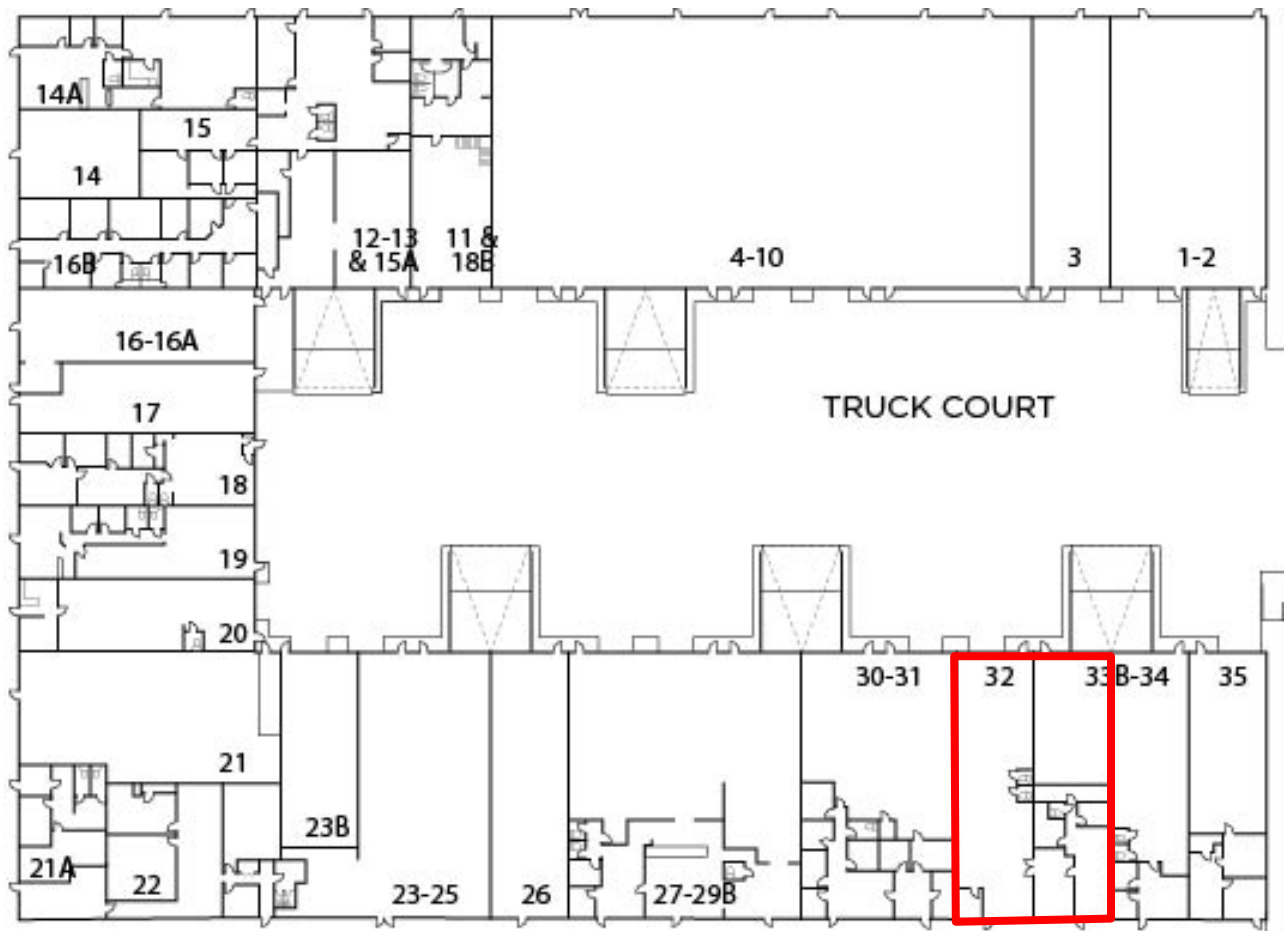

## Contact

Christopher Thomson, SIOR  
Vice Chairman  
+1 561 3012390  
[Christopher.thomson@cushwake.com](mailto:Christopher.thomson@cushwake.com)

Eric Cantor  
Brokerage Specialist  
+1 561 227 2068  
[Eric.cantor@cushwake.com](mailto:Eric.cantor@cushwake.com)

Juliana Palmisano  
Brokerage Specialist  
+1 561 729 7478  
[Juliana.palmisano@cushwake.com](mailto:Juliana.palmisano@cushwake.com)