

1540

1555

RIVER PARK DRIVE
SACRAMENTO, CA

PROPERTY HIGHLIGHTS

- Completely renovated and revitalized office park
- Excellent Proximity to numerous retail & dining amenities
- Great access to Business 80 & Highway 160
- Conference facilities
- Spaces built out for immediate occupancy
- Featured spaces contain private outdoor balconies
- 4.00/1,000 SF Parking Ratio

SPENCER NIELSEN

Director

+1 916 288 4531

spencer.nielsen@cushwake.com

CA LIC #01964163

SEAN MULLEN

Managing Director

+1 916 288 4811

sean.mullen@cushwake.com

CA LIC #01845406



1540 RIVER PARK DRIVE

1ST FLOOR

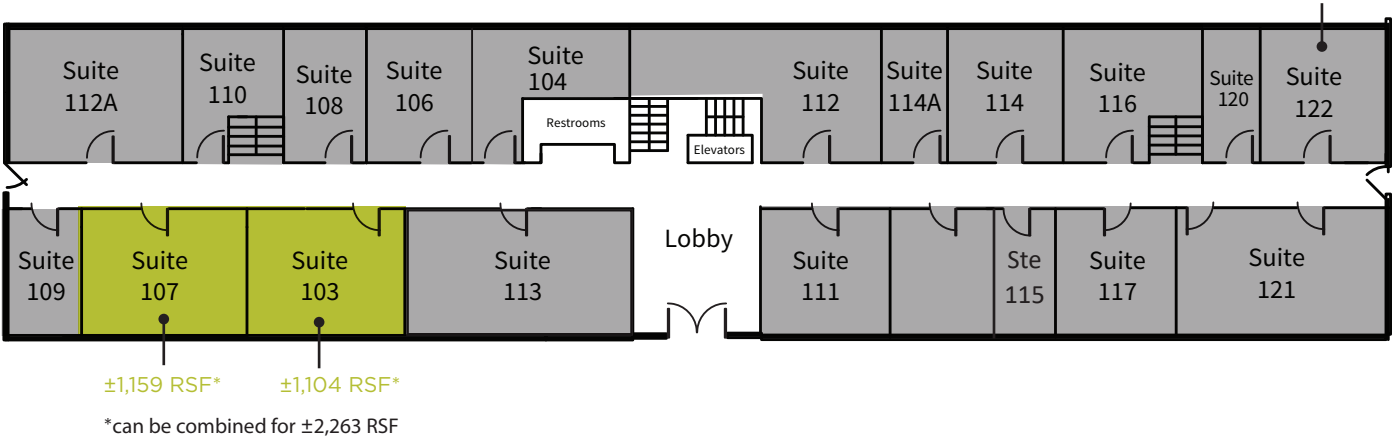

2ND FLOOR

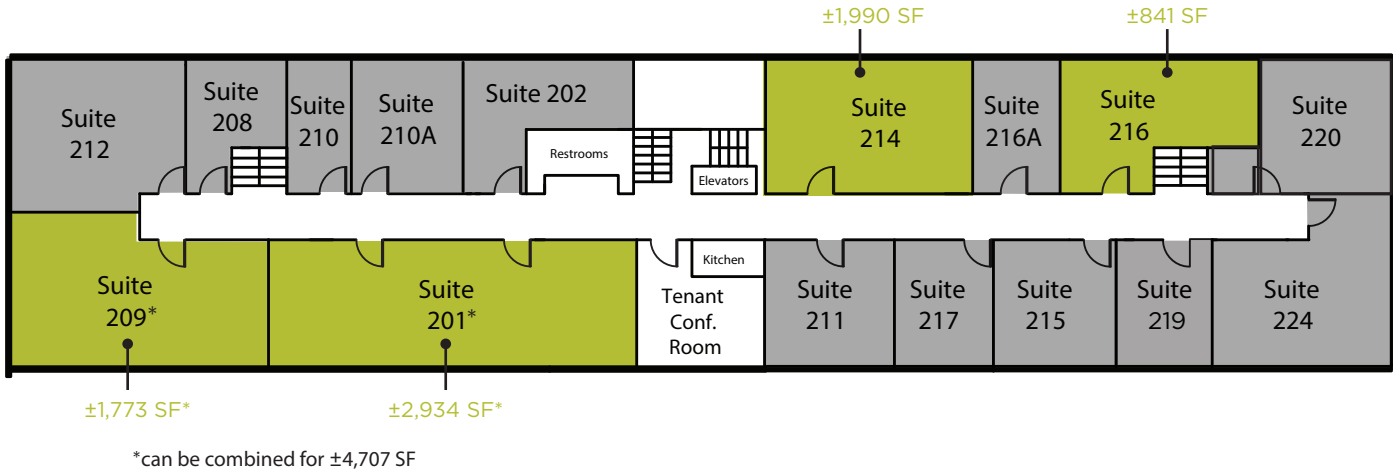

■ AVAILABLE FOR LEASE

■ LEASED

SPENCER NIELSEN
 Director
 +1 916 288 4531
 spencer.nielsen@cushwake.com
 CA LIC #01964163

SEAN MULLEN
 Managing Director
 +1 916 288 4811
 sean.mullen@cushwake.com
 CA LIC #01845406



PROPERTY PHOTOS



SPENCER NIELSEN
Director
+1 916 288 4531
spencer.nielsen@cushwake.com
CA LIC #01964163

SEAN MULLEN
Managing Director
+1 916 288 4811
sean.mullen@cushwake.com
CA LIC #01845406



CAL EXPO

80+ EVENTS PER YEAR
4M+ ANNUAL VISTIORS

HBA HOWEBOUTARDEN

CENTURY THEATRES
NORDSTROM RACK
HOMEGOODS
THE CONTAINER STORE
STARBUCKS
CARTERS
PINKBERRY
NIKE OUTLET STORE
MOD PIZZA
JAMBA JUICE

POINT WEST PLAZA

KOHL'S
OLD NAVY
HOBBY LOBBY
FIVE BELOW
PETCO

ARDEN MALL

MACY'S
JCPENNEY
APPLE
COACH
MICHAEL KORS
LULUEMON
SEASON 52
SEPHORA
BANANA REPUBLIC
FOOT LOCKER
BJ'S RESTAURANT
85°C BAKERY

PROPERTY

MARKET SQUARE

BARNES & NOBLE
CALIFORNIA PIZZA KITCHEN
DSW
BEST BUY
DOS COYOTES
CRUNCH FITNESS
FEDEX

SPENCER NIELSEN
Director
+1 916 288 4531
spencer.nielsen@cushwake.com
CA LIC #01964163

SEAN MULLEN
Managing Director
+1 916 288 4811
sean.mullen@cushwake.com
CA LIC #01845406



SPENCER NIELSEN | DIRECTOR

+1 916 288 4531

spencer.nielsen@cushwake.com

CA LIC #01964163

SEAN MULLEN | MANAGING DIRECTOR

+1 916 288 4811

sean.mullen@cushwake.com

CA LIC #01845406

400 Capitol Mall, Suite 1800

Sacramento, CA 95814

+1 916 288 4800

cushmanwakefield.com

1540