



GHOST KITCHEN MIDTOWN SHOPPING CENTER WARDS CORNER BUSINESS DISTRICT

Property Features:

Excellent Location

Situated on the Northeast corner of Granby Street and East Little Creek Road, the most prestigious intersection of Historic Norfolk.

Traffic Counts

E. Little Creek Rd. 21,517 VPD (2023)
Granby Street 22,379 VPD (2023)

Area Tenancy

Harris Teeter, Starbucks, Chipotle, Original Mattress Factory, Clean Eat Restaurant



ASKING
PRICE

Call Broker

This approximately 2,290 sqft. Ghost Kitchen is equipped with 1 walk-in freezer & 1 walk-in cooler. Centrally located within Midtown Shopping Center with adjacent parking & direct access.

FOR LEASE



Contact Us
757-898-7890

Visit Our Website
www.retailadvisors.us





**MIDTOWN
SHOPPING CENTER,
NORFOLK VA**

The Wards Corner business district offers the gateway to the Ghent Community and the world's largest Naval Base, Naval Station Norfolk, as well as the beautiful coastal water front of Ocean View Avenue. This approximately 152,364 sq. ft. sq. ft. Urban Mixed Use Retail facility is situated on 4.6 acres.



Demographic Summary

	<u>1 mile</u>	<u>2 miles</u>	<u>3 miles</u>
2023 Estimated Population:	13,053	44,689	119,579
2023 Est. Median HH Income:	\$57,843	\$69,333	\$66,739
2023 Est. Total Employees:	2,758	11,614	28,408

This conceptual rendering is purely conceptual and is subject to change.

Contact Us
757-898-7890

Visit Our Website
www.retailadvisors.us 

MIDTOWN SHOPPING CENTER

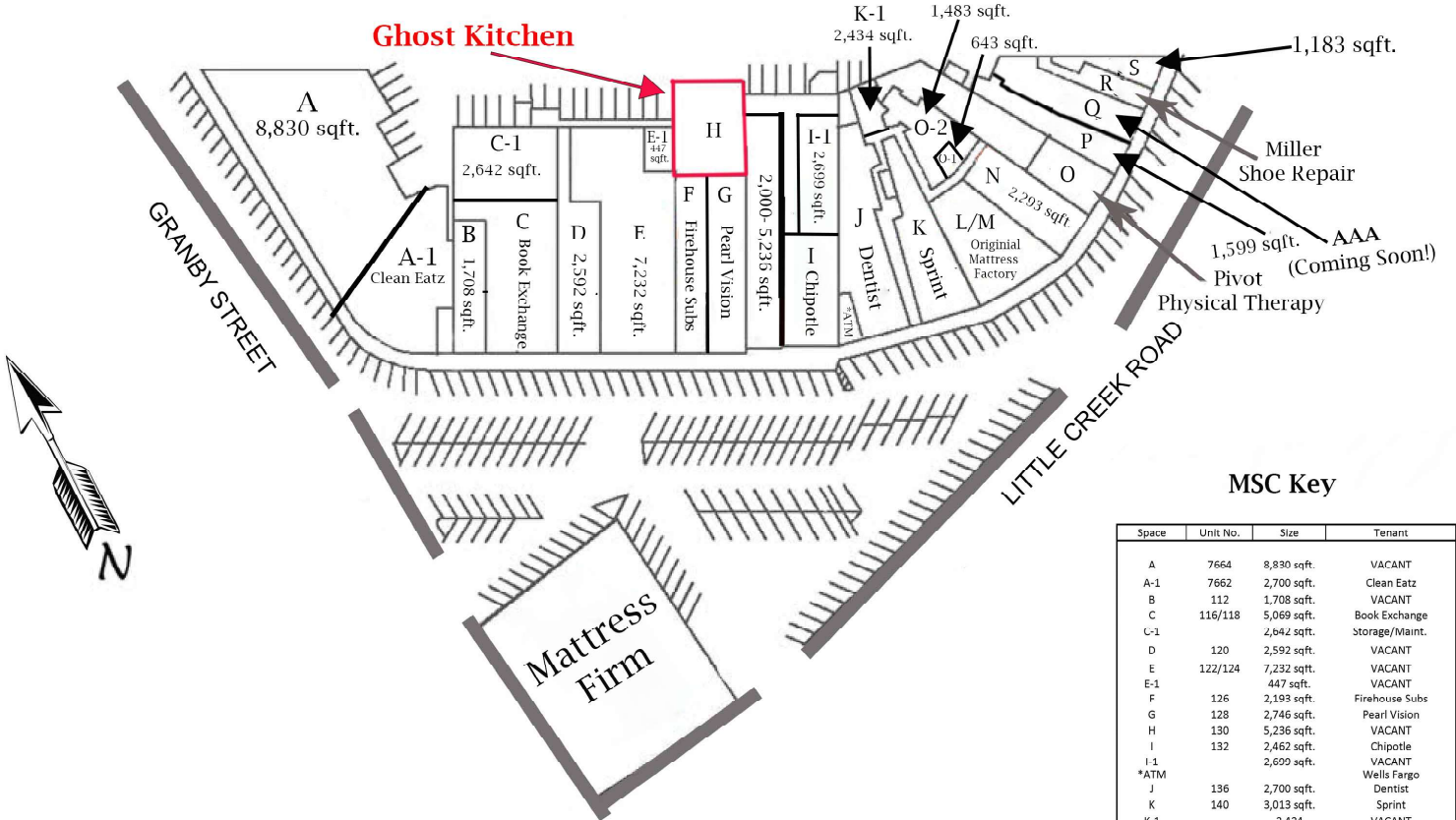



Area Tenancy

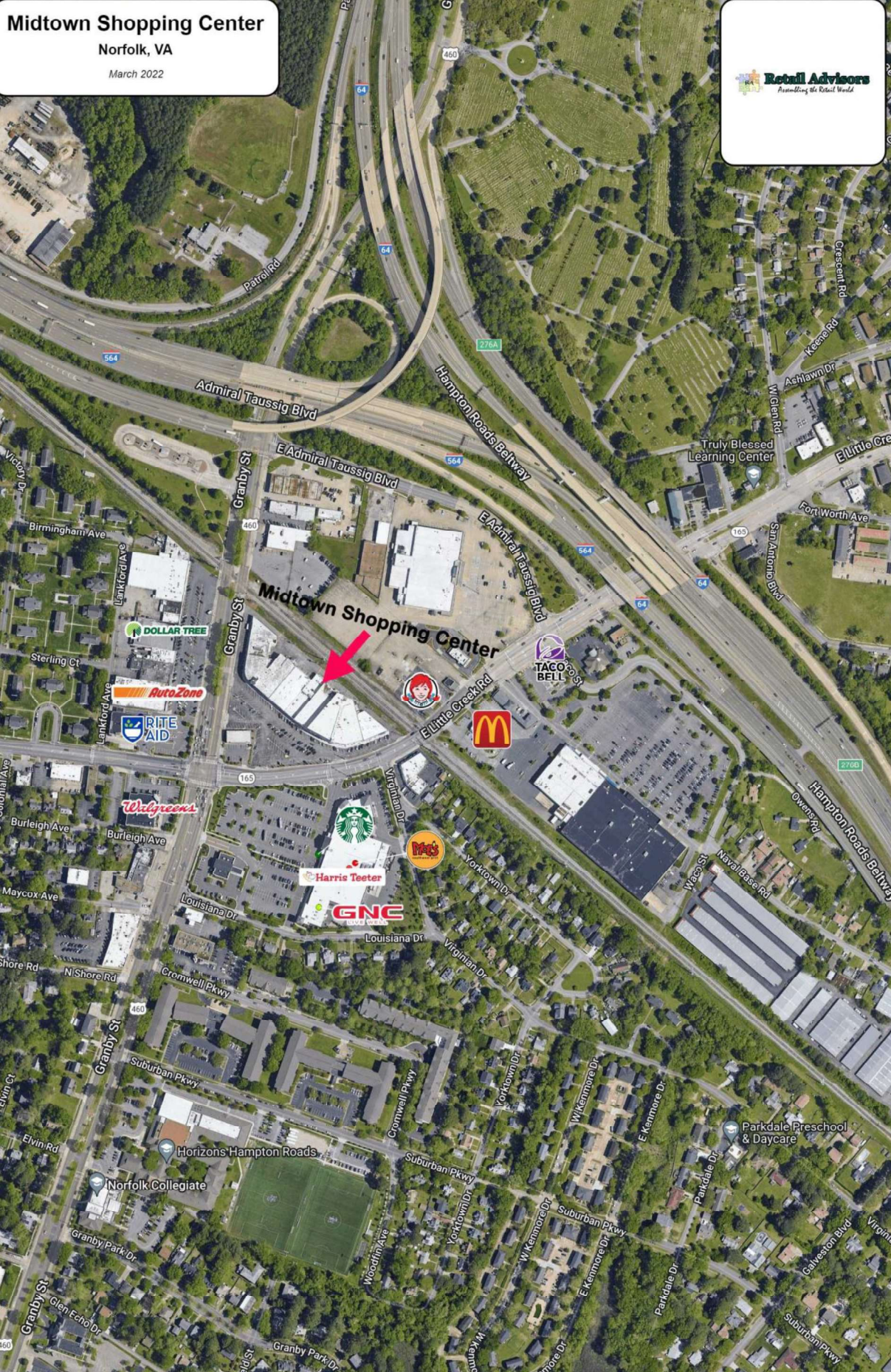

 Grocery Stores

Harris Teeter

 Fast Food

Starbucks, Moe's, McDonald's, Wendy's, Taco Bell

 Retail

Walgreens, Rite Aid, AutoZone, GNC, Dollar Tree

Summary Profile

2010-2020 Census, 2023 Estimates with 2028 Projections
 Calculated using Weighted Block Centroid from Block Groups

Retail Advisors, Inc.
 Lat/Lon: 36.9153/-76.2718

Midtown Shopping Center Norfolk, VA 23505	1 mi radius	2 mi radius	3 mi radius
Population			
2023 Estimated Population	13,053	44,689	119,579
2028 Projected Population	12,623	43,525	117,287
2020 Census Population	13,310	45,655	121,023
2010 Census Population	13,933	45,519	117,882
Projected Annual Growth 2023 to 2028	-0.7%	-0.5%	-0.4%
Historical Annual Growth 2010 to 2023	-0.5%	-0.1%	0.1%
2023 Median Age	34.9	33.5	32.4
Households			
2023 Estimated Households	6,453	19,419	48,670
2028 Projected Households	5,961	18,025	45,401
2020 Census Households	6,516	19,596	48,812
2010 Census Households	6,455	18,789	46,173
Projected Annual Growth 2023 to 2028	-1.5%	-1.4%	-1.3%
Historical Annual Growth 2010 to 2023	-	0.3%	0.4%
Race and Ethnicity			
2023 Estimated White	46.7%	47.6%	45.8%
2023 Estimated Black or African American	38.7%	35.1%	34.1%
2023 Estimated Asian or Pacific Islander	4.2%	3.9%	6.7%
2023 Estimated American Indian or Native Alaskan	0.4%	0.7%	0.6%
2023 Estimated Other Races	9.9%	12.8%	12.7%
2023 Estimated Hispanic	9.1%	9.6%	8.8%
Income			
2023 Estimated Average Household Income	\$81,336	\$97,480	\$93,904
2023 Estimated Median Household Income	\$57,843	\$69,333	\$66,739
2023 Estimated Per Capita Income	\$40,223	\$43,345	\$39,534
Education (Age 25+)			
2023 Estimated Elementary (Grade Level 0 to 8)	2.9%	3.1%	2.8%
2023 Estimated Some High School (Grade Level 9 to 11)	8.1%	7.3%	7.0%
2023 Estimated High School Graduate	24.0%	23.4%	24.5%
2023 Estimated Some College	25.3%	23.9%	23.7%
2023 Estimated Associates Degree Only	9.8%	9.0%	8.6%
2023 Estimated Bachelors Degree Only	19.2%	19.9%	20.0%
2023 Estimated Graduate Degree	10.8%	13.4%	13.4%
Business			
2023 Estimated Total Businesses	331	1,200	2,963
2023 Estimated Total Employees	2,758	11,614	28,408
2023 Estimated Employee Population per Business	8.3	9.7	9.6
2023 Estimated Residential Population per Business	39.4	37.2	40.4

©2023, Sites USA, Chandler, Arizona, 480-491-1112 Demographic Source: Applied Geographic Solutions 4/2023, TIGER Geography - RS1

This report was produced using data from private and government sources deemed to be reliable. The information herein is provided without representation or warranty.

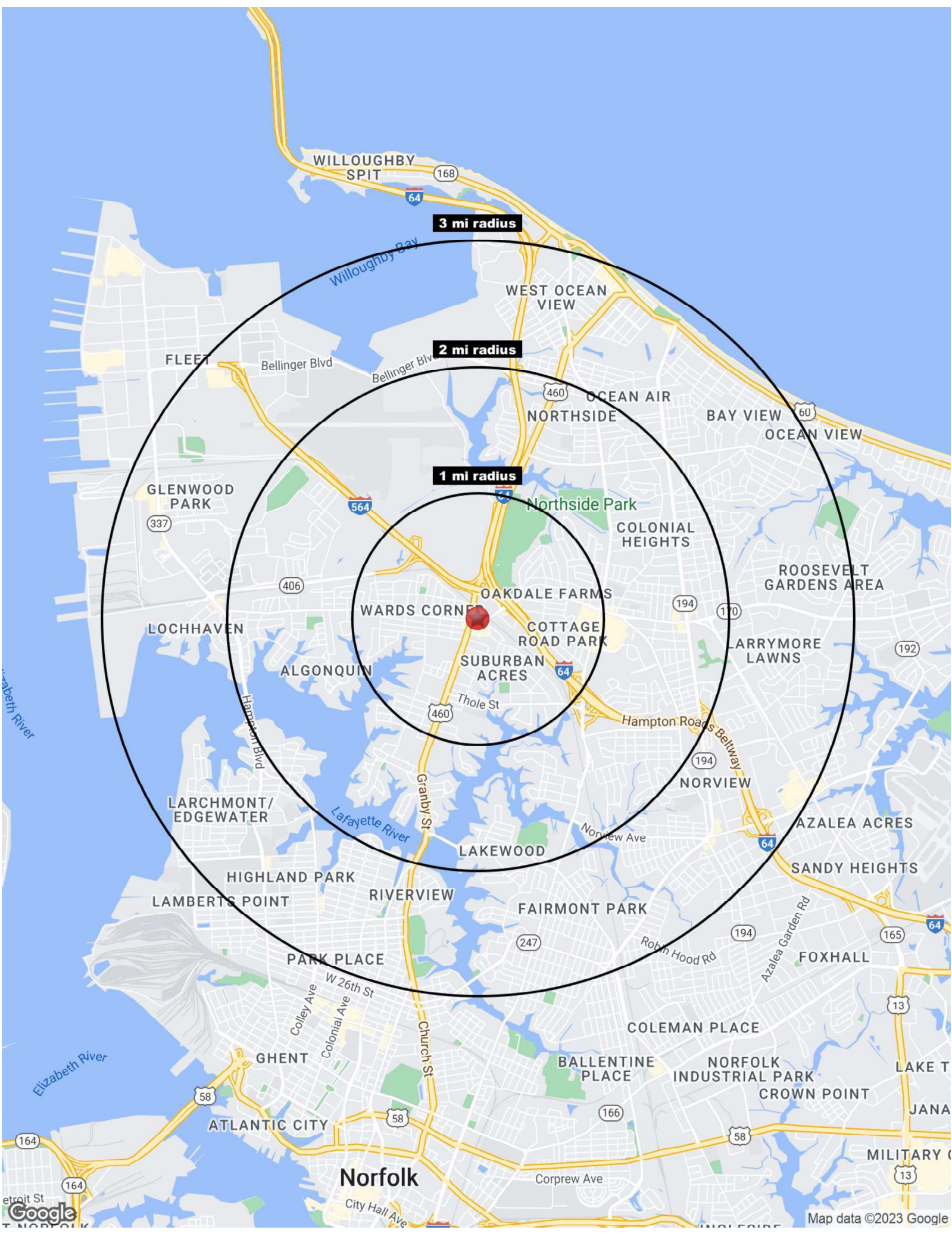

3 mi radius

2 mi radius

1 mi radius

WARDS CORNER

Norfolk