



Sublease Expiration: May 2029

10182 Croydon Way, Rancho Cordova, CA

For Sublease | ±36,000 SF

Nathan Miller
Senior Associate
+1 916 563 3011
nathan.miller@colliers.com
CA Lic. 02097602

Michael Hoo, MBA
Vice President
+1 916 563 3087
michael.hoo@colliers.com
CA Lic. 01989521

Mark Demetre, SIOR
Vice Chair
+1 916 563 3010
mark.demetre@colliers.com
CA Lic. 00852871



Floor Plan

GL Door

DH Door

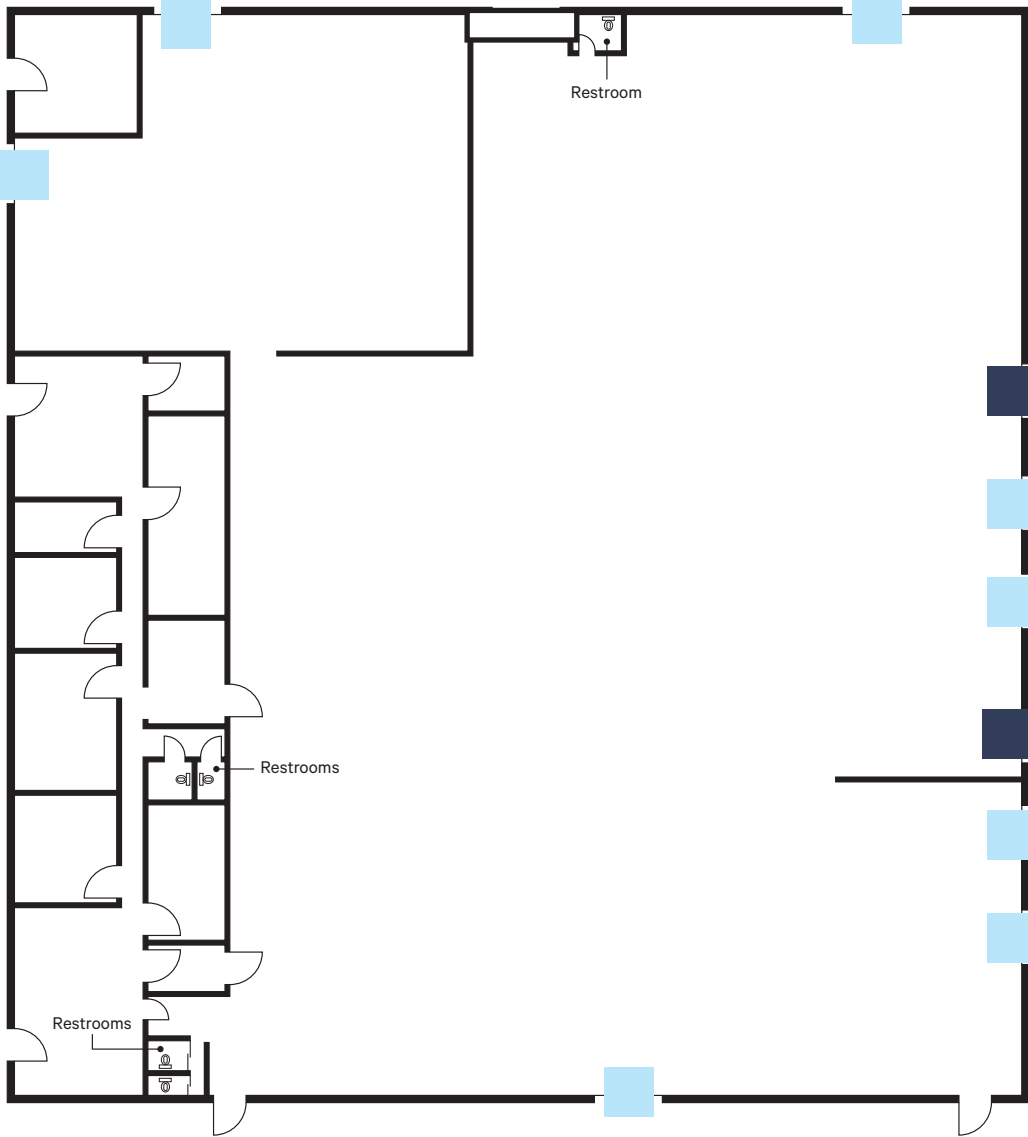

Property Overview



Building Sq. Ft. ±36,000 SF Total

Office Sq. Ft. ±5,000 SF

Zoning OIMU (FBSP)
[Click here to view uses](#)

Loading 2 (12'x14') Dock Doors
6 (10x10') GL Doors
3 (12'x14') GL Doors

Clear Height 18' - 22'

Yard ±10,000 SF fenced and paved

Year Built 1977

Sprinklers Yes

Features

- 20' x 60' Column Spacing
- Natural Gas

\$0.65 PSF
Asking Rate



Location Overview



Convenient access to
Highway 50 - <1 Mile



Nathan Miller
Senior Associate
+1 916 563 3011
nathan.miller@colliers.com
CA Lic. 02097602

Michael Hoo, MBA
Vice President
+1 916 563 3087
michael.hoo@colliers.com
CA Lic. 01989521

Mark Demetre, SIOR
Vice Chair
+1 916 563 3010
mark.demetre@colliers.com
CA Lic. 00852871

This document/email has been prepared by Colliers for advertising and general information only. Colliers makes no guarantees, representations or warranties of any kind, expressed or implied, regarding the information including, but not limited to, warranties of content, accuracy and reliability. Any interested party should undertake their own inquiries as to the accuracy of the information. Colliers excludes unequivocally all inferred or implied terms, conditions and warranties arising out of this document and excludes all liability for loss and damages arising there from. This publication is the copyrighted property of Colliers and /or its licensor(s). © 2026. All rights reserved. This communication is not intended to cause or induce breach of an existing listing agreement.

