



ZACUTO GROUP
COMMERCIAL REAL ESTATE

STARBUCKS COFFEE

Of The Cloth
INDIE CLOTHING

UNDISPUTED
PRINCIPLES

**CORNER FOR LEASE
FORMER STARBUCKS**

**603
S. SPRING
STREET**

DOWNTOWN LOS ANGELES

LEASE DETAILS

603 S. SPRING STREET
DOWNTOWN LA, 90014

SIZE

2,423 SF

RATE

\$3.50/SF NNN
~ \$0.15/SF NETS

PARKING

STREET

TERM

Negotiable

- Highly visible corner retail space in Historic DTLA.
Formerly occupied by Starbucks.
- Light and bright space with oversized windows, exposed industrial style ceilings, accent lighting and historic accents throughout.
- Generous open seating and counter area + large backarea with storage.
- Walking distance to many amenities including popular restaurants, retail, entertainment, hotels and the Metro.



LISTING TEAM



JAKE ZACUTO
Managing Director
310.469.9012
jake@zacutogroup.com
DRE #01377441

MATT AMBROSE
Director
213.431.2511
matta@zacutogroup.com
DRE #02128242

**CURRENT
INTERIOR**

603
**S. SPRING
STREET**
DOWNTOWN LOS ANGELES



INTERIOR

LEASE

603 S. SPRING STREET, DTLA 90014

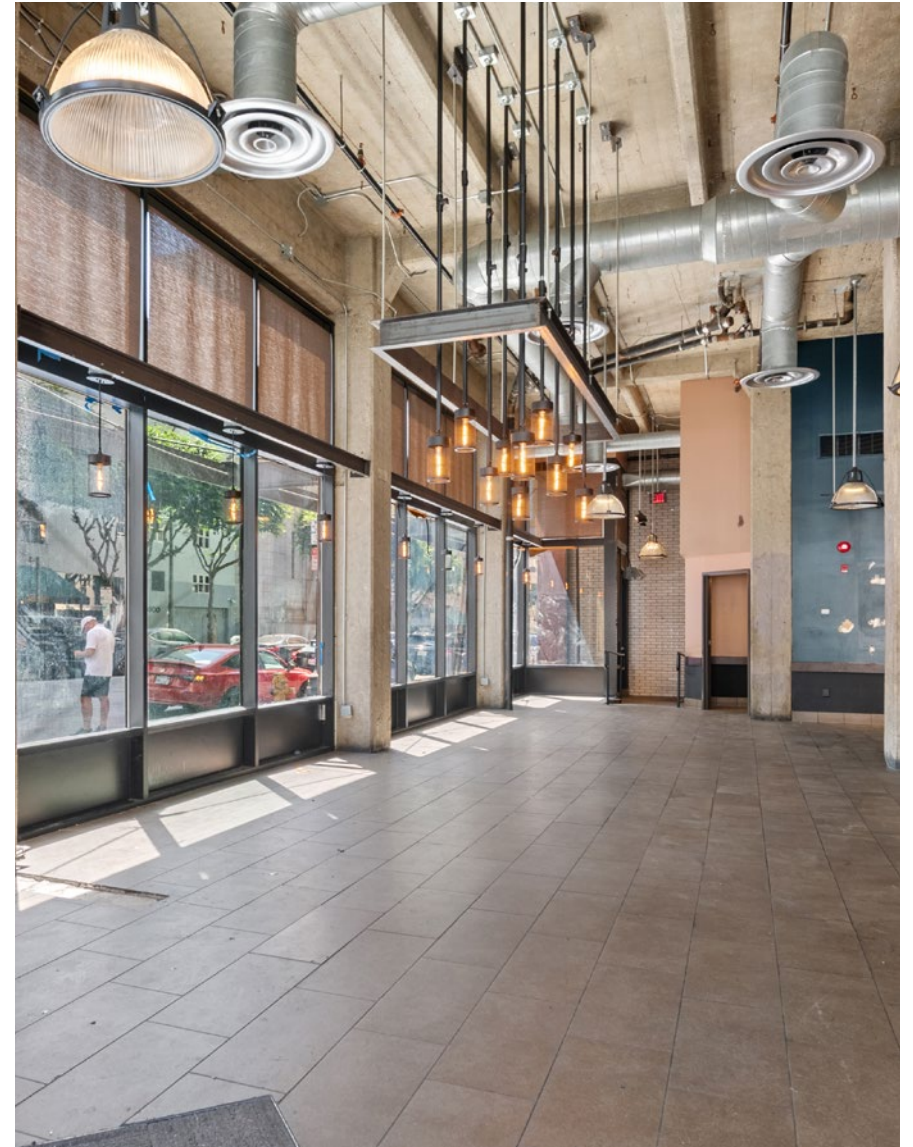

FLOORPLAN

603 S. SPRING STREET, DTLA 90014

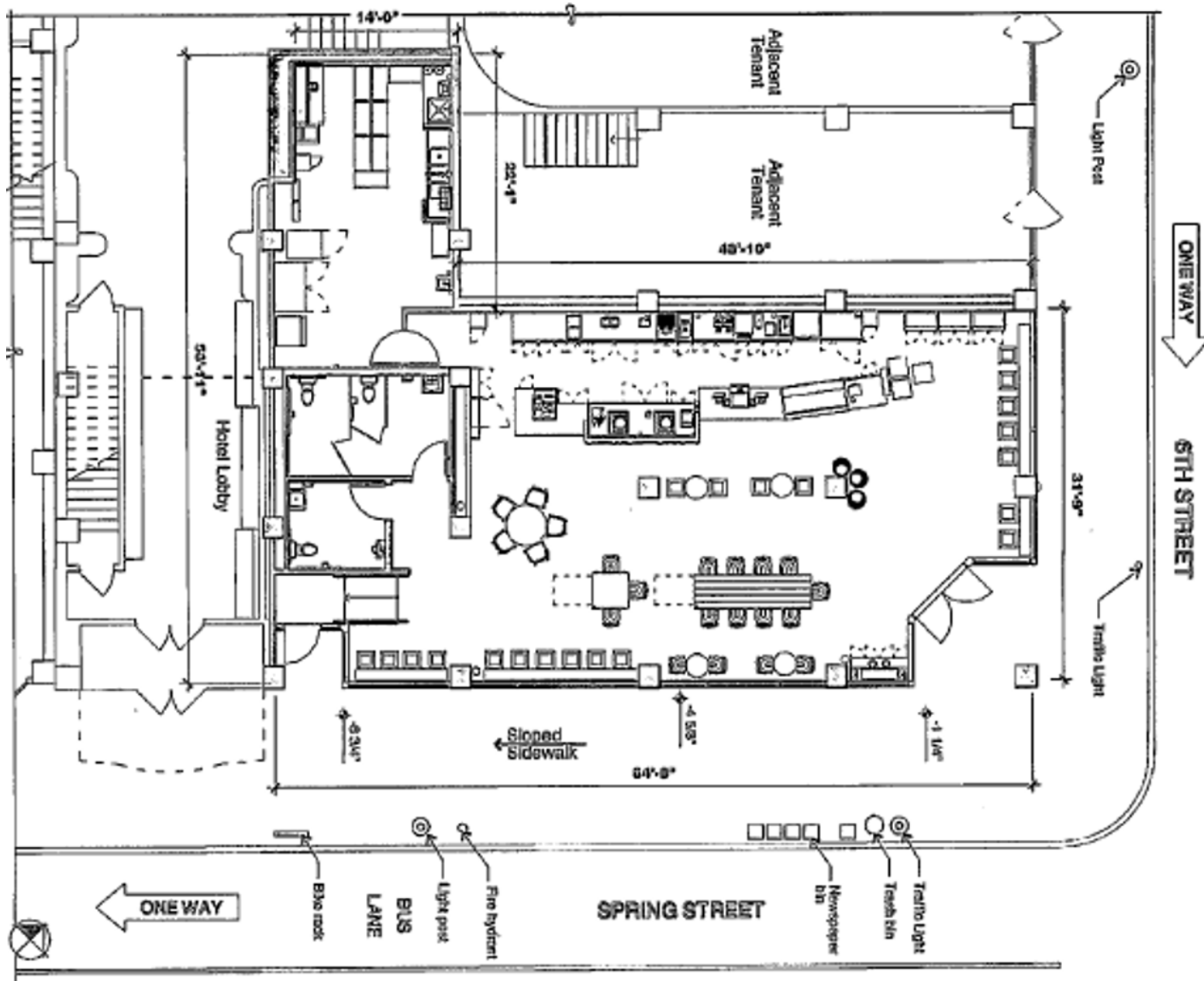

CURRENT
INTERIOR

603
S. SPRING
STREET

DOWNTOWN LOS ANGELES



HIGH
VISIBILITY
CORNER



603
S. SPRING
STREET

DOWNTOWN LOS ANGELES

WALKING DISTANCE TO THE BEST RESTAURANTS, ENTERTAINMENT & AMENITIES IN DTLA



📍 BOTTEGA LOUIE



📍 LAST BOOKSTORE

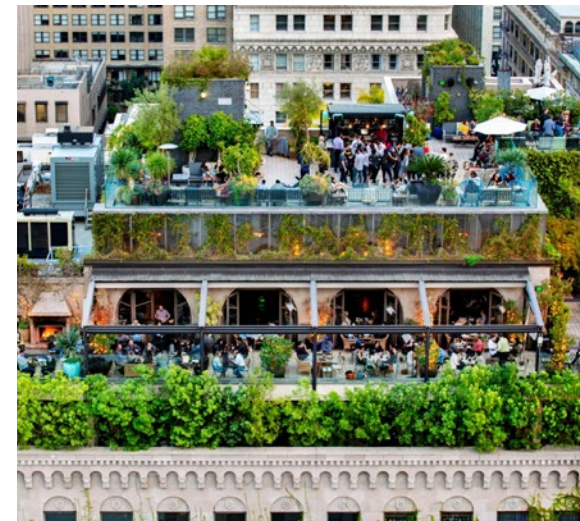

📍 PERCH LOS ANGELES



📍 MOCA MUSEUM



📍 GRAND CENTRAL MARKET



📍 LITTLE SISTER

603 S. SPRING STREET

DOWNTOWN LOS ANGELES

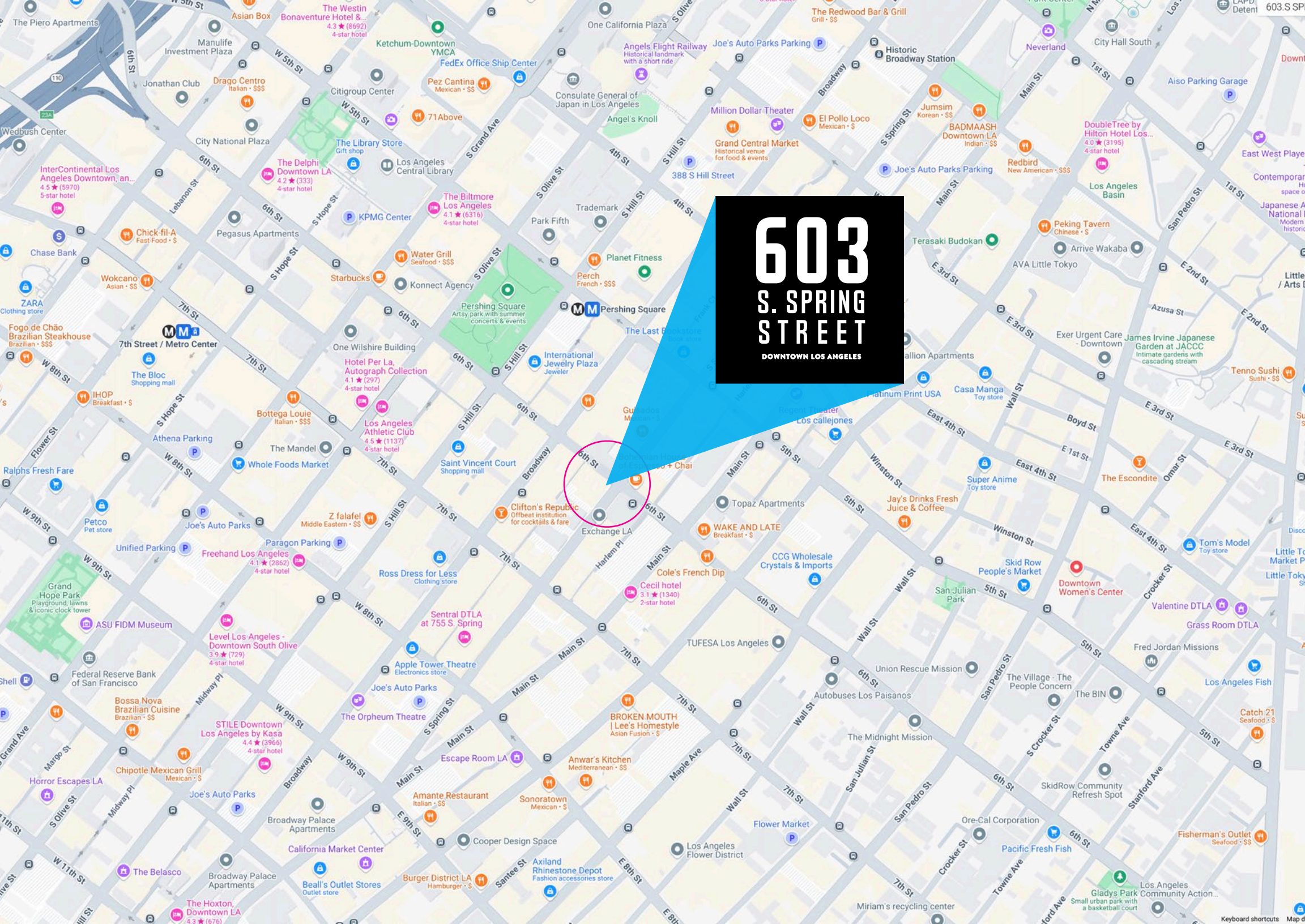

603

S. SPRING STREET

DOWNTOWN LOS ANGELES



JAKE ZACUTO
Managing Director

310.469.9012
jake@zacutogroup.com
DRE #01377441

MATT AMBROSE
Director

213.431.2511
matta@zacutogroup.com
DRE #02128242

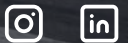

ZACUTOGROUP.COM | 310.469.9300

No warranty, express or implied, is made as to the accuracy of the information contained herein. This information is submitted subject to errors, omissions, change of price, rental or other conditions, withdrawal without notice. All parties who receive this material should not rely on it, but should use it as a starting point of analysis, and should independently confirm the accuracy of the information contained herein through a due diligence review of the books, records, files and documents that constitute reliable sources of the information described herein. Logos and images are for identification purposes only and may be trademarks of their respective companies. All terms provided are approximate. Lessee to verify. 12/2024