



**COLDWELL
BANKER
COMMERCIAL**

LYLE & ASSOCIATES, LP

HERITAGE COURT SHOPPING CENTER

\$2.25 PSF/MO (NNN)

AVAILABLE SPACES

1,758 SF



FOR LEASE

CBCWORLDWIDE.COM

CONTACT

Curtis Barlow
760 899 7700
cbarlow@cbclyle.net
CaIDRE #01380247

©2023 Coldwell Banker. All Rights Reserved. Coldwell Banker Commercial® and the Coldwell Banker Commercial logos are trademarks of Coldwell Banker Real Estate LLC. The Coldwell Banker® System is comprised of company owned offices which are owned by a subsidiary of Anywhere Advisors LLC and franchised offices which are independently owned and operated. The Coldwell Banker System fully supports the principles of the Equal Opportunity Act.

COLDWELL BANKER COMMERCIAL
LYLE & ASSOCIATES, LP
78000 Fred Waring Drive, Suite 200, Palm Desert, CA 92211
760.772.6400



HERITAGE COURT SHOPPING CENTER

44-100 Jefferson Street, Indio, CA 92201

LEASE

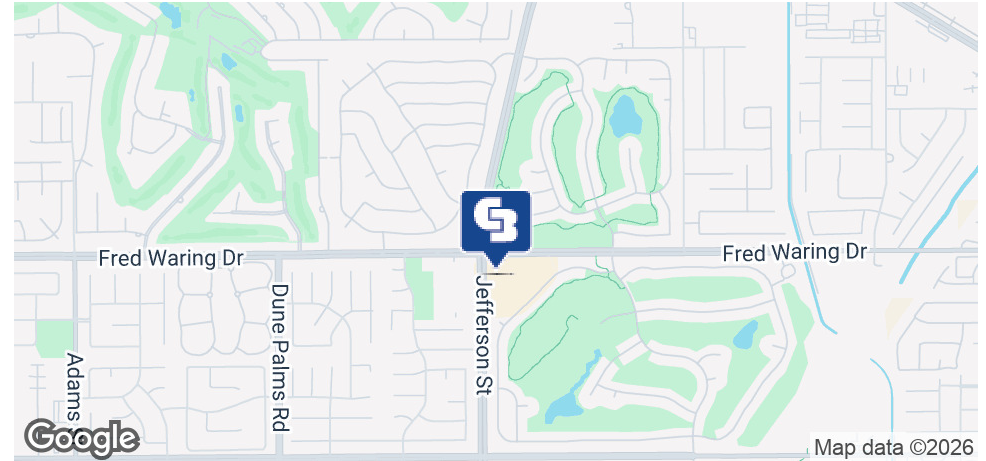

OFFERING SUMMARY

Available SF:	1,758 SF
Lease Rate:	\$2.25 PSF/month (NNN)
Lot Size:	11.29 Acres
Year Built:	2005
Building Size:	108,319 SF
Renovated:	2018
Zoning:	NC Neighborhood Commercial
Market:	Inland Empire
Submarket:	Coachella Valley

PROPERTY OVERVIEW

Walmart Neighborhood Market is the anchor.
 Competitive rental rates.
 Term: 5 years minimum.
 Tenant improvement allowance is negotiable. Options negotiable.

PROPERTY HIGHLIGHTS

- Walmart Neighborhood Market is the anchor tenant.
- Competitive rental rates.
- Prime space available with covered outdoor seating.

CBCWORLDWIDE.COM

Curtis Barlow
 760 899 7700
 cbarlow@cbclyle.net
 CalDRE #01380247



LYLE & ASSOCIATES, LP



HERITAGE COURT SHOPPING CENTER

44-100 Jefferson Street, Indio, CA 92201

LEASE



PROPERTY HIGHLIGHTS - SUITE D403

D403. Located adjacent to Monsoon Indian Cuisine, this 1,758 s.f. suite was formerly occupied by a postal/packing/shipping store. It features an open ceiling, concrete floor, one restroom, a small office, and is sprinklered. It has 200 amp electrical service, water and sewer. A 5-ton HVAC unit serves the suite.

\$2.25 PSF + NNN



CBCWORLDWIDE.COM

Curtis Barlow
760 899 7700
cbarlow@cbclyle.net
CalDRE #01380247

 **COLDWELL
BANKER
COMMERCIAL**
LYLE & ASSOCIATES, LP



HERITAGE COURT SHOPPING CENTER

44-100 Jefferson Street, Indio, CA 92201

LEASE

FLOORPLAN SUITE D403

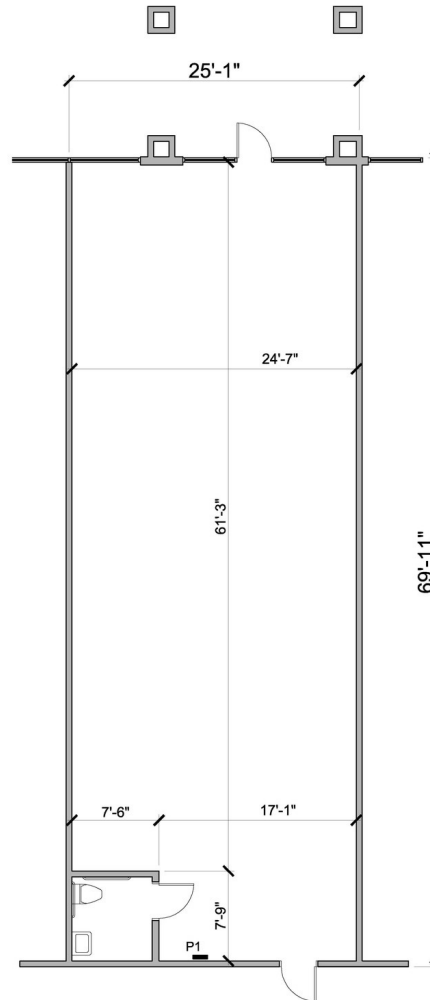

SUITE INFORMATION

SUITE AREA
1,758 SF

UTILITIES

ELECTRIC: PANEL LOCATED IN UNIT
P1: 200 AMP PANEL

HVAC: UNIT LOCATED ON ROOF
(1) 5-TON UNIT

GAS SERVICE: NO
WATER SERVICE: YES
SEWER SERVICE: YES
SPRINKLERED: YES

RESTROOMS
(1)

CEILING

15'-0" OPEN CEILING.
RESTROOM: 8'-0" HARD LID

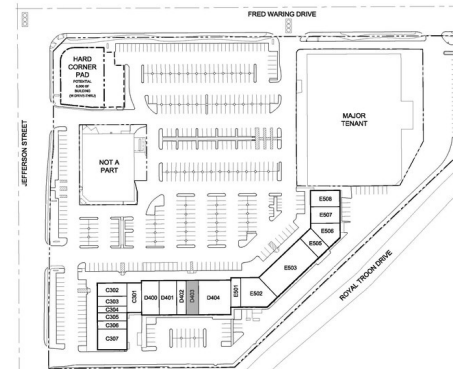

CBCWORLDWIDE.COM

Curtis Barlow
760 899 7700
cbarlow@cbclyle.net
CalDRE #01380247



LYLE & ASSOCIATES, LP



HERITAGE COURT SHOPPING CENTER

44-100 Jefferson Street, Indio, CA 92201

LEASE



CBCWORLDWIDE.COM

Curtis Barlow
760 899 7700
cbarlow@cbclyle.net
CalDRE #01380247



LYLE & ASSOCIATES, LP



HERITAGE COURT SHOPPING CENTER

44-100 Jefferson Street, Indio, CA 92201

LEASE

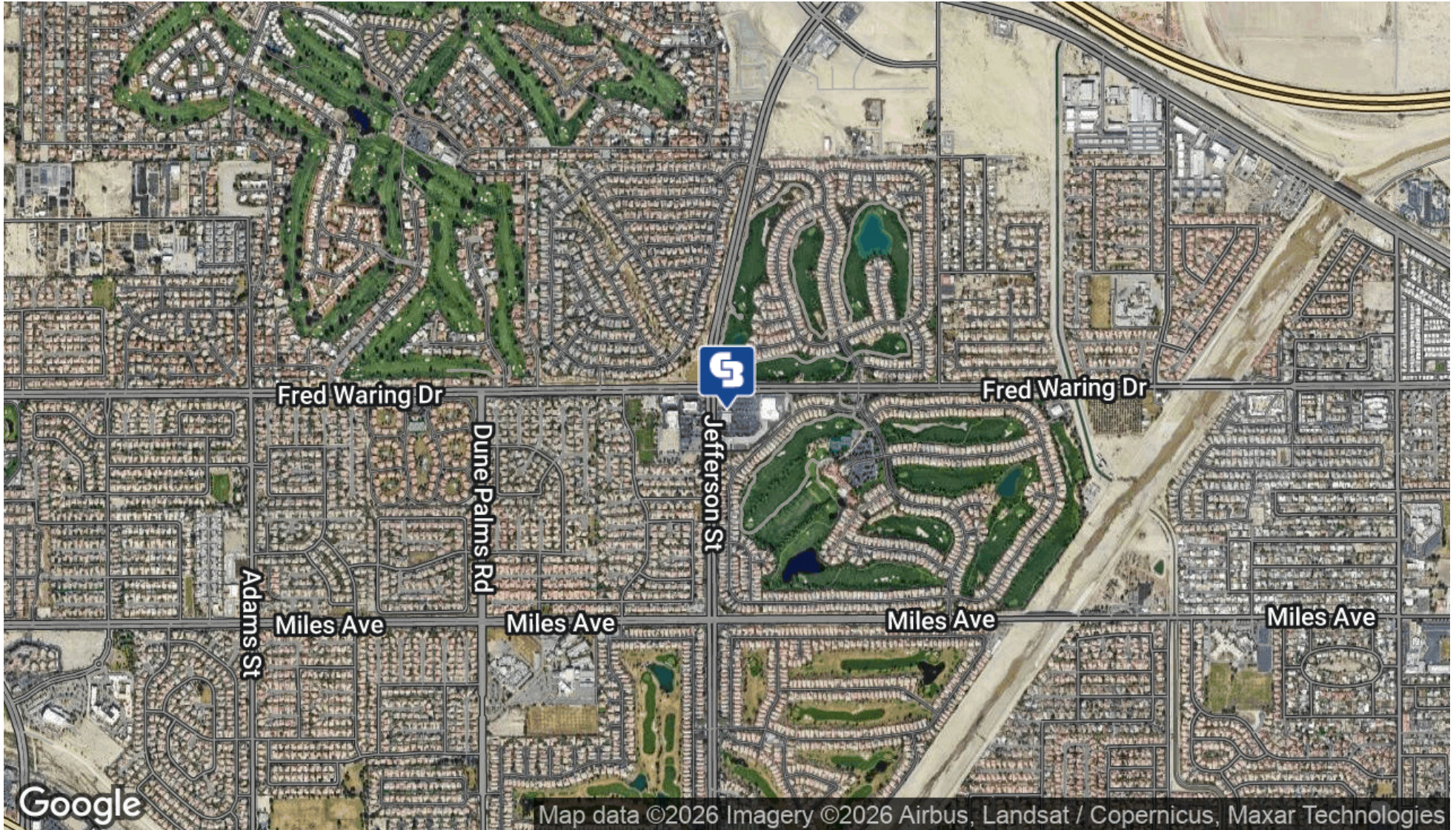

CBCWORLDWIDE.COM

Curtis Barlow
760 899 7700
cbarlow@cbclyle.net
CalDRE #01380247



LYLE & ASSOCIATES, LP



HERITAGE COURT SHOPPING CENTER

44-100 Jefferson Street, Indio, CA 92201

POPULATION	1 MILE	3 MILES	5 MILES
Total Population	9,182	78,574	147,973
Average age	44.5	36.4	37.8
Average age (Male)	40.8	35.5	37.2
Average age (Female)	45.8	36.9	38.1

HOUSEHOLDS & INCOME	1 MILE	3 MILES	5 MILES
Total households	3,460	27,565	52,749
# of persons per HH	2.7	2.9	2.8
Average HH income	\$96,040	\$78,165	\$80,102
Average house value	\$482,215	\$409,904	\$401,949

* Demographic data derived from 2020 ACS - US Census

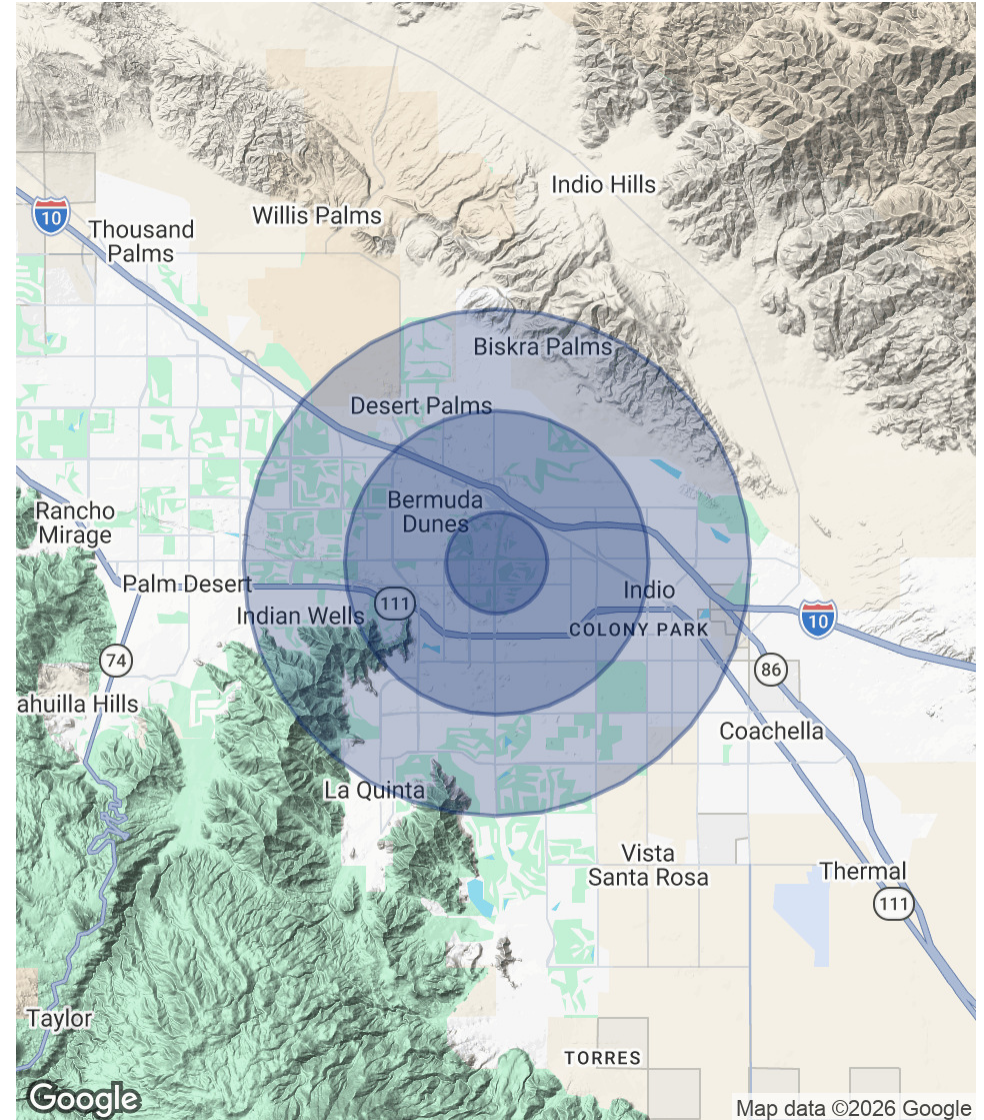

LEASE

CBCWORLDWIDE.COM

Curtis Barlow
760 899 7700
cbarlow@cbclyle.net
CalDRE #01380247



LYLE & ASSOCIATES, LP



HERITAGE COURT SHOPPING CENTER

44-100 Jefferson Street, Indio, CA 92201

LEASE



CURTIS BARLOW

Executive Vice President

Direct: 760.899.7700 **Cell:** 760.899.7700
cbarlow@cbclyle.net

CalDRE #01380247

CBCWORLDWIDE.COM

Curtis Barlow
760 899 7700
cbarlow@cbclyle.net
CalDRE #01380247

 **COLDWELL
BANKER
COMMERCIAL**
LYLE & ASSOCIATES, LP