

14701 YORBA

14701 YORBA AVE, CHINO, CA 91710

FOR LEASE | 458,262 SF

AVAILABLE Q4 2026



Exclusively Represented by:

PHIL LOMBARDO

+1 909 942 4678

phil.lombardo@cushwake.com

Lic. #00892477

CRUISE ADAMS

+1 909 942 4641

cruise.adams@cushwake.com

Lic. #02075368





PROPERTY FEATURES

 **±458,262 SF**
Freestanding Industrial Building

 **±5,290 SF**
Office

 **32'**
Minimum Clear Height

 **ESFR**
Sprinkler System with K-17 Sprinkler Heads

 **81**
Dock High Loading Doors (9'x10'), 47 with Interior Pit Levelers

 **4**
Grade Level Loading Doors (12'x14')

 **37**
Forklift Charging Outlets

 **7**
HVLS Fans

 **1,200**
Amps (277/480V)
Expandable

 **171' - 183'**
Secured Truck Court

 **52' x 50'**
Typical Column Spacing

 **Convenient Access**
to CA-71 & CA-60 Freeways

 **Parking**
174 Auto and
133 Trailer Stalls

 **Guard Shack**
with HVAC

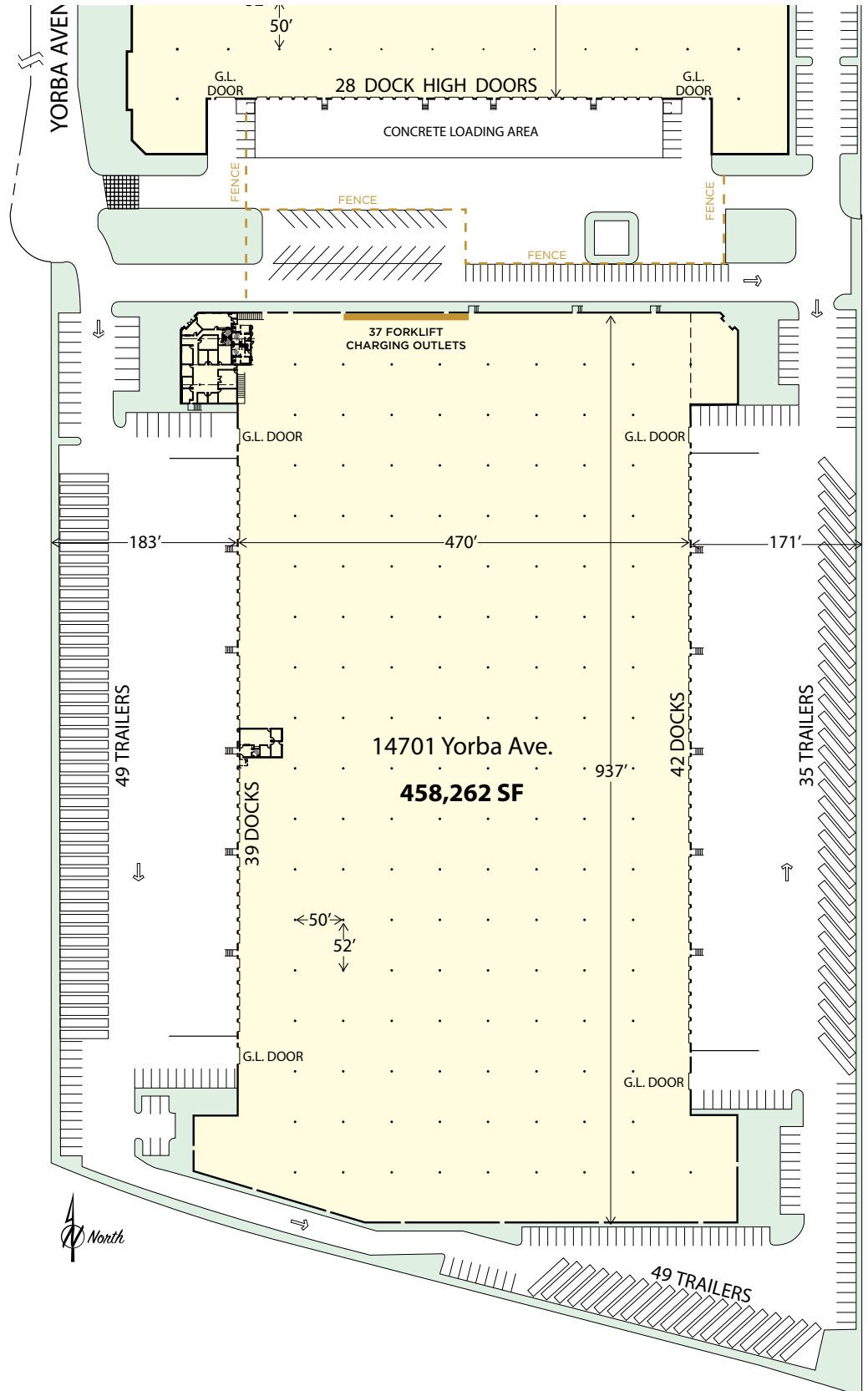

LOCATION

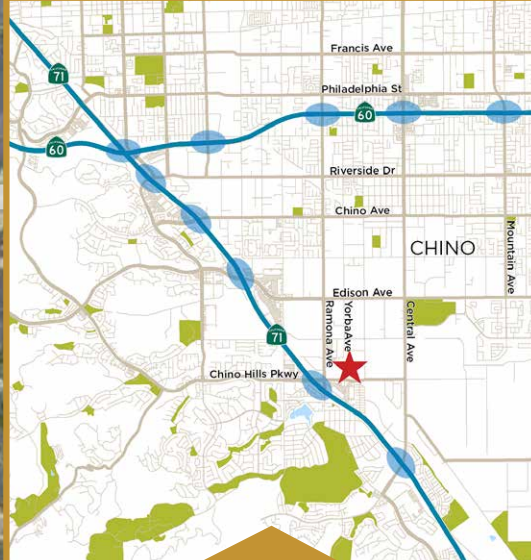
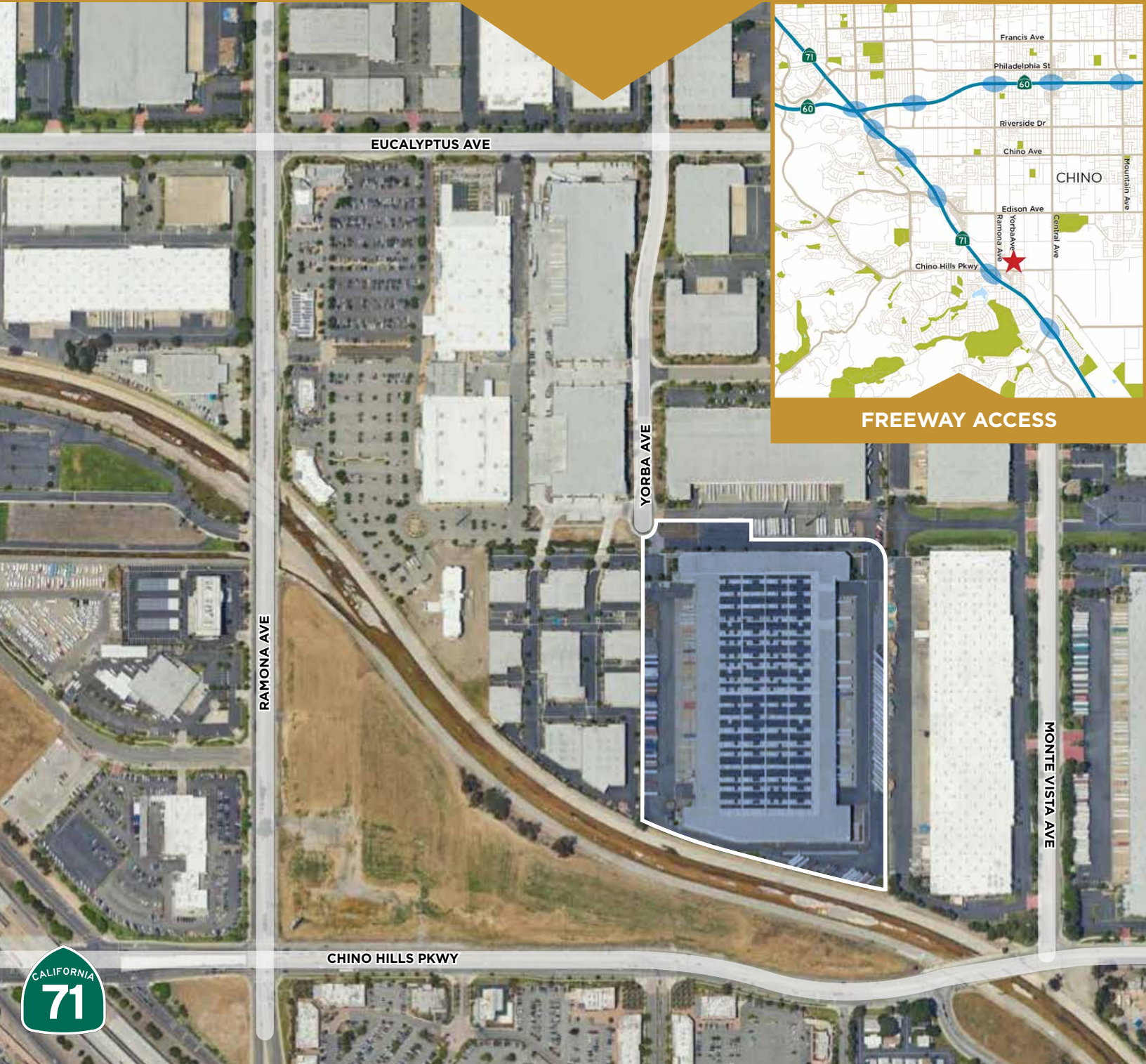

FREEWAY ACCESS



Exclusively Represented by:

PHIL LOMBARDO

+1 909 942 4678

phil.lombardo@cushwake.com

Lic. #00892477

CRUISE ADAMS

+1 909 942 4641

cruise.adams@cushwake.com

Lic. #02075368



901 Via Piemonte, Suite 200, Ontario, CA 91764
cushmanwakefield.com

©2026 Cushman & Wakefield. All rights reserved. The information contained in this communication is strictly confidential. This information has been obtained from sources believed to be reliable but has not been verified. NO WARRANTY OR REPRESENTATION, EXPRESS OR IMPLIED, IS MADE AS TO THE CONDITION OF THE PROPERTY (OR PROPERTIES) REFERENCED HEREIN OR AS TO THE ACCURACY OR COMPLETENESS OF THE INFORMATION CONTAINED HEREIN, AND SAME IS SUBMITTED SUBJECT TO ERRORS, OMISSIONS, CHANGE OF PRICE, RENTAL OR OTHER CONDITIONS, WITHDRAWAL WITHOUT NOTICE, AND TO ANY SPECIAL LISTING CONDITIONS IMPOSED BY THE PROPERTY OWNER(S). ANY PROJECTIONS, OPINIONS OR ESTIMATES ARE SUBJECT TO UNCERTAINTY AND DO NOT SIGNIFY CURRENT OR FUTURE PROPERTY PERFORMANCE.