

BLDG 3

7TH FLOOR, SUITE 704 – 5,200 SF

POSSESSION: IMMEDIATE



SUITE 704



BLDG 3 LOCATION

UNIT HIGHLIGHTS

- Easy access to freight elevator
- Slab-to-slab height: 10'+
- Newly white-boxed space
- 100 amps
- Live Load 250 lbs / SF
- New bathrooms on floor

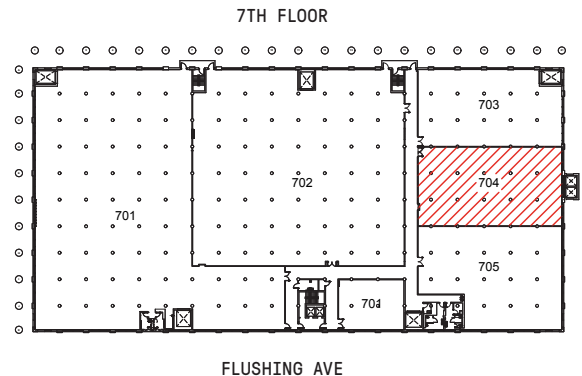
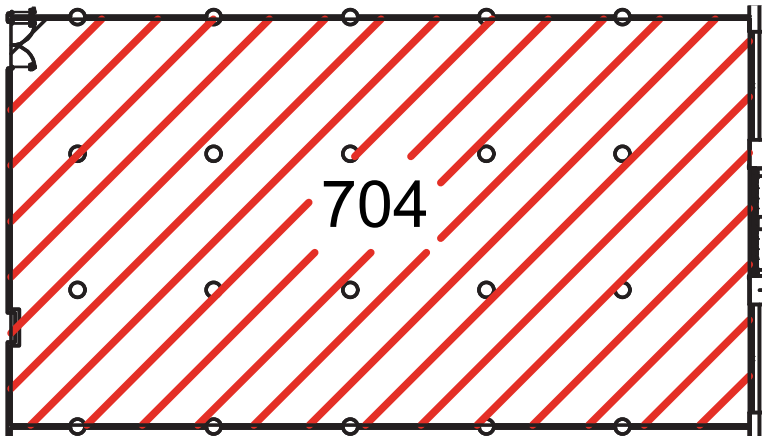

BROOKLYN | **NAVY** | **YARD**

141 FLUSHING AVENUE
BROOKLYN, NY 11205

JOSEPH COLISTA

VP, Leasing
jcolista@bnydc.org
929-337-1205