

FLORILAND OFFICE CENTER

 9309 North Florida Avenue
Tampa, FL 33612

"Plug & Play" Office Sublease Available

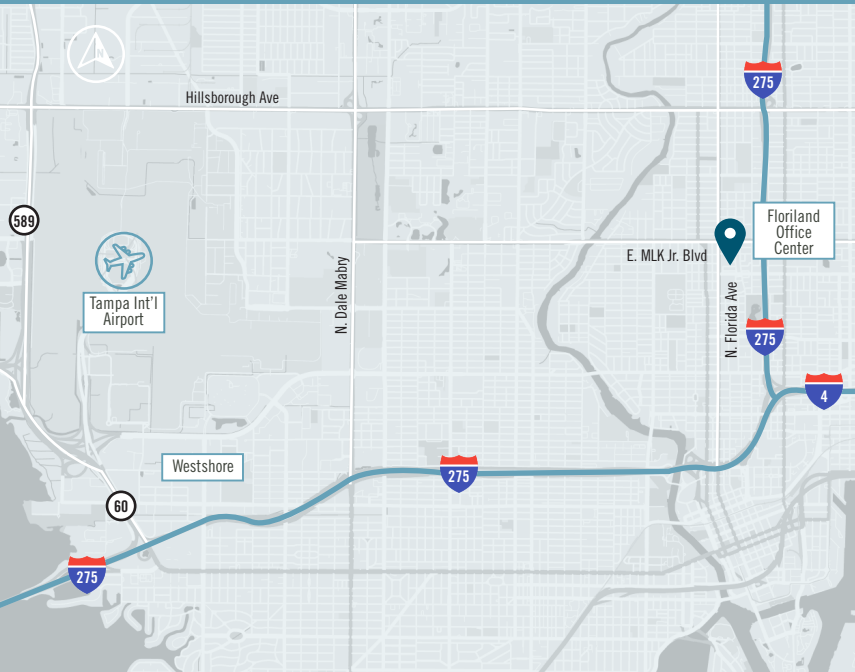

PROPERTY HIGHLIGHTS

- **22,419 - 122,648 SF AVAILABLE**
- Sublease Expires: 6/30/2028
- "Plug & Play" Office Sublease Available
- TI Allowance Available
- Move-in ready headquarters and call center space
- Ideally located at a signalized intersection with easy access to/from the Interstate
- Prominent signage along I-275 with outstanding visibility (over 129,500 AADT)
- Central location
- Located near the University of South Florida with a student population in excess of 51,000 +/- students
- Over 900 parking spaces available



CHAD RUPP
Managing Director

☎ 813.345.5891
✉ Chad.Rupp@FranklinSt.com

MATT ALEXANDER
Director

☎ 813.559.2006
✉ Matthew.Alexander@FranklinSt.com

 **FranklinStreet**

LICENSED REAL ESTATE BROKER | FranklinSt.com

FLORILAND OFFICE CENTER

9309 North Florida Avenue | Tampa, FL 33612

HIGHLIGHTS

Class	B
Year Built	1972; Renovated 2006
Floors	1
Submarket	Northwest Tampa
Parking	Over 900 parking spaces available

Amenities

Atrium, Conferencing Facility, Food Court,
& Monument and Building Signage

FLOOR 1: 22,419 - 122,648 SF

- 22,419 SF
- 45,291 SF
- 54,938 SF

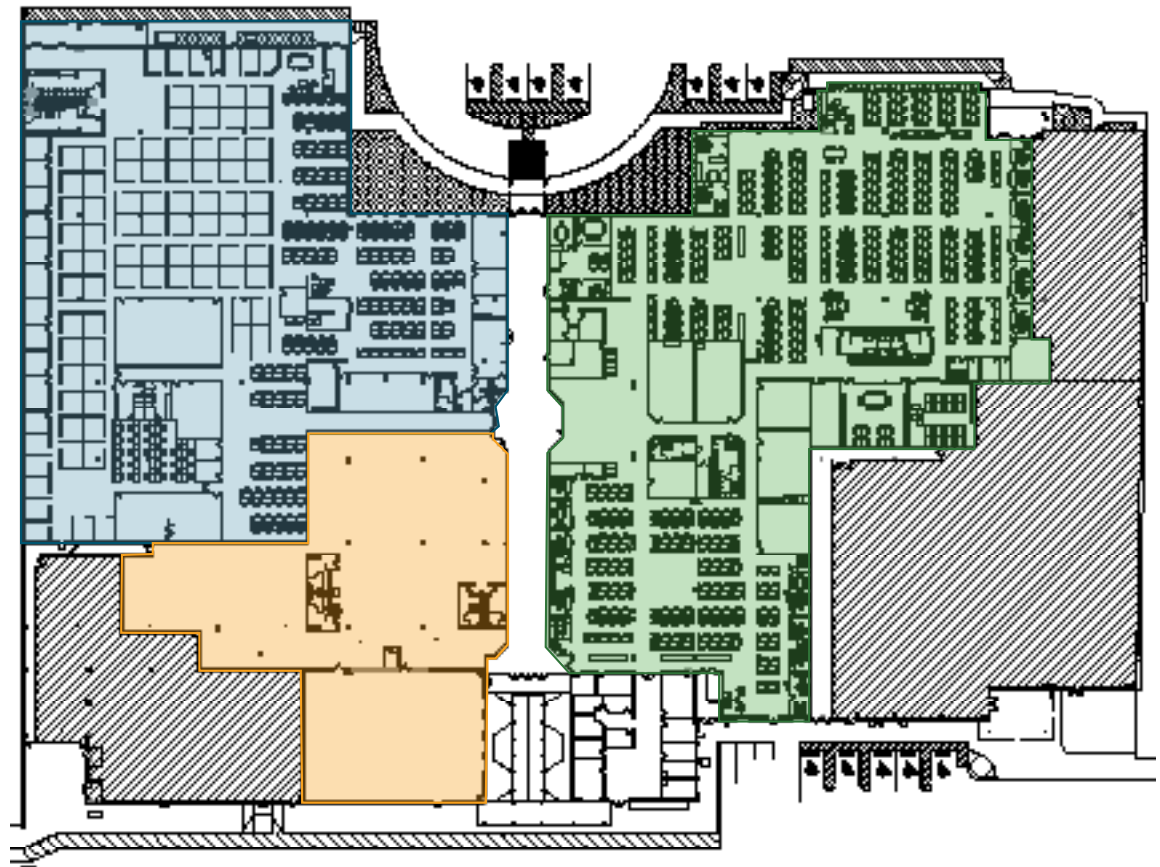

CHAD RUPP

Managing Director

☎ 813.345.5891

✉ Chad.Rupp@FranklinSt.com

MATT ALEXANDER

Director

☎ 813.559.2006

✉ Matthew.Alexander@FranklinSt.com



LICENSED REAL ESTATE BROKER | FranklinSt.com

FLORILAND OFFICE CENTER

9309 North Florida Avenue | Tampa, FL 33612

OFFICE FOR SUBLEASE

