

CBRE

FOR SUBLEASE

199 BAY STREET

\$55

GROSS PSF

\$3.00

**PER SF/YEAR
CO-OP COMMISSION**

BYRON AHMET*

Executive Vice President
416 815 2354
byron.ahmet@cbre.com

ELAINE JENKINS**

Vice President
416 815 2322
elaine.jenkins@cbre.com

***Broker **Sales Representative**

SUBLISTING DETAILS

15		
14		
12		
11		
10		
09		
08		
07		
06	22,296 SF	
05		
04		
03		
02		
01		

AVAILABLE SPACES

6th Floor 22,296 SF

Available - Call for Details

OCCUPANCY

Immediately

EXPIRY

November 29, 2033

GROSS ASKING RENT

\$55 Gross PSF

SUITE PHOTOS



6TH FLOOR

22,296 SF

- 31 desks
- 1 – 22 person boardroom
- 1 – 20 person boardroom
- Reception
- Copy area
- 6 – 10 person meeting room
- 3 – 8 person meeting room
- 3 Training Room
- 4 Offices
- 4 Phone Rooms

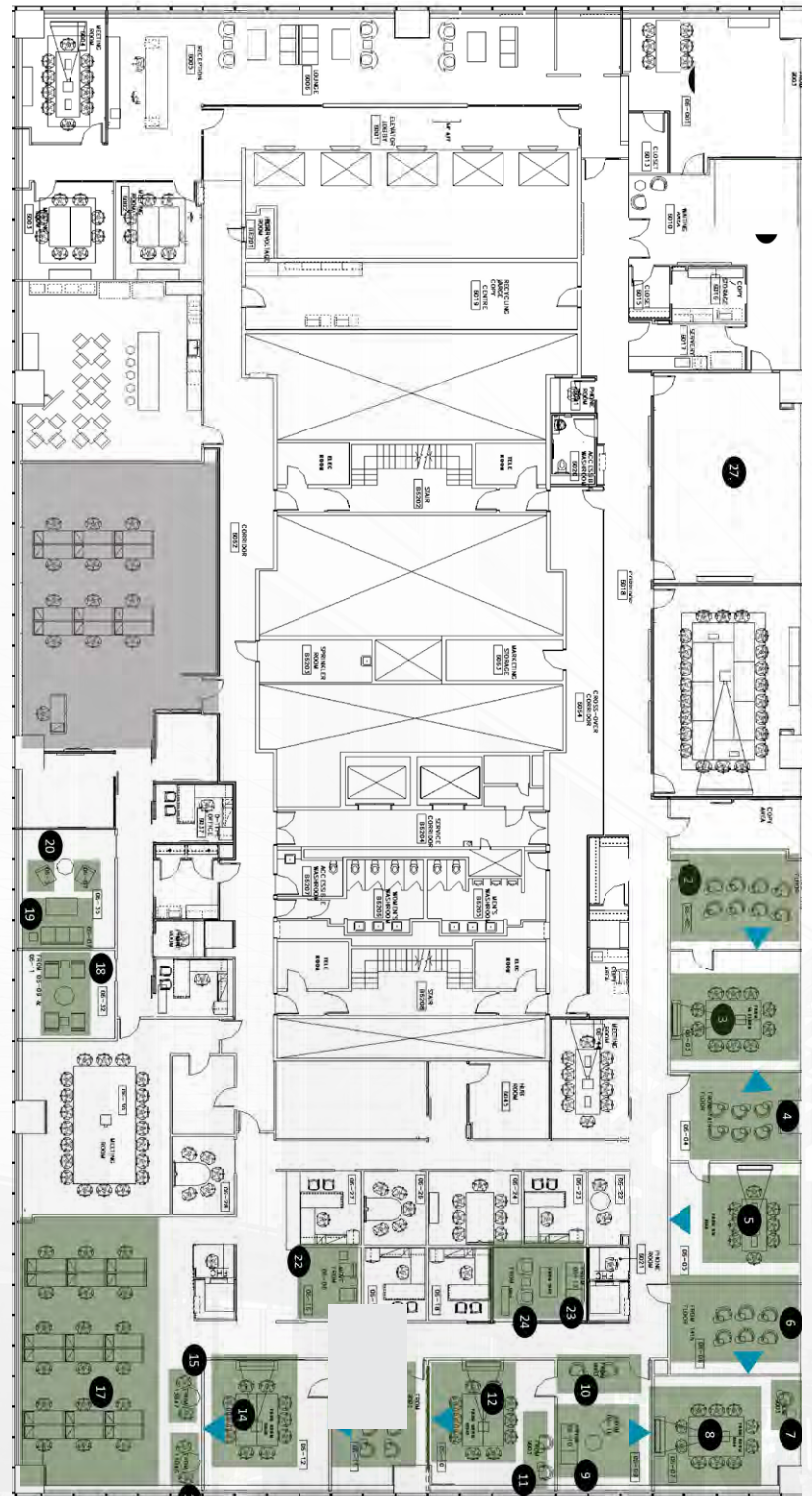

CONCEPTUAL PLAN

For Illustrative Purposes

- 155 Total Work Seats
- 54 Dedicated Work Seats
- 96 Bench Desks
- 5 Bookable Offices
- 63 Meeting Seats
- 24 Breakout Collab
- 4 Focus Room Seats
- 20 Lunch Room Seats

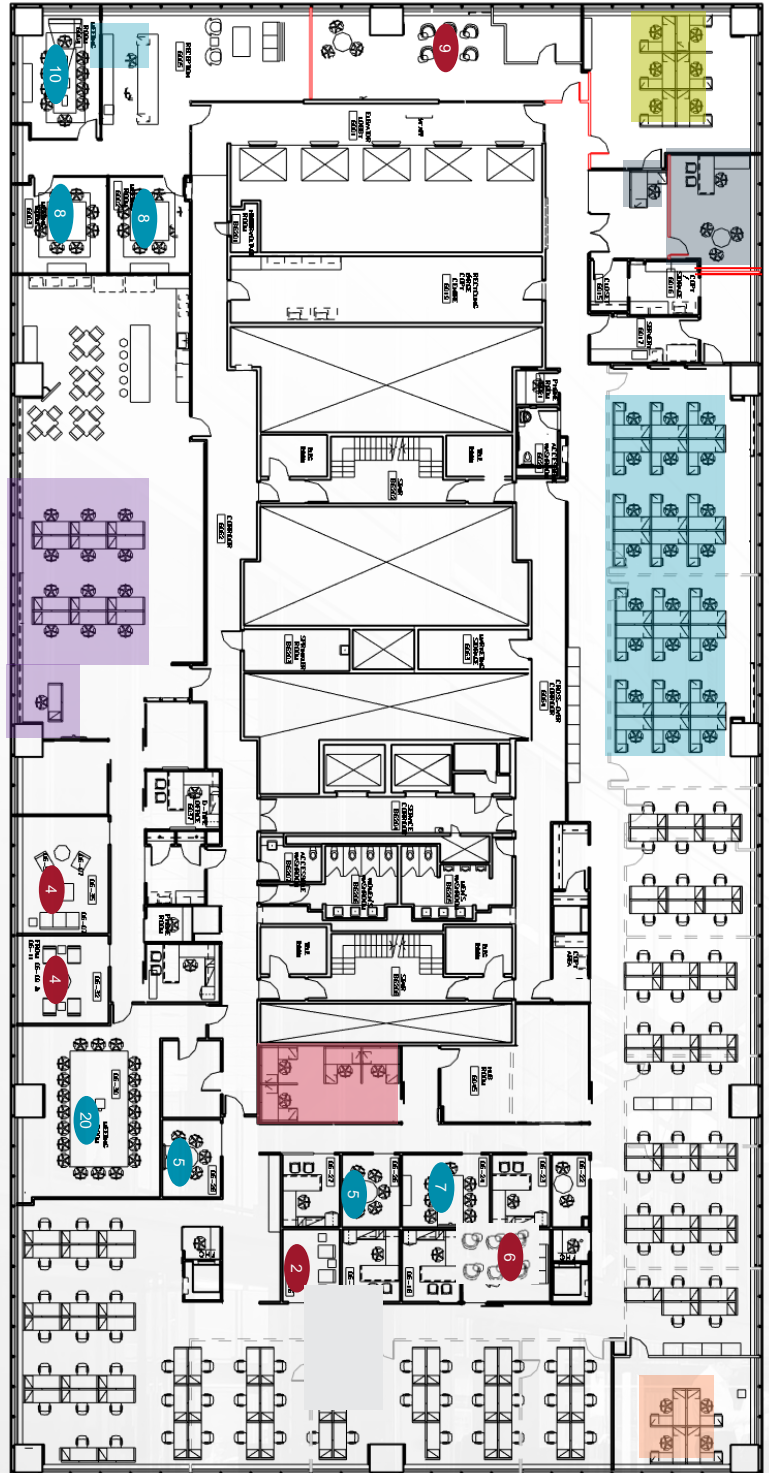

PROPERTY PHOTOS



MAP OF THE AREA

FOOD & DRINKS

1. Terroni
2. Cantina Mercatto
3. The Old Spaghetti Factory
4. Eggspectation
5. Sunset Grill
6. CRAFT Beer Market
7. Walrus Pub & Beer Hall
8. Cactus Club
9. Hy's Steakhouse

ENTERTAINMENT

10. Canadian Opera Company
11. Rogers Centre
12. CN Tower
13. Scotiabank Arena

SHOPPING

14. Shoppers Drug Mart
15. CF Toronto Eaton Centre
16. Hudson's Bay
17. Saks Fifth Avenue
18. Rexall

GROCERIES

19. Metro
20. The Market by Longo's
21. Rabba Fine Foods

HOSPITALS

22. Toronto General
23. Princess Margaret
24. Mt. Sinai
25. Sick Kids
26. St. Michaels

FITNESS CENTRES

27. Goodlife Fitness
28. Adelaide Club
29. Equinox
30. F45 Downtown

SCHOOLS

31. The University of Toronto Oral and Maxillofacial Surgery
32. Toronto Metropolitan University Ted Rogers School of Management

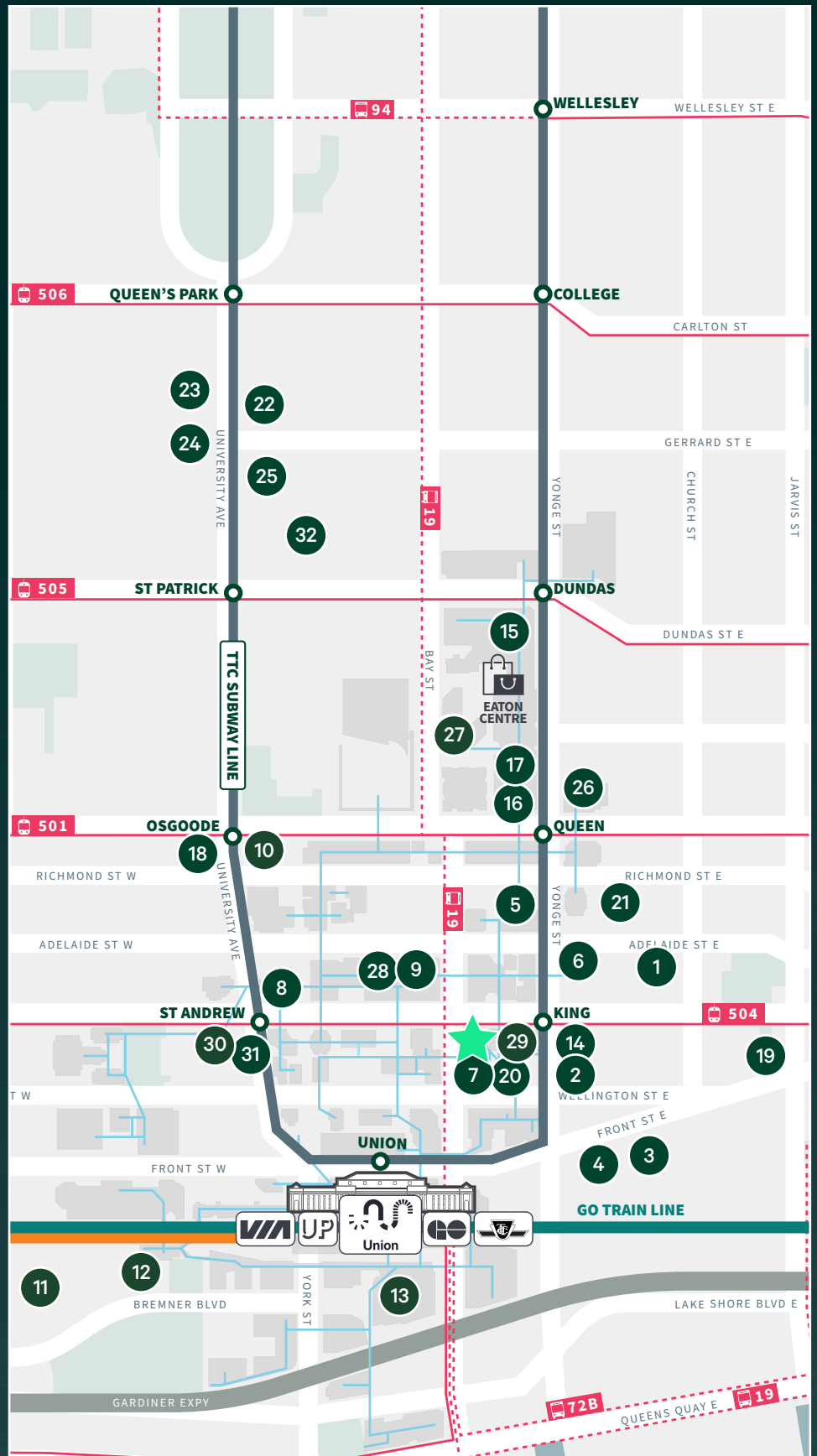



CBRE

BYRON AHMET*
Executive Vice President
416 815 2354
byron.ahmet@cbre.com

ELAINE JENKINS**
Vice President
416 815 2322
elaine.jenkins@cbre.com

***Broker **Sales Representative**

This disclaimer shall apply to CBRE Limited, Real Estate Brokerage, and to all other divisions of the Corporation; to include all employees and independent contractors ("CBRE"). The information set out herein, including, without limitation, any projections, images, opinions, assumptions and estimates obtained from third parties (the "Information") has not been verified by CBRE, and CBRE does not represent, warrant or guarantee the accuracy, correctness and completeness of the Information. CBRE does not accept or assume any responsibility or liability, direct or consequential, for the Information or the recipient's reliance upon the Information. The recipient of the Information should take such steps as the recipient may deem necessary to verify the Information prior to placing any reliance upon the Information. The Information may change and any property described in the Information may be withdrawn from the market at any time without notice or obligation to the recipient from CBRE. CBRE and the CBRE logo are the service marks of CBRE Limited and/or its affiliated or related companies in other countries. All other marks displayed on this document are the property of their respective owners. All Rights Reserved.