

HOWARD COMMONS

6201 W. HOWARD ST., STE. 210
NILES, ILLINOIS

FOR LEASE



1,827 SF OFFICE

BUILDING HIGHLIGHTS

- MODERN GLASS 2-STORY OFFICE BUILDING
- 24-HOUR ACCESS
- PASSENGER ELEVATOR
- 100% SPRINKLERED
- PROPERTY MANAGER ON-SITE
- EASY ACCESS TO I-94 VIA TOUHY
- AMPLE OFF-STREET PARKING (DEDICATED SPOTS AVAILABLE)
- IMMEDIATE ACCESS TO PACE BUS & CLOSE PROXIMITY TO TRAIN

SUITE HIGHLIGHTS

- 3 PRIVATE OFFICES
- OPEN AREA FOR MEETINGS & WORKSTATIONS
- KITCHENETTE
- PRIVATE BATHROOM
- GAS & ELECTRIC SEPARATELY METERED & CONTROLLED

CONTACT: HARLEY KAHN
847.676.0030
HARLEY@KAHNCO.NET



REA COMMERCIAL REAL ESTATE LLC

Information is provided by other sources and are deemed reliable. Information has not been verified. No representation, warranty or guarantee, expressed or implied or by operation of law is made as to the accuracy, reliability or completeness of this information. This material is submitted subject to errors, omissions, changes prior leasing or sales or withdrawal without notice.

HOWARD COMMONS

6201 W. HOWARD ST., STE. 210
NILES, ILLINOIS

FLOOR PLAN

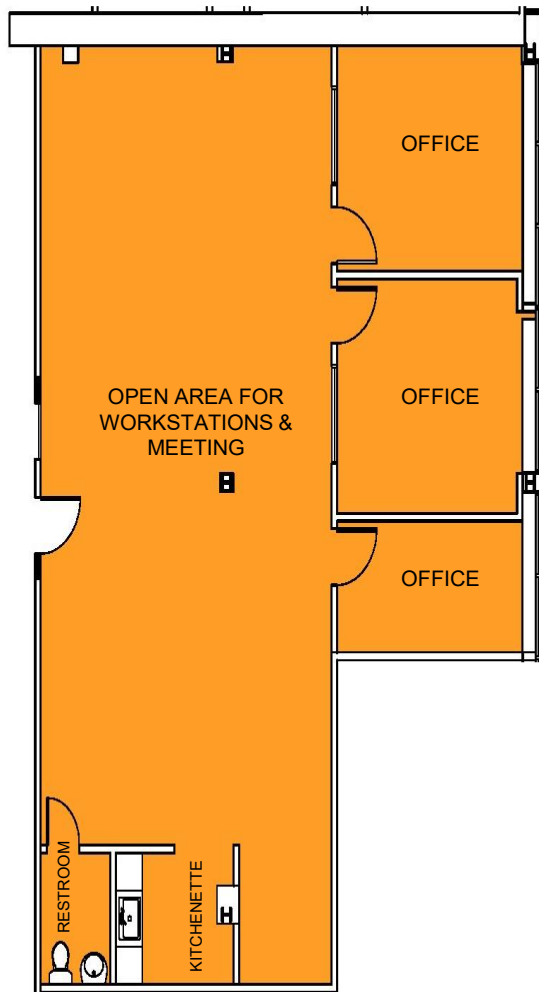

SUITE 210 - 1,827 RSF



SECOND FLOOR

**PLEASE CONTACT:
HARLEY KAHN**

REA COMMERCIAL REAL ESTATE LLC 847.676.0030 HARLEY@KAHNCO.NET

Information is provided by other sources and are deemed reliable. Information has not been verified. No representation, warranty or guarantee, expressed or implied or by operation of law is made as to the accuracy, reliability or completeness of this information. This material is submitted subject to errors, omissions, changes prior leasing or sales or withdrawal without notice.