



# 152 Ninth Avenue, Retail

(Between West 20<sup>th</sup> Street & West 19<sup>th</sup> Street)

As Exclusive Agents, We Are  
Pleased To Offer The Following:

Retail Space For Lease

 **Douglas Elliman**  
Commercial

575 MADISON AVENUE, NEW YORK, NEW YORK 10022

# 152 Ninth Avenue, Retail

---

152 Ninth Avenue offers a clean space for lease located in prime the Chelsea neighborhood adjacent to the Highline/West Chelsea & Meatpacking District submarkets.

Location	East side between West 20 <sup>th</sup> Street and West 19 <sup>th</sup> Street
Space	Ground Level - 1,400 RSF Lower Level - 1,300 RSF
Frontage	Approx. 18 feet
Rental	Upon Request
Possession	Immediate
Landmark	No
Features	Glass Storefront with Double Door Entry Open Showroom Generous Natural Light Finished Lower Level including Bathroom Sidewalk Access to Lower Level for Efficient Load-In/Load-Out All uses considered without venting



# 152 Ninth Avenue, Retail

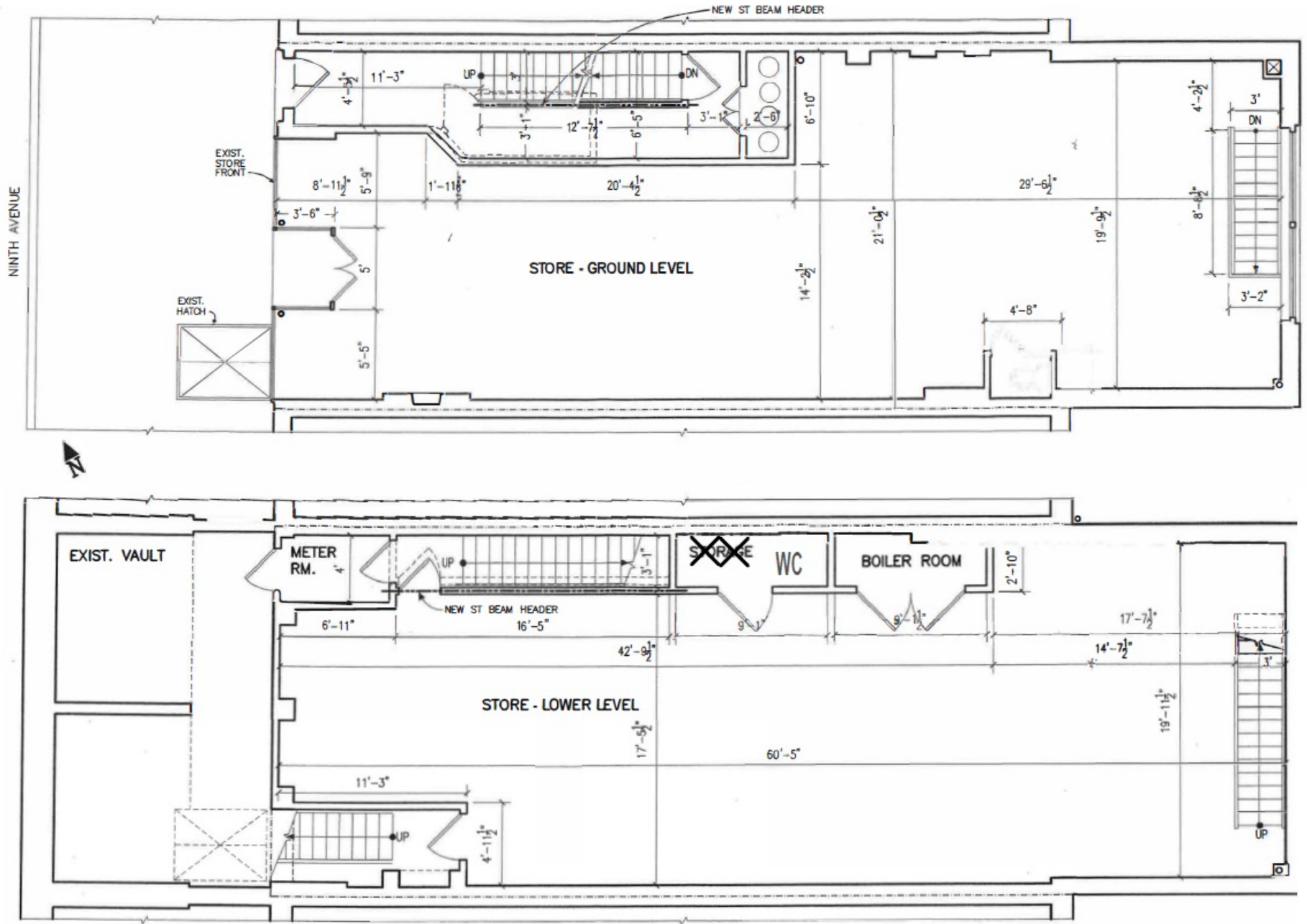

# 152 Ninth Avenue, Retail

NEIGHBORHOOD HIGHLIGHTS ATTRACTING MILLIONS OF LOCALS AND TOURISTS



Hudson River Park / Little Island



Chelsea Highline



Chelsea Market



Meatpacking District



For further information and inspection, please contact:

Louis Puopolo  
Licensed Associate Real Estate Broker  
917 374-0099  
[louis.puopolo@elliman.com](mailto:louis.puopolo@elliman.com)



©2025 DOUGLAS ELLIMAN COMMERCIAL, LLC. ALL RIGHTS RESERVED. THE INFORMATION CONTAINED IN THIS DOCUMENT IS PROPRIETARY TO DOUGLAS ELLIMAN COMMERCIAL, LLC AND SHALL BE USED SOLELY FOR THE PURPOSES OF EVALUATING THIS PROPOSAL. ALL SUCH DOCUMENTATION AND INFORMATION REMAINS THE PROPERTY OF DOUGLAS ELLIMAN COMMERCIAL, LLC AND SHALL BE KEPT CONFIDENTIAL. REPRODUCTION OF ANY PART OF THIS DOCUMENT IS AUTHORIZED ONLY TO THE EXTENT NECESSARY FOR ITS EVALUATION. IT IS NOT TO BE SHOWN TO ANY THIRD PARTY WITHOUT THE PRIOR WRITTEN AUTHORIZATION OF DOUGLAS ELLIMAN COMMERCIAL, LLC. ALL INFORMATION CONTAINED HEREIN IS FROM SOURCES DEEMED RELIABLE; HOWEVER, NO REPRESENTATION OR WARRANTY IS MADE AS TO THE ACCURACY THEREOF.