

# MRC

For Lease



# 23 W 116th St

Prime Retail Space For Lease

2,400 sq ft | 23 W 116th St | New York, NY 10026



# FLOOR PLAN

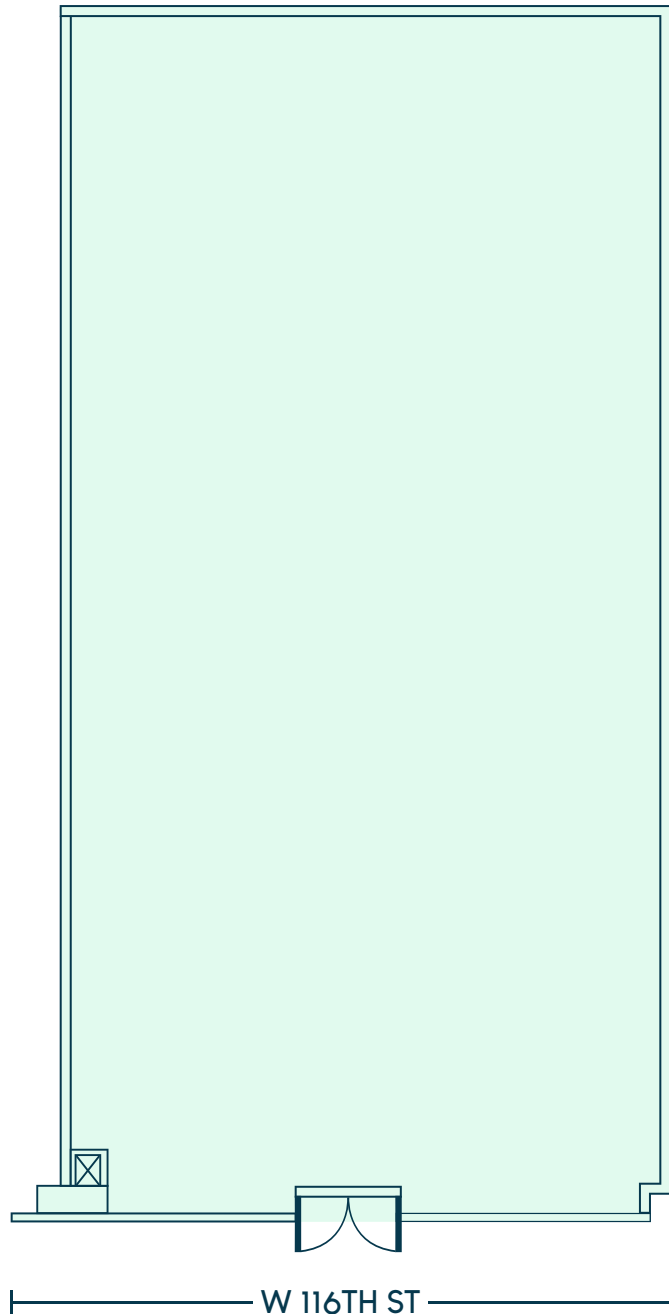

## OVERVIEW

- **Address:** 23 W 116th St, New York, NY 10026
- **Cross Streets:** Lenox Ave and 5th Ave
- **Neighborhood:** Harlem

## SPACE DETAILS

- **Size:** 2,400 sq ft
- **Ceiling Height:** 12 ft
- **Frontage:** 33 ft

## HIGHLIGHTS

- Multiple high-frequency transit options
- Glass Storefront
- Next door to Puregym
- HVAC

## TRANSPORTATION

- 🚗 3 min walk to M7, M102
- 🚆 2 min walk to train 2, 3
- 📍 15 min drive to LGA, 28 min drive to JFK, 31 min drive to EWR

## DEMOGRAPHICS

- **Population:** 208,898
- **Median Household Income:** \$45,729
- **Median Home Value:** \$1,235,000

## NEIGHBORS

Dunkin Donuts, Baskin-Robbins, Popeyes, PureGym, The UPS Store, CVS Pharmacy, Fit Theorem, Smile Space, Harlem Pilates, Harlem Children's Zone, MoneyGram, Carver Bank

# MRG

# 23 W 116th St New York, NY 10026

FOR MORE INFORMATION  
PLEASE CONTACT:

**ELY AKIVA**

212-314-4684 Ext. 105  
Ely@mrgny.com

**MOSHE AKIVA**

212-314-4684 Ext. 103  
Moshe@mrgny.com

