

580 THIRD STREET BUSINESS PARK

580 THIRD STREET, LAKE ELSINORE, CALIFORNIA 92530

FOR LEASE
+/- 1,500 SF
INDUSTRIAL SPACE



FOR MORE INFORMATION, PLEASE CONTACT:

CAREY PASTOR | Senior Vice President

(951) 297-7434 | cpastor@cbsocalgroup.com

CalDRE License # 01403298



COLDWELL BANKER
COMMERCIAL
SC

580 THIRD STREET BUSINESS PARK

580 THIRD STREET, LAKE ELSINORE, CALIFORNIA 92530

FOR LEASE
+/- 1,500 SF
INDUSTRIAL SPACE

PROPERTY HIGHLIGHTS

- Small industrial spaces for lease
- Reception area, 1 private office, balance of space is warehouse with front loading roll up door
- M-1 zoning – City of Lake Elsinore
- Close proximity to I-15 free via Central Avenue, on/off ramp
- Located near a number of new retail and restaurants including: Lowe's, The Home Depot, Costco, Chili's Wendy's, Panda Express, Target, Marshalls, Panera, and more



580 THIRD STREET BUSINESS PARK

580 THIRD STREET, LAKE ELSINORE, CALIFORNIA 92530

FOR LEASE
 +/- 1,500 SF
INDUSTRIAL SPACE

AVAILABILITY

UNIT	UNIT SIZE	MONTHLY RENTAL RATE	DESCRIPTION
K	±1,500 SF	\$1,455.00 Base Rent + \$945.00 CAOE* Per month	Reception area, 1 restroom, warehouse with roll up door.

* 2026 Common Area Operating Expenses (CAOE) are estimated and subject to annual reconciliation and adjustment

SITE PLAN

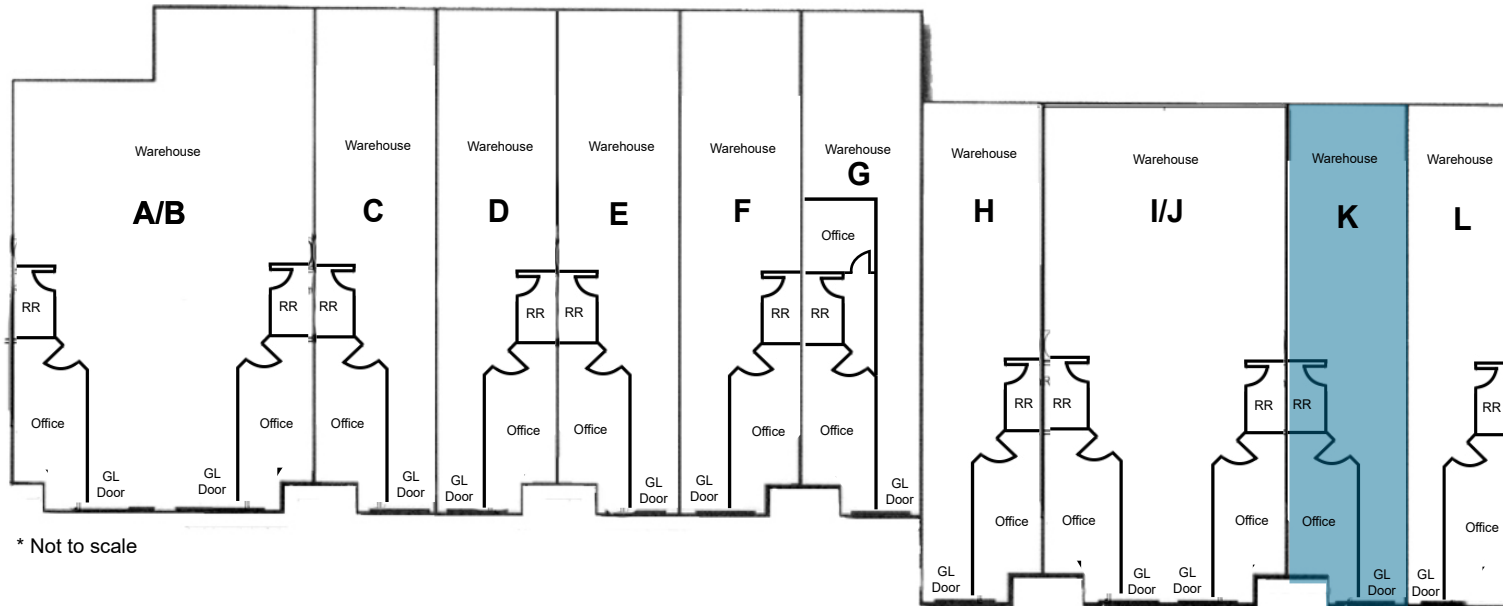

* Not to scale

Typical Floor Plan

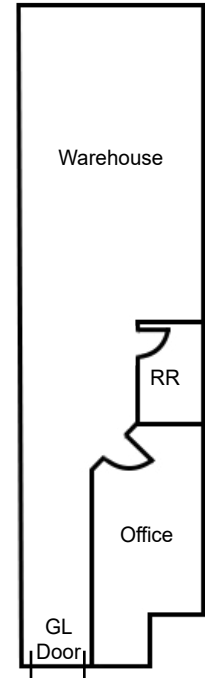

* Not to scale

580 THIRD STREET BUSINESS PARK

580 THIRD STREET, LAKE ELSINORE, CALIFORNIA 92530

FOR LEASE
+/- 1,500 SF
INDUSTRIAL SPACE



Coldwell Banker Commercial and the Coldwell Banker Commercial Logo are registered service marks licensed to Coldwell Banker Commercial Affiliates. Each Office is Independently Owned and Operated. All information contained herein has been obtained from sources deemed reliable. However, no warranty or guarantee is made as to the accuracy of the information.

CalDRE License # 02089395

580 THIRD STREET BUSINESS PARK

580 THIRD STREET, LAKE ELSINORE, CALIFORNIA 92530

FOR LEASE
+/- 1,500 SF
INDUSTRIAL SPACE



FOR MORE INFORMATION, PLEASE CONTACT:

CAREY PASTOR

Senior Vice President

951.297.7434

cpastor@cbcsocalgroup.com

CalDRE # 01403298

27368 Via Industria | Suite 102
Temecula | California | 92590
t 951.200.7683 | f 951.239.3147
cbcsocalgroup.com



COLDWELL BANKER
COMMERCIAL
SC