



47602-47682 KATO ROAD

[www.fremontdistributionpark.com](http://www.fremontdistributionpark.com)

# 47602 KATO ROAD | BUILDING A

47602

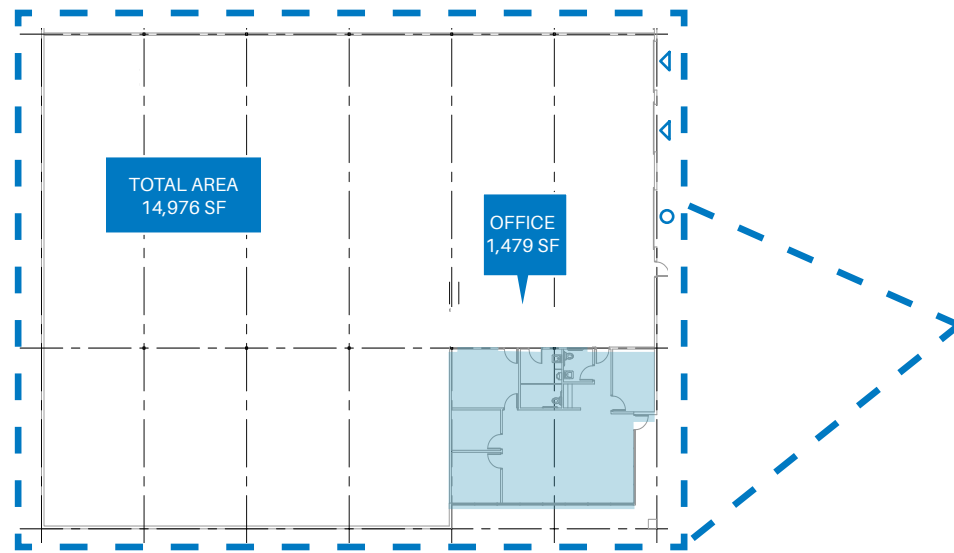

- ◀ Dock
- Grade

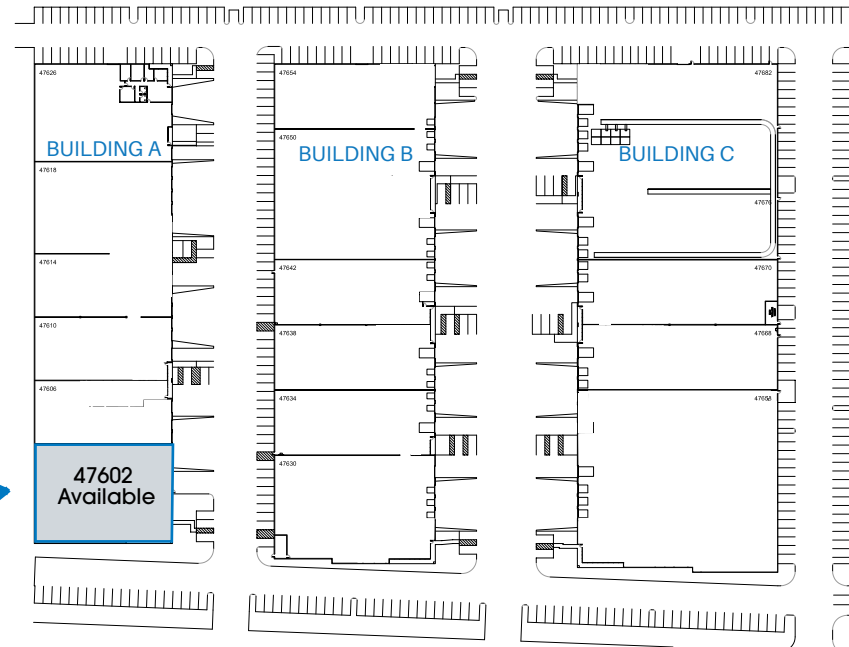

## PROPERTY DETAILS

- ±14,976 SF AVAILABLE
- ±1,479 SF OFFICE
- SIGNAGE POSSIBLE
- FREEWAY VISIBILITY
- CORNER UNIT WITH HIGH IMAGE GLASS FRONTAGE
- EXCELLENT ACCESS TO I-880 AND I-680
- LOADING: 2 DOCK HIGH, 1 GRADE LEVEL DOOR
- PARKING: 1:1,000 RSF
- POWER: 200 AMP 277/480VOLT
- FULLY SPRINKLERED: .33 GPM/ 3000 SF
- LARGE TRUCK COURT
- DIRECT LEASE WITH QUALITY INSTITUTIONAL OWNERSHIP
- CALL BROKER FOR PRICING (\$0.26 OPEX)

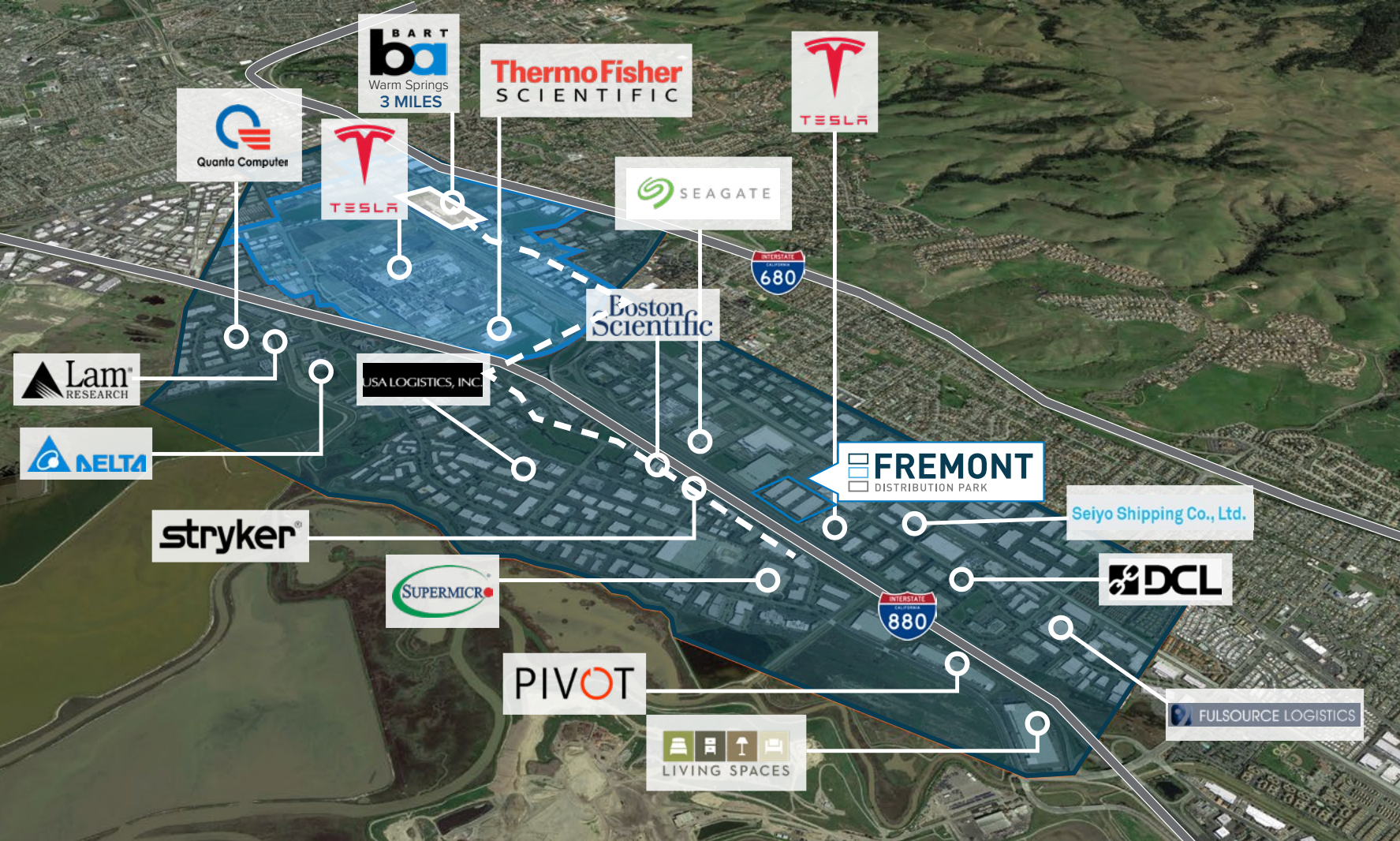

## KEY

 Fremont Innovation District

 Warm Springs Project Area

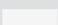
 Warm Spring BART

# EXCELLENT **FREMONT** LOCATION

JASON OVADIA  
 + 1 510 285 5360  
 RE License #: 01742912  
 jason.ovadia@jll.com

PATRICK METZGER  
 + 1 510 285 5362  
 RE License #: 01888895  
 patrickj.metzger@jll.com

DAVID SESI  
 +1 650 480 2136  
 RE License #: 01981744  
 david.sesi@jll.com

\*New York Life Real Estate Investors is a division of NYL Investors, an indirect, wholly owned subsidiary of New York Life Insurance Company.  
 ©2024 Jones Lang LaSalle IP, Inc. All rights reserved. All information contained herein is from sources deemed reliable; however, no representation or warranty is made to the accuracy thereof. Jones Lang LaSalle Brokerage, Inc. Real Estate License #: 01856260

