

INDUSTRIAL SPACE FOR LEASE

2360 Eastman Ave, Unit 103, Oxnard, CA



INDUSTRIAL SPACE AVAILABLE FOR LEASE

For More Information
Please Contact:

GRANT HARRIS

805.626.1212
gharris@lee-re.com
Lic # 01029619

JOHN OCHOA, SIOR

805.626.1208
jochoa@lee-re.com
www.johnchoa-re.com
Lic # 00986604



COMMERCIAL REAL ESTATE SERVICES

Lee & Associates - LA North/Ventura, Inc.
Corporate ID #01191898
A Member of the Lee & Associates
Group of Companies
2775 N Ventura Road, Suite 201
Oxnard, CA 93036
www.lee-associates.com

No warranty or representation is made to the accuracy of the foregoing information. Terms of sale or lease and availability are subject to change or withdrawal without notice.

PROPERTY HIGHLIGHTS

- Rare Size Industrial Space/Units from 1,000 SF
- Well Maintained Multi-Tenant Industrial Building
- M-1 Zoned | Multiple Uses
- 1 Block Off Rice Avenue

PROPERTY SPECIFICATIONS

AVAILABLE SF	1,000 SF
TOTAL SF	1,000 SF
OFFICE SF	140 SF
LOADING	(1) GL (10'w x 12'h)
CLEAR HEIGHT.....	15.5 Feet
POWER	200 Amps 120/208
PARKING	2 Spaces
YEAR BUILT	2004
ZONING.....	M1
LEASE RATE*	\$1.45/SF MG

*\$140.00 (\$0.14 per square foot) monthly Common Area Maintenance (CAM) fee in addition to lease rate.

Tenant to verify all information.

INDUTRIAL SPACE FOR LEASE

2360 Eastman Ave, Unit 103, Oxnard, CA

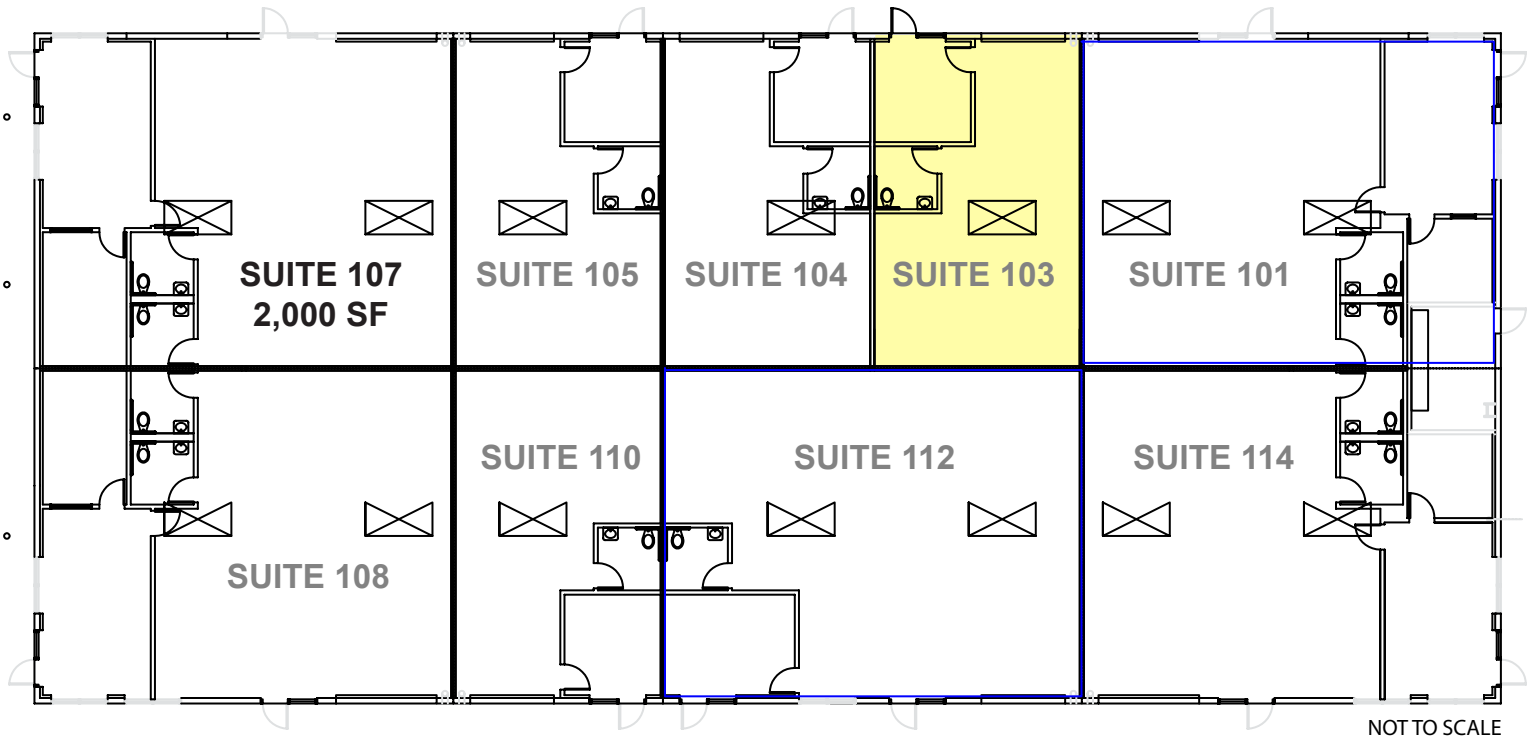

Tenant to verify all information.



LEE & ASSOCIATES
COMMERCIAL REAL ESTATE SERVICES

GRANT HARRIS
805.626.1212
gharris@lee-re.com
www.gharris-re.com
Lic # 01029619

JOHN OCHOA, SIOR
805.626.1208
jochoa@lee-re.com
www.johnchoa-re.com
Lic # 00986604

No warranty or representation is made to the accuracy of the foregoing information. Terms of sale or lease and availability are subject to change or withdrawal without notice.