

For Lease

3,523 SF
Office Space



Beacon I | Suite 101

44 Abele Road, Bridgeville, PA 15017

Property Features

Beacon I is a solar-powered, Class A office building situated on top of the hill inside Abele Business Park. Beacon I is ideal for companies looking to upgrade their office to attract and retain employees and clients.

- Dedicated Client Experience Team
- Exclusive Access to Partner Perks Program
- High-End Suites
- Views Of South Fayette
- Furniture Available
- Solar Panel Powered
- Four Floors



Nick Scalo

+1 412 721 7300 • nscaloburnsscalo.com

Joe Sheerer

+1 412 925 8356 • jsheererburnsscalo.com

Gus Scalo

+1 412 721 7713 • gscaloburnsscalo.com

NAI Burns Scalo

COMMERCIAL REAL ESTATE SERVICES, WORLDWIDE

Suite 101 Floorplan

- 3,523 SF
- Move-In Ready
- Café
- Large Conference Room
- Private Offices
- Open Offices
- IT Closet

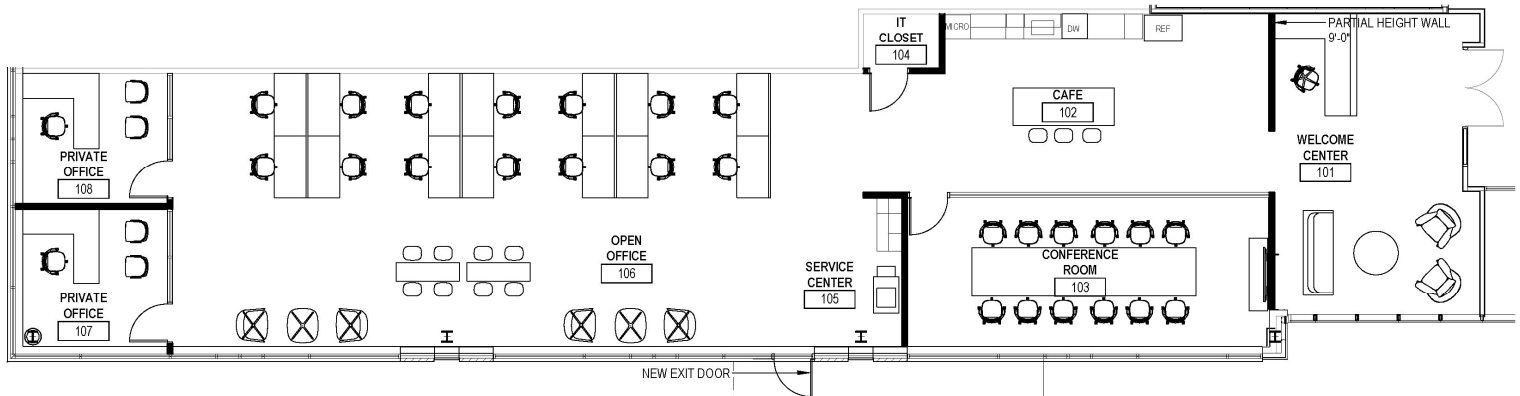

Nearby Amenities



COMMERCIAL REAL ESTATE SERVICES, WORLDWIDE

Nick Scalo

+1 412 721 7300 • nscalo@burnsscalo.com

Joe Sheerer

+1 412 925 8356 • jsheerer@burnsscalo.com

Gus Scalo

+1 412 721 7713 • gscalo@burnsscalo.com