

FOR SUBLEASE

PROFESSIONAL OFFICE SPACE

770 E. Shaw Avenue
Fresno, California

SUBLEASE DESCRIPTION

This is a great opportunity for a business who wishes a short-term lease in a ready to move-in space.

Suite 218 is available and is move-in ready. The asking rental rate is well below the market. Full Service lease terms. The Sublease runs until October 31st, 2027.

For information, please contact:

Scott Christensen

Vice President - Office Division

t 559-447-6230

schristensen@pearsonrealty.com

CA RE Lic. #00853867

NEWMARK
PEARSON COMMERCIAL

Independently Owned and Operated
Corporate License #00020875
newmarkpearson.com

FRESNO OFFICE
7480 N. Palm Ave. #101
Fresno, CA 93711
t 559-432-6200

VISALIA OFFICE
3447 S. Demaree St.
Visalia, CA 93277
t 559-732-7300

The distributor of this communication is performing acts for which a real estate license is required. The information contained herein has been obtained from sources deemed reliable but has not been verified and no guarantee, warranty or representation, either express or implied, is made with respect to such information. Terms of sale or lease and availability are subject to change or withdrawal without notice.

**AVAILABLE
FOR SUBLEASE**



Property Information

Available:	Suite 218 2,199± RSF
Sublease Rate:	\$1.35 PSF
Tenancy:	Multiple
Zoning:	CMX / O
Building Class:	C
Number of Floors:	3
Ceiling Height:	10'
Parking Ratio:	4:1000
Expiration Date:	October 31 st , 2027

PROPERTY DESCRIPTION

Professionally managed & maintained three-story office complex with quiet & peaceful open air atrium/courtyard area.

All amenities for employees to enjoy daily including shopping, restaurants, banking & daily services all within walking distance.

Easy access to Highway 41 & FAX bus service on Shaw Avenue. Abundant on-site common (*some covered*) parking. On-site security team.

770 E. SHAW AVENUE - FRESNO, CA

Floor Plan *(Not to Scale)*

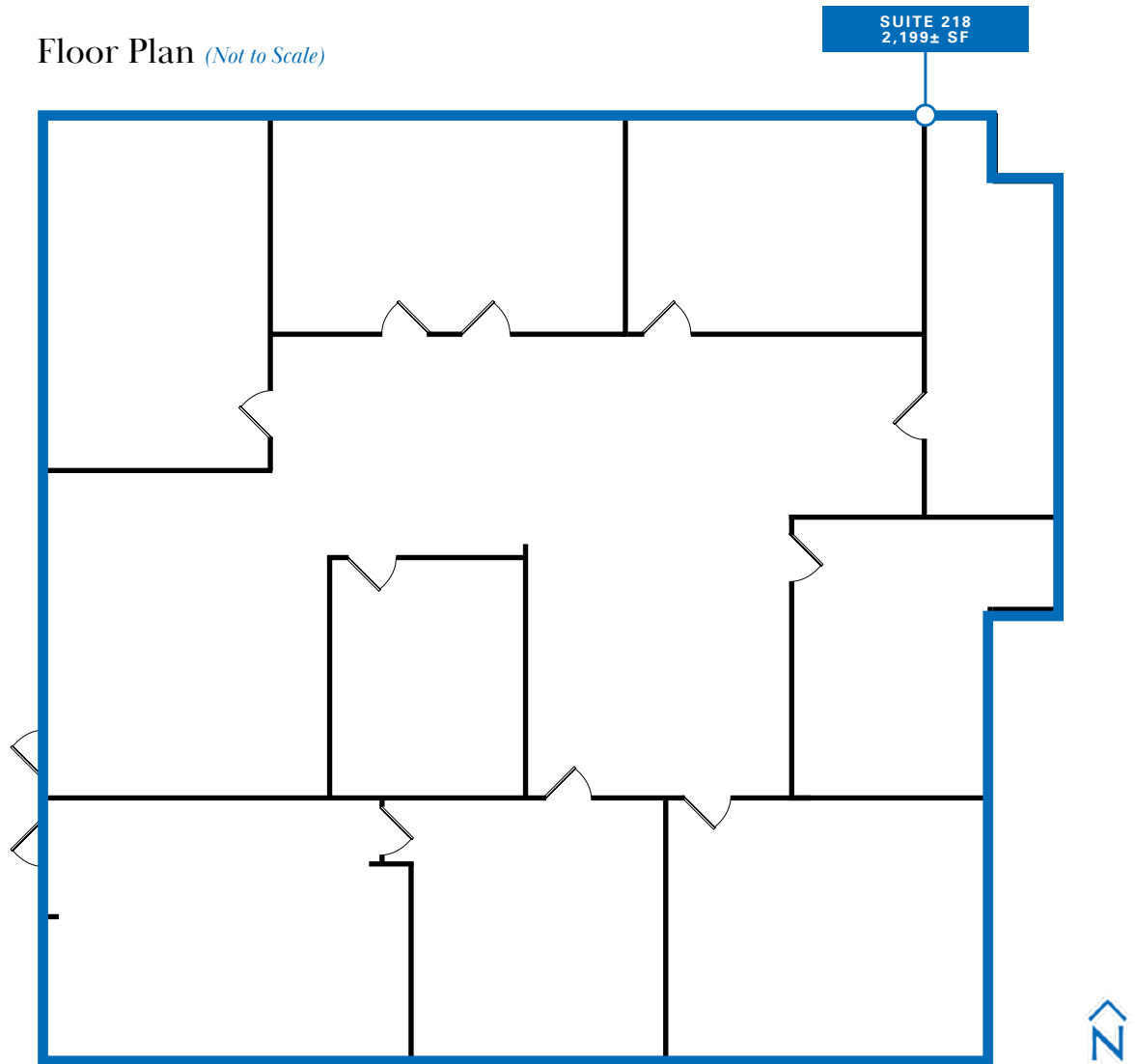

NEWMARK
PEARSON COMMERCIAL

Scott Christensen
Vice President - Office Division
t 559-447-6230
christensen@pearsonrealty.com
CA RE Lic. #00853867

Independently Owned and Operated | Corporate License #00020875 | newmarkpearson.com

FRESNO OFFICE: 7480 N. Palm Ave. #101, Fresno, CA 93711, t 559-432-6200 | **VISALIA OFFICE:** 3447 S. Demaree St., Visalia, CA 93277, t 559-732-7300

The distributor of this communication is performing acts for which a real estate license is required. The information contained herein has been obtained from sources deemed reliable but has not been verified and no guarantee, warranty or representation, either express or implied, is made with respect to such information. Terms of sale or lease and availability are subject to change or withdrawal without notice.

770 E. SHAW AVENUE - FRESNO, CA

HIGHLIGHTS

- Complete Renovation (*Millions Spent on Award Winning Improvements*)
- Finest East Shaw Property (*High Image Building*)
- Located Directly Across from High End Super Regional Center (*Fashion Fair Mall*)
- Near Freeway 41, Major Banks & Dining
- High Visibility (*64,000± Average Daily Vehicle Traffic Count, Over 23.3± Million Annually*)
- ADA Compliant



CONCIERGE SERVICES

On-site, proprietary, exclusive, highly visible, full-time, extensively trained security team available 24/7 via 1-800 number, providing for a “zero crime” model to assist tenants.

Concierge staff provide in-house construction, management, maintenance and security. All working exclusively for owner and dedicated to better serve tenants. Lounge, conference and catering facilities available.



NEWMARK
PEARSON COMMERCIAL

Scott Christensen
Vice President - Office Division
t 559-447-6230
christensen@pearsonrealty.com
CA RE Lic. #00853867

Independently Owned and Operated | Corporate License #00020875 | newmarkpearson.com

FRESNO OFFICE: 7480 N. Palm Ave. #101, Fresno, CA 93711, t 559-432-6200 | **VISALIA OFFICE:** 3447 S. Demaree St., Visalia, CA 93277, t 559-732-7300

The distributor of this communication is performing acts for which a real estate license is required. The information contained herein has been obtained from sources deemed reliable but has not been verified and no guarantee, warranty or representation, either express or implied, is made with respect to such information. Terms of sale or lease and availability are subject to change or withdrawal without notice.



For information, please contact:

Scott Christensen

Vice President - Office Division

t 559-447-6230

schristensen@pearsonrealty.com

CA RE Lic. #00853867

NEWMARK
PEARSON COMMERCIAL

Independently Owned and Operated
Corporate License #00020875
newmarkpearson.com

FRESNO OFFICE
7480 N. Palm Ave. #101
Fresno, CA 93711
t 559-432-6200

VISALIA OFFICE
3447 S. Demaree St.
Visalia, CA 93277
t 559-732-7300

The distributor of this communication is performing acts for which a real estate license is required. The information contained herein has been obtained from sources deemed reliable but has not been verified and no guarantee, warranty or representation, either express or implied, is made with respect to such information. Terms of sale or lease and availability are subject to change or withdrawal without notice.