

LAUDERDALE LAKES INDUSTRIAL PARK

2696 NW 31ST AVENUE, LAUDERDALE LAKES, FL 33311

3099 NW 28TH STREET BLDG 1



SPACE HIGHLIGHTS

- 1,400 SF
- 227 SF office
- Front & Rear 10' x 12' grade level overhead doors
- 14' clear ceiling
- LED lighting
- Hurricane Impact windows and doors
- Private restroom
- On-site Management and Leasing office



ANGIE WEAVER

Lauderdale Lakes and Lauderhill Manager
Direct: 954.485.9200 | Cell: 917.645.2339
angie@levyrai.com

HALEY PRESSER

Property Manager / Sales Associate
Direct: 954.485.9200 | Cell: 954.254.5396
Haley@levyrai.com



LAUDERDALE LAKES INDUSTRIAL PARK

2696 NW 31ST AVENUE, LAUDERDALE LAKES, FL 33311

LAUDERDALE LAKES INDUSTRIAL PARK

Building #1, 3099 NW 28th Street | Lauderdale Lakes, FL 33311

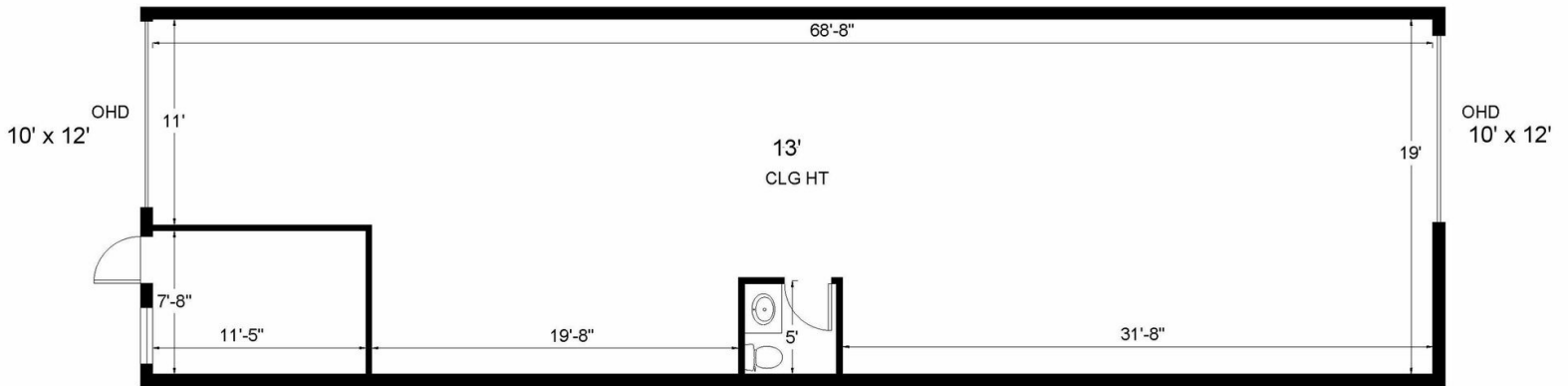

Office - 227 Sq. Ft.
Warehouse - 1,173 Sq. Ft.

1,400 Rentable Sq. Ft.
www.LevyRealtyAdvisors.com

ANGIE WEAVER

Lauderdale Lakes and Lauderhill Manager
Direct: 954.485.9200 | Cell: 917.645.2339
angie@levyrai.com

HALEY PRESSER

Property Manager / Sales Associate
Direct: 954.485.9200 | Cell: 954.254.5396
Haley@levyrai.com

