

Rancho Bernardo

11440 W. Bernardo Court, Suite 300, San Diego, CA 92127



PRIVATE OFFICES

Highly professional private offices for individuals and teams that are flexible and scaled for growth.

MEETING ROOMS

Spacious, well-appointed meeting rooms with on-site administrative support. Available for an hour, day or longer.

VIRTUAL OFFICES

Establish a business presence with mail handling, phone answering or meeting room time.

ABOUT THIS LOCATION

The Promontory Building is known for its distinct architecture and expansive views of the beautiful Rancho Bernardo Valley. Nestled into the hillside, it also features convenient onsite parking and proximity to the 15, 56, and 78 Freeways. Clients of this location also enjoy access to an onsite fitness center with a locker room and showers – at no charge.

CONTACT US

Let's touch base! Contact the on-site General Manager at 858-753-1800 or RB1manager@premierworkspaces.com to schedule a tour.



Rancho Bernardo

11440 W. Bernardo Court, Suite 300, San Diego, CA 92127



PREMIER AMENITIES

Our private suites can be easily customized to fit your desired aesthetic and brand.

- Private Offices
- Team Rooms
- High Speed Internet
- Telephone Answering
- Mail Collection
- Equipped Kitchen
- Day Offices
- Meeting Rooms
- Daily Janitorial
- Furnished or Unfurnished

PREMIER DIFFERENCE

We've been perfecting the professional workspace for over 17 years.

- Highly-Professional Atmosphere
- On-Site Manager & Support Staff
- Scalable Solutions for Individuals and Teams
- On-Site Billing
- 90+ Locations Nationwide

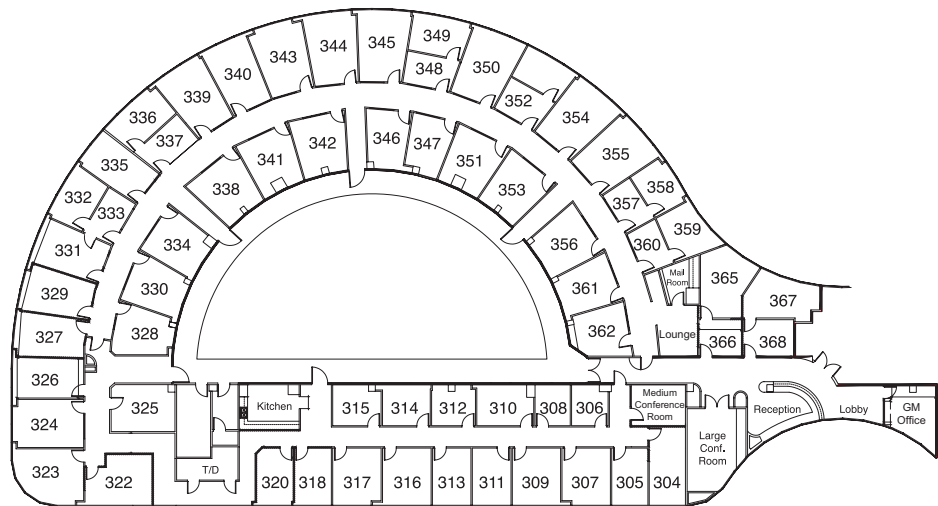

NEARBY AMENITIES

Rancho Bernardo is a master-planned community in Northern San Diego. It's home several major corporations including Sony, Broadcom, Northrop Grumman, and Amazon.

Property Amenities:

- Fitness Center
- Locker Room & Showers
- Sculpture Garden

Nearby Amenities:

- Bernardo Heights Country Club
- Cleveland Forest Administrative Office
- Community Centers (2)
- Oaks North Golf Course
- Palomar Medical Center
- Rancho Bernardo Swim/Tennis Club
- San Diego Zoo Safari Park
- Westfield North County Mall

Nearby Transit:

- Freeways – I-15
- San Diego International Airport (SAN)
- Bus – MTS

CONTACT US

Let's touch base! Contact the on-site General Manager at 858-753-1800 or RB1manager@premierworkspaces.com to schedule a tour.