

# Food Processing/Cold Storage Facility ±115,110 SF on ±9.47 Acres

1120 W. Foothill Blvd., Azusa, CA 91702

Former USDA & BRC Certified Food Processing Facility



## Contact Us

**Lynn Knox**  
Senior Vice President  
909 418 2112  
lynn.knox@cbre.com  
Lic. 01228367

**Case Dahlen**  
First Vice President  
909 418 2089  
case.dahlen@cbre.com  
Lic. 01841537

**Arthur Rasmussen, Jr.**  
Food Facilities Group  
310 550 2564  
art.rasmussen@cbre.com  
Lic. 00918691



## Property Overview

- Exceptional location in the North San Gabriel Valley of Greater LA
- Immediate access from the 210 & 605 Fwys at Irwindale Ave. Nearby 10, 60 & 57 Fwys
- ±115,110 SF Freestanding on 9.47 Acres of Land
- ±6,819 SF of Office Space
- ±20' Ceiling Clearance
- 6 Dock High Doors (4 refrigerated docks with levelers) and 3 Ground Level Doors
- Large, Secured Yard
- 4,000 Amps, 277/480 Volt, 3 Phase, 4 Wire
- Power supplied by Azusa Light and Water
- 75 Dedicated Car Parking Spaces (additional spaces available)

## Food Processing & Cold Storage Features

- Previously USDA & BRC Certified Food Processing Facility
- ±17,720 SF of Freezer (-10° to 32°)
- ±18,811 SF of Cooler (34° to 40°) - Freezer Capable
- ±39,000 SF of Processing Area (38° to 40°)
- ±16,684 of Dry Warehouse Area
- Two Spiral Blast Cells (Closed & Open Product)
- Ammonia Refrigeration System
- Separate Ready-to-Eat and Raw Production Areas
- Waster Water Treatment with 21,000 gallon storage capacity
- 14,000 gallon clarifier

+ Available Now

+ Sublease term through December 31, 2033

+ Direct Lease possible

# Site Plan

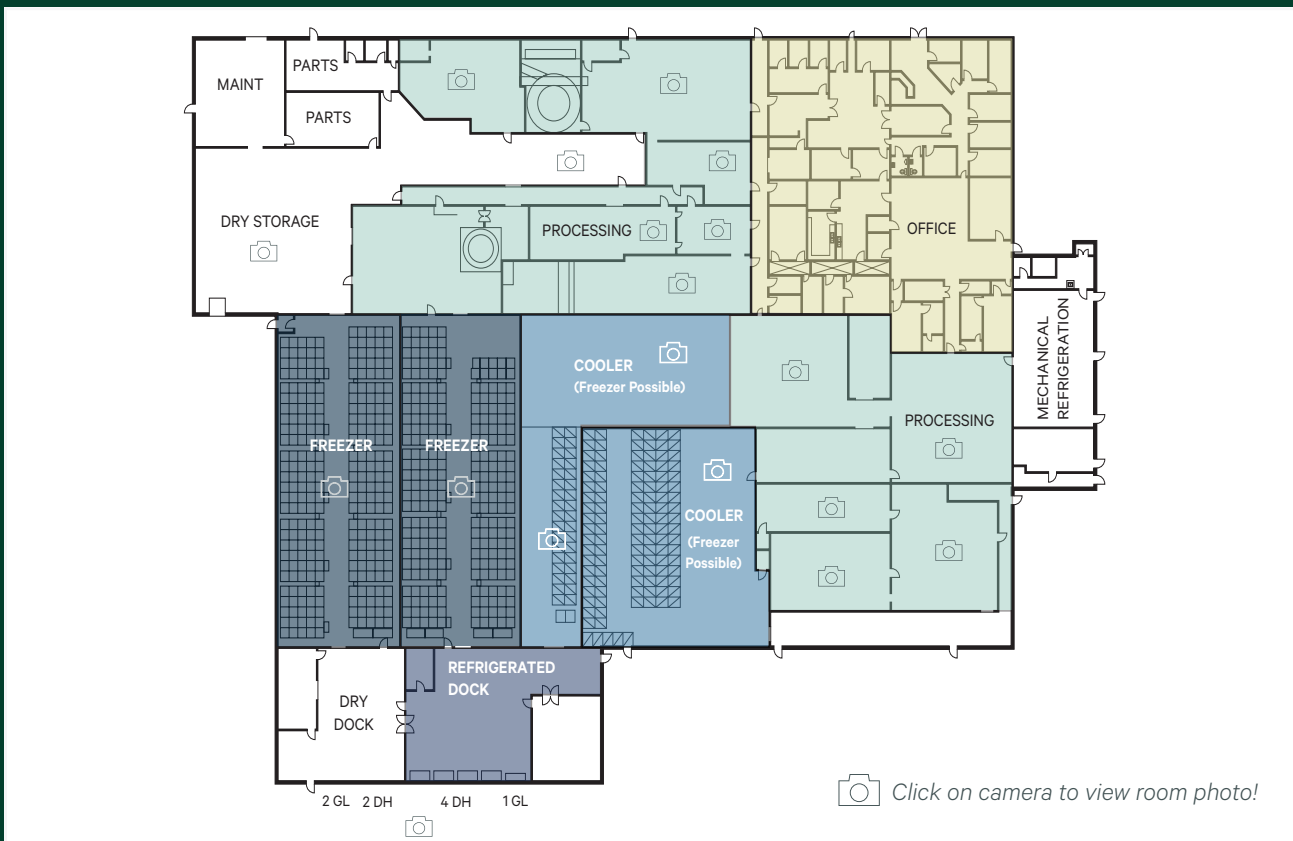
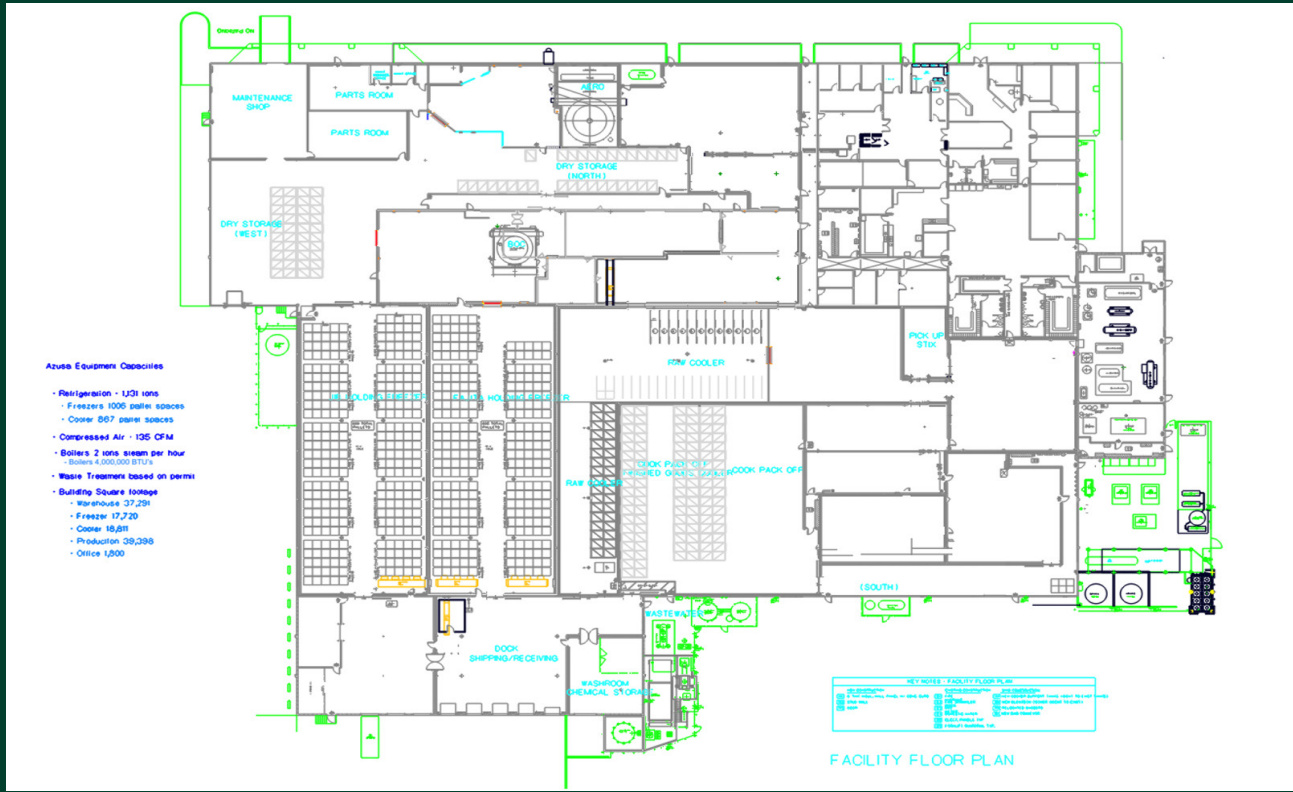

## Location

The City of Azusa ([www.ci.azusa.ca.us](http://www.ci.azusa.ca.us)) is located in the County of LA approximately 27 miles northeast of Los Angeles. It has a population of about 47,000 and includes 9 public elementary/middle schools, 2 public high schools, one private school and one private university (Azusa Pacific). It is a thriving business community in one of the most productive regions in the San Gabriel Valley. Located along the 210 Foothill Freeway, just east of the 605 San Gabriel River Freeway, Azusa offers a strategic location to access both greater Los Angeles to the west and the Inland Empire to the east. Its business make up includes high tech companies as well as industrial facilities requiring skilled labor and a community atmosphere to expand current business operations. It is currently home to over 400 businesses.

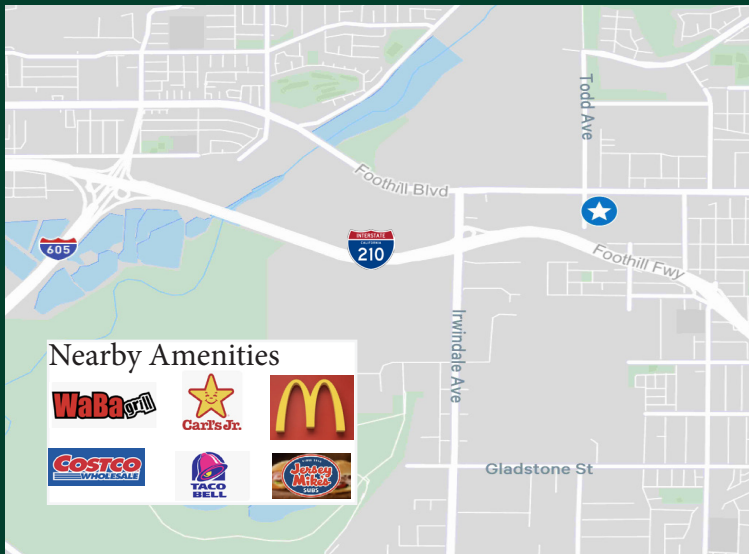

- Access to Ports of Long Beach and Los Angeles
- Abundant labor base and high-end and affordable housing
- Low cost electricity supplied by Azusa Light & Water attracting industrial & manufacturing users
- Over 7.9 million SF industrial base with low vacancy of 4.7% as of 4th Quarter 2024

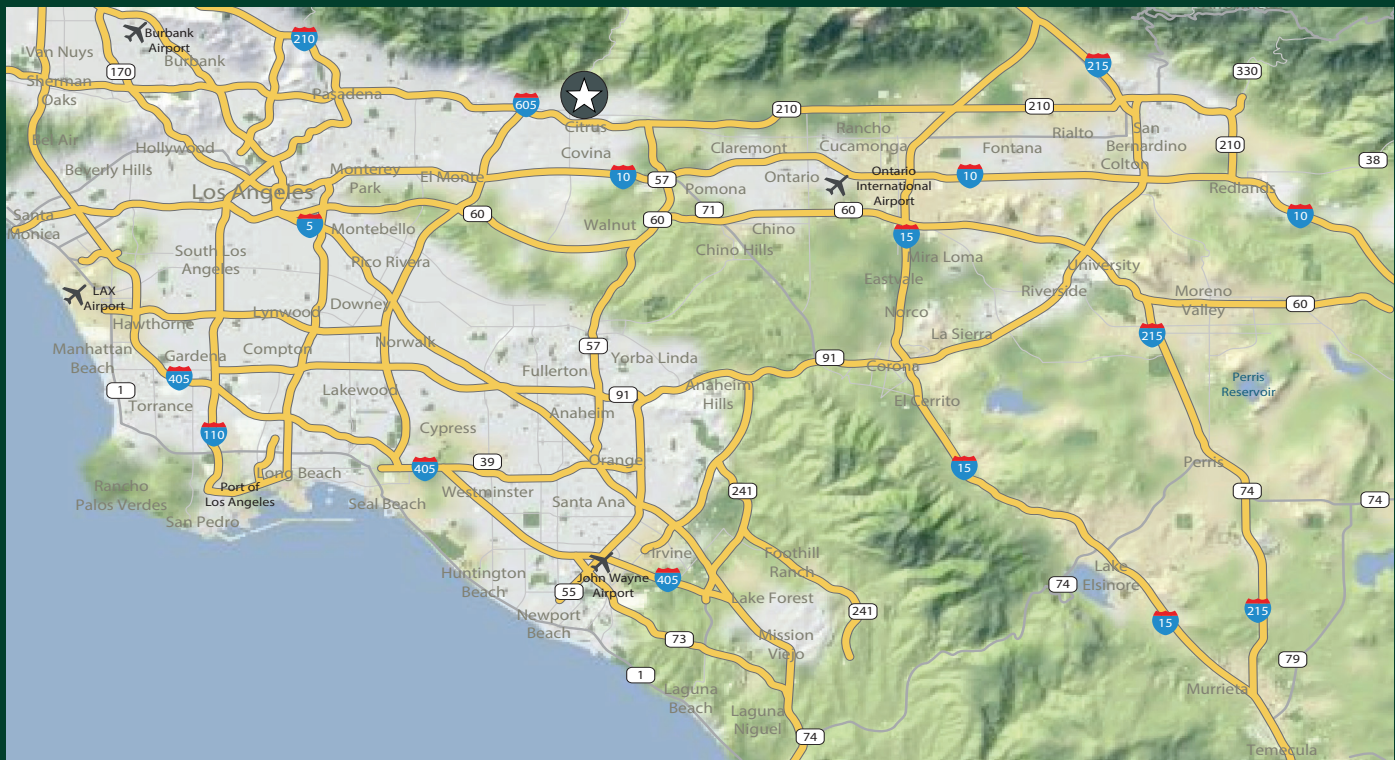

# Photos



Lobby



Lunch Room



Kitchen



Freezer With Racking



Ammonia Refrigeration System



Boiler & Process Infrastructure

## Contact Us

**Lynn Knox**  
Senior Vice President  
909 418 2112  
lynn.knox@cbre.com  
Lic. 01228367

**Case Dahlen**  
First Vice President  
909 418 2089  
case.dahlen@cbre.com  
Lic. 01841537

**Arthur Rasmussen, Jr.**  
Food Facilities Group  
310 550 2564  
art.rasmussen@cbre.com  
Lic. 00918691

© 2025 CBRE, Inc. All rights reserved. This information has been obtained from sources believed reliable, but has not been verified for accuracy or completeness. You should conduct a careful, independent investigation of the property and verify all information. Any reliance on this information is solely at your own risk. CBRE and the CBRE logo are service marks of CBRE, Inc. All other marks displayed on this document are the property of their respective owners, and the use of such logos does not imply any affiliation with or endorsement of CBRE. Photos herein are the property of their respective owners. Use of these images without the express written consent of the owner is prohibited.